

Soils Map

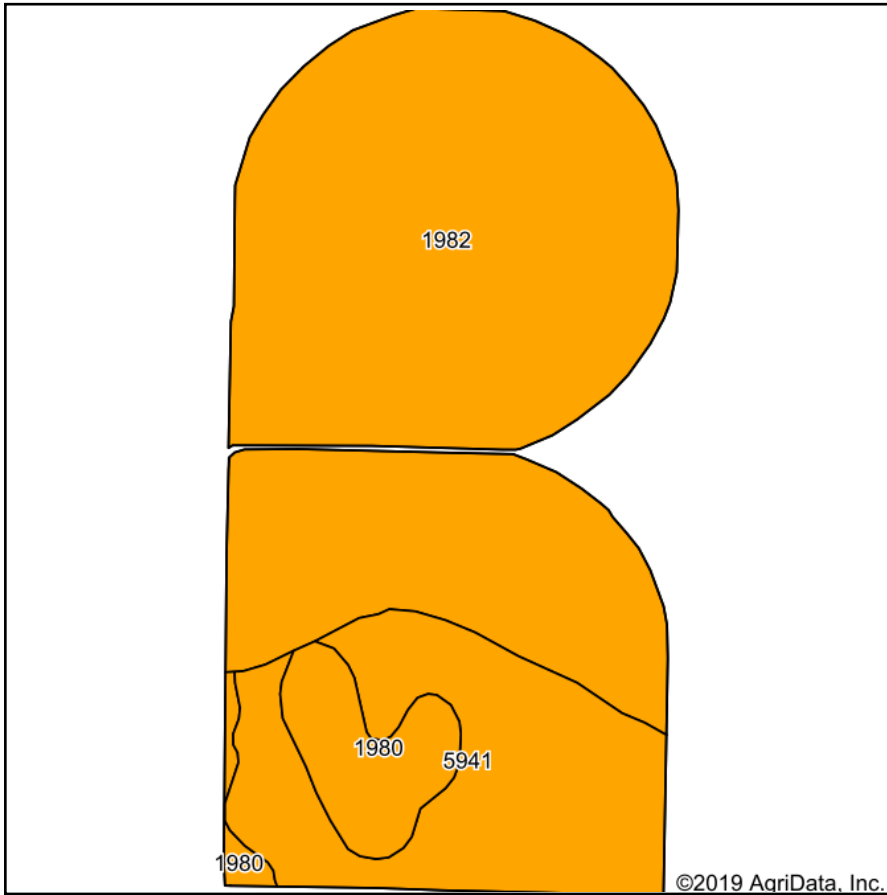

Soils data provided by USDA and NRCS.

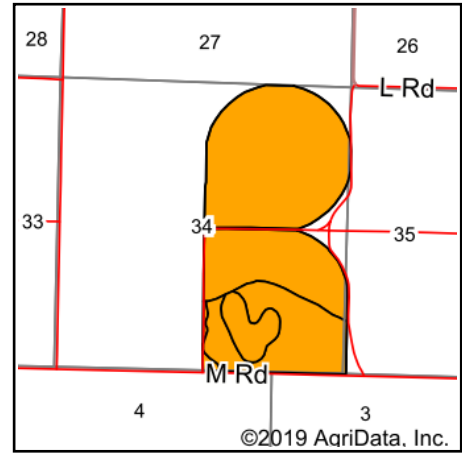

State: **Kansas**
 County: **Gray**
 Location: **34-25S-30W**
 Township: **Ingalls**
 Acres: **283.2**
 Date: **7/10/2019**



Maps Provided By:



© AgriData, Inc. 2019

www.AgriDataInc.com



Area Symbol: KS069. Soil Area Version: 15							
Code	Soil Description	Acres	Percent of field	NCCPI Overall Legend	Non-Irr Class *c	Irr Class *c	*n NCCPI Overall
1982	Valent fine sand, 5 to 20 percent slopes	199.92	70.6%		VIIe	VIe	11
5941	Pratt-Tivoli loamy fine sands, 5 to 15 percent slopes	62.86	22.2%		VIe		25
1980	Valent fine sands, 0 to 5 percent slopes	20.42	7.2%		VIe	IVe	23
Weighted Average							*n 15

*n: The aggregation method is "Weighted Average using major components"

*c: Using Capabilities Class Dominant Condition Aggregation Method

Soils data provided by USDA and NRCS.