

# Tract 2 Tillable Soils Map - Estimated

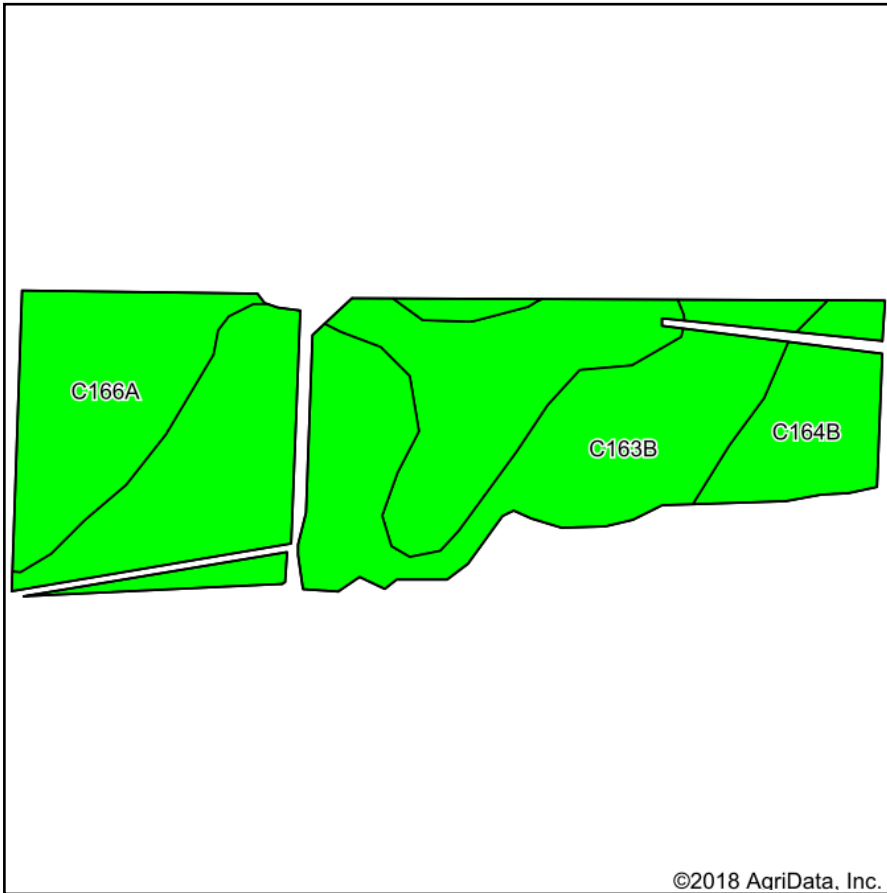

Soils data provided by USDA and NRCS.

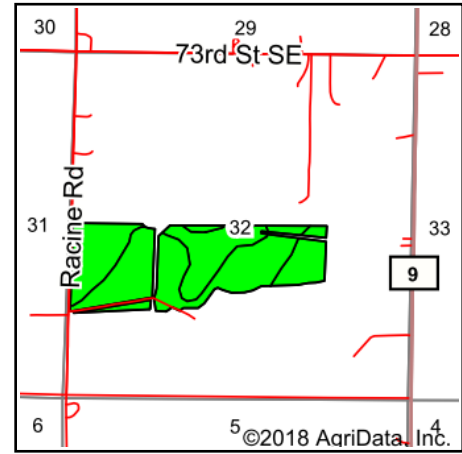

State: **Minnesota**  
 County: **Crow Wing**  
 Location: **32-44N-30W**  
 Township: **Long Lake**  
 Acres: **99**  
 Date: **9/8/2018**



Maps Provided By:



## Area Symbol: MN035, Soil Area Version: 12

Code	Soil Description	Acres	Percent of field	PI Legend	Productivity Index	NCCPI Overall	NCCPI Soybeans
C163B	Brainerd sandy loam, 1 to 4 percent slopes	51.39	51.9%		83	23	22
C166A	Nokay-Prebish complex, 0 to 2 percent slopes	36.72	37.1%		80	34	30
C164B	Brainerd-Flak complex, 4 to 8 percent slopes	10.89	11.0%		80	25	22
<b>Weighted Average</b>					<b>81.6</b>	<b>27.3</b>	<b>25</b>

Soils data provided by USDA and NRCS.