

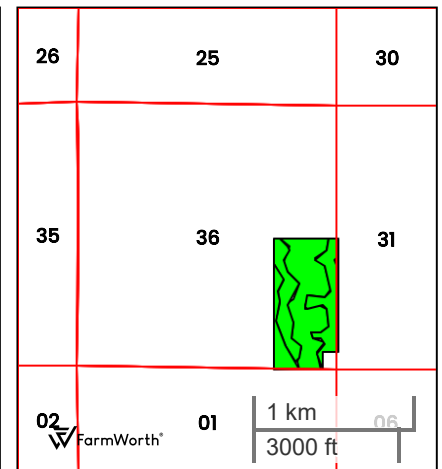

KIRKE C. QUINN ESTATE - TRACT 1 (77.35 AC TOTAL, 74.87 AC TILLABLE)

TOTAL SOILS

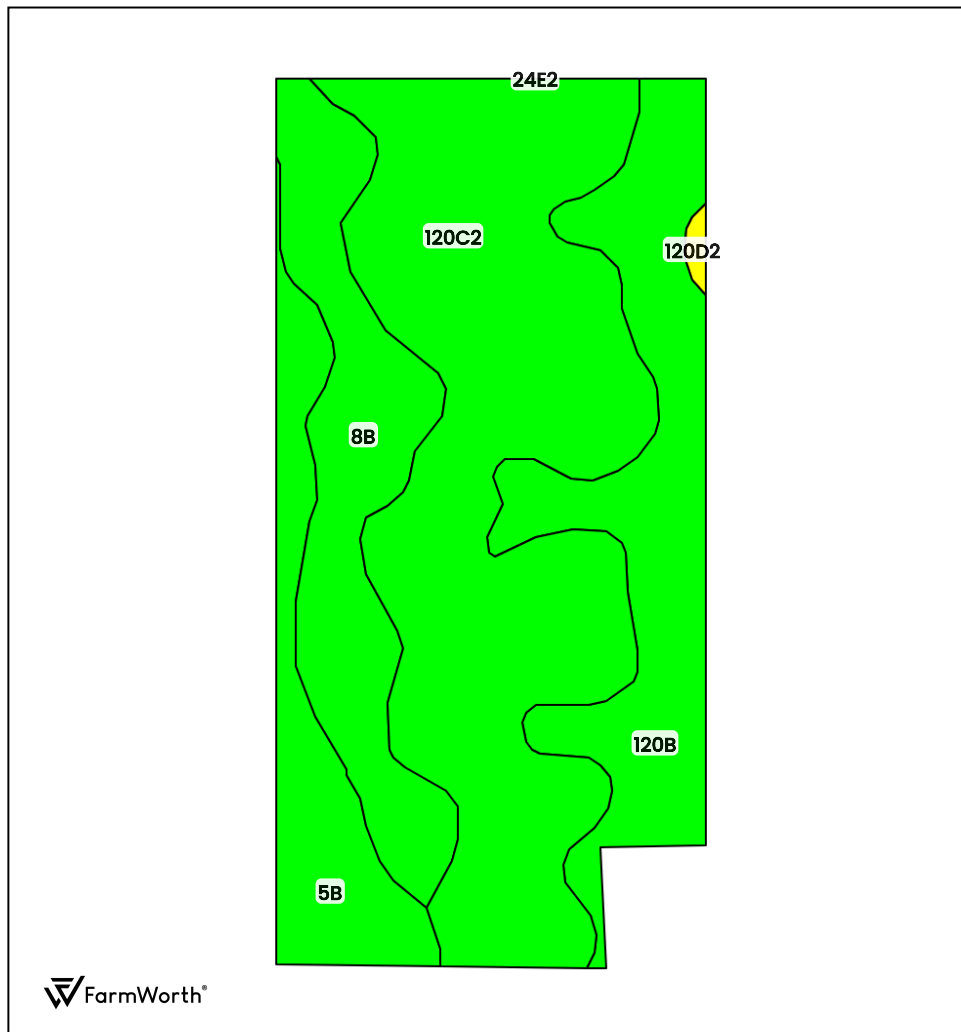

County: **Jasper County, IA**
Location: **36-81N-19W**
Township: **Malaka**
Acres: **77.35**
Date: **01/09/2026**



Field borders obtained from Farm Service Agency
as of 2008

FarmWorth, LLC makes no representations or warranties, express or implied, as to the accuracy of any information, data, numerical values, boundaries, or any other information generated through the use of FarmWorth.com. User is solely responsible for independently investigating and determining all information provided through FarmWorth.com prior to use and waives any and all claims against FarmWorth, LLC for any inaccuracies or inconsistencies in the information and/or data.

Code	Description	Acres	% of field	IA CSR2	Drainage Class
120C2	Tama silty clay loam, 5 to 9 percent slopes, eroded	38.16	49.33 %	87	Well drained
120B	Tama silty clay loam, 2 to 5 percent slopes	16.65	21.52 %	95	Well drained
8B	Judson silty clay loam, 2 to 5 percent slopes	13.79	17.83 %	84	Well drained
5B	Ackmore-Colo complex, 2 to 5 percent slopes	8.46	10.94 %	77	Somewhat poorly drained
120D2	Tama silty clay loam, 9 to 14 percent slopes, eroded	0.29	0.37 %	62	Well drained
24E2	Shelby loam, 14 to 18 percent slopes, moderately eroded	0.00	0.00 %	37	Well drained
Average:				87.0	

IA has updated the CSR values for each county to CSR2.
Soils data provided by USDA and NRCS.