

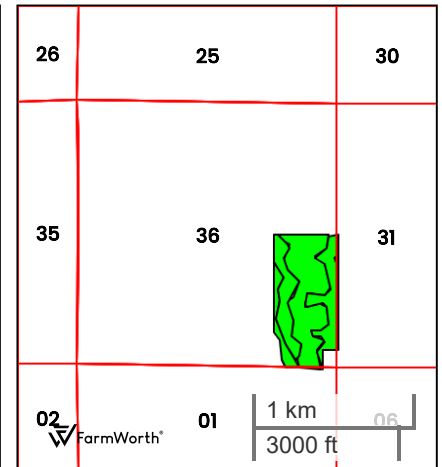

KIRKE C. QUINN ESTATE - TRACT 1 (77.35 AC TOTAL, 74.87 AC TILLABLE)

TILLABLE SOILS

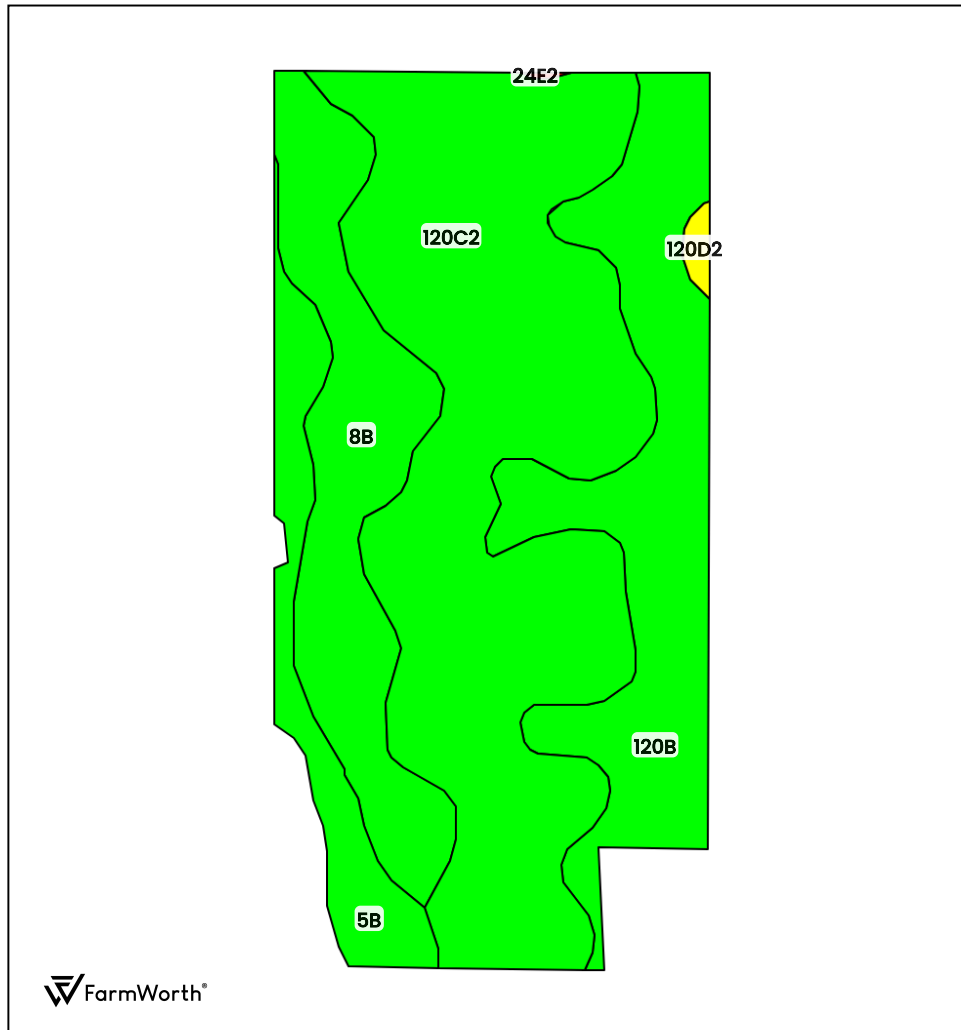

County: **Jasper County, IA**
Location: **36-81N-19W**
Township: **Malaka**
Acres: **74.87**
Date: **01/09/2026**



Field borders obtained from Farm Service Agency as of 2008

FarmWorth, LLC makes no representations or warranties, express or implied, as to the accuracy of any information, data, numerical values, boundaries, or any other information generated through the use of FarmWorth.com. User is solely responsible for independently investigating and determining all information provided through FarmWorth.com prior to use and waives any and all claims against FarmWorth, LLC for any inaccuracies or inconsistencies in the information and/or data.

| Code | Description | Acres | % of field | IA CSR2 | Drainage Class |
|----------|---|-------|------------|---------|-------------------------|
| 120C2 | Tama silty clay loam, 5 to 9 percent slopes, eroded | 37.76 | 50.43 % | 87 | Well drained |
| 120B | Tama silty clay loam, 2 to 5 percent slopes | 17.05 | 22.77 % | 95 | Well drained |
| 8B | Judson silty clay loam, 2 to 5 percent slopes | 13.55 | 18.10 % | 84 | Well drained |
| 5B | Ackmore-Colo complex, 2 to 5 percent slopes | 6.08 | 8.12 % | 77 | Somewhat poorly drained |
| 120D2 | Tama silty clay loam, 9 to 14 percent slopes, eroded | 0.38 | 0.51 % | 62 | Well drained |
| 24E2 | Shelby loam, 14 to 18 percent slopes, moderately eroded | 0.05 | 0.07 % | 37 | Well drained |
| Average: | | | | 87.3 | |

IA has updated the CSR values for each county to CSR2.
Soils data provided by USDA and NRCS.