

ACQUISITION PLAT
EXHIBIT "A" 1 OF 1

P.I. STA. = 876+42.27

14.25 AC.S - TOTAL EXCESS PARCEL 60

R = 2,100.00'

Lc = 285.94'

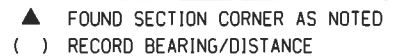

BEARING TABLE TRACT "B"		
COURSE	BEARING	DISTANCE
POINT OF COMMENCEMENT		
1-8	N89°54'45"E	548.37'
POINT OF BEGINNING		
8-9	N89°54'45"E	756.69'
9-10	S40°22'40"W	700.00'
10-11	N90°00'00"E	52.51'
11-12	S40°22'40"W	1001.35'
12-13	N07°00'19"W	67.72'
13-14	N02°53'06"E	408.09'
14-15	N08°15'46"E	131.88'
15-16	N13°36'36"E	92.42'
16-17	N16°28'26"E	92.37'
17-18	N21°39'58"E	184.41'
18-19	N23°22'26"E	184.44'
19-20	N22°09'25"E	93.38'
20-8	N23°56'47"E	91.97'

BEARING TABLE TRACT "A"		
COURSE	BEARING	DISTANCE
1-2	N89°54'45"E	202.96'
2-3	S36°30'41"W	21.86'
3-4	S31°26'30"W	92.35'
4-5	S21°18'17"W	232.21'
5-6	S10°39'38"W	108.60'
6-7	S14°14'04"W	103.01'
7-1	N01°19'26"W	519.11'

I hereby certify that this land surveying document was prepared and the related survey work was performed by me or under my direct personal supervision and that I am a duly licensed Land Surveyor under the laws of the State of Iowa.

JEFFREY R. HUTTON 4/21/14
 JEFFREY R. HUTTON LICENSE NO. 17929 DATE

My license is subject to renewal on December 31, 2015.

This certification applies only to the page upon which it appears.

**THE FEE SIMPLE TITLE GRANTED IS TO LAND DESCRIBED AS
FOLLOWS:**

Tracts of land within the Northwest Quarter of the Northwest Quarter (NW1/4 NW1/4) of Section Fifteen (15), Township Eighty-three (83) North, Range Eight (8) West of the 5th Principal Meridian, Linn County, Iowa, said parcel being shown on Acquisition Plat Exhibit "A" (Sheet 1 of 1) attached hereto and by reference made a part hereof, more particularly described as follows:

TRACT "A"

Beginning at the northwest corner of said Northwest Quarter of the Northwest Quarter (NW1/4 NW1/4); thence North 89°54'45" East along the north line of said Northwest Quarter of the Northwest Quarter (NW1/4 NW1/4) a distance of 202.96 feet; thence South 36°30'41" West, 21.86 feet; thence South 31°26'30" West, 92.35 feet; thence South 21°18'17" West, 232.21 feet; thence South 10°39'38" West, 108.60 feet; thence South 14°14'04" West, 103.01 feet to the west line of said Northwest Quarter of the Northwest Quarter (NW1/4 NW1/4); thence North 01°19'26" West along said west line 519.11 feet to the Point of Beginning, containing 0.97 acres, more or less.

TRACT "B"

Commencing at the northwest corner of said Northwest Quarter of the Northwest Quarter (NW1/4 NW1/4); thence North 89°54'45" East along the north line of said Northwest Quarter of the Northwest Quarter (NW1/4 NW1/4) a distance of 548.37 feet to the Point of Beginning; thence continuing along said north line North 89°54'45" East, 756.69 feet to the presently established northwesterly right-of-way line of the former Chicago, Milwaukee, St. Paul and Pacific Railroad; thence South 40°22'40" West along said northwesterly right-of-way line 700.00 feet; thence North 90°00'00" East along said northwesterly right-of-way 52.51 feet; thence South 40°22'40" West along said northwesterly right-of-way 1,001.35 feet; thence North 07°00'19" West, 67.72 feet; thence North 02°53'06" East, 408.09 feet; thence North 08°15'46" East, 131.88 feet; thence

Linn County, Iowa
NHSN-100-1(40)-2R-57
Parcel 060_Excess
Date: April 18, 2014

North 13°36'36" East, 92.42 feet; thence North 16°28'26" East, 92.37 feet; thence North 21°39'58" East, 184.41 feet; thence North 23°22'26" East, 184.44 feet; thence North 22°09'25" East, 93.38 feet; thence North 23°56'47" East, 91.97 feet to said north line and the Point of Beginning, containing 13.28 acres, more or less.

Containing 14.25 acres, more or less, total.

Basis of Bearing: The west line of the Northwest Quarter (NW1/4) of said Section 15 is assumed to bear North 01°19'26" West.

Linn County, Iowa
NHSN-100-1(40) -2R-57
Parcel 060_Excess
Date: April 18, 2014