

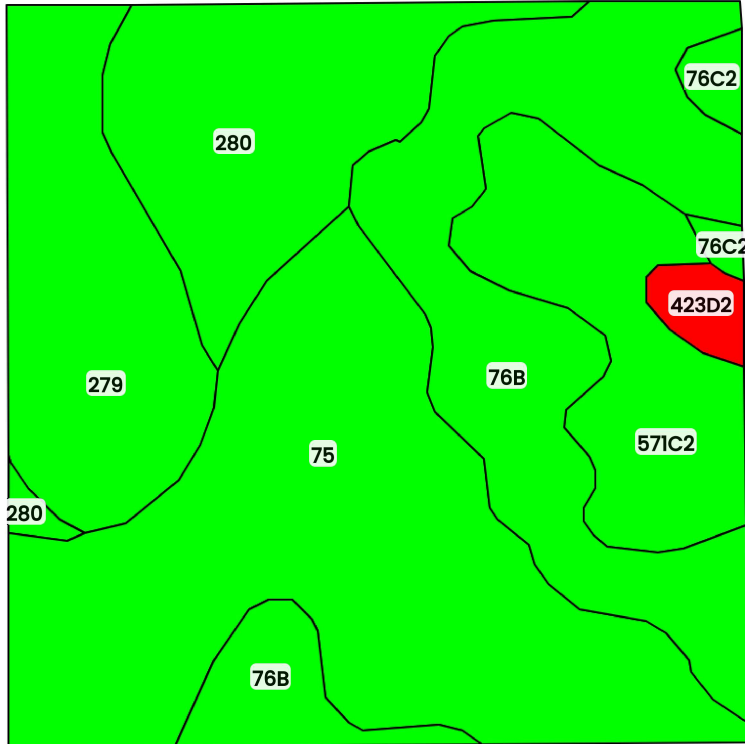

TRACT #5 (40.00 AC TOTAL, 38.92 AC TILLABLE)

## TOTAL SOILS



FarmWorth®

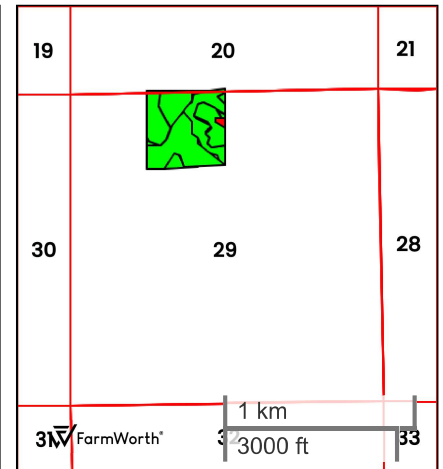

County: **Keokuk County, IA**

Location: **29-76N-12W**

Township: **Van Buren**

Acres: **40.00**

Date: **08/19/2025**



Field borders obtained from Farm Service Agency  
as of 2008

FarmWorth, LLC makes no representations or warranties, express or implied, as to the accuracy of any information, data, numerical values, boundaries, or any other information generated through the use of FarmWorth.com. User is solely responsible for independently investigating and determining all information provided through FarmWorth.com prior to use and waives any and all claims against FarmWorth, LLC for any inaccuracies or inconsistencies in the information and/or data.

Code	Description	Acres	% of field	IA CSR2
75	Givin silt loam, 0 to 2 percent slopes	13.33	33.33 %	84
76B	Ladoga silt loam, 2 to 5 percent slopes	9.49	23.73 %	86
280	Mahaska silty clay loam, 0 to 2 percent slopes	5.83	14.58 %	94
279	Taintor silty clay loam, 0 to 2 percent slopes	5.61	14.03 %	83
571C2	Hedrick silty clay loam, 5 to 9 percent slopes, moderately eroded	4.70	11.75 %	76
423D2	Bucknell silty clay loam, 9 to 14 percent slopes, moderately eroded	0.53	1.33 %	6
76C2	Ladoga silty clay loam, 5 to 9 percent slopes, eroded	0.50	1.25 %	75
Average:				83.7

IA has updated the CSR values for each county to CSR2.

Soils data provided by USDA and NRCS.