

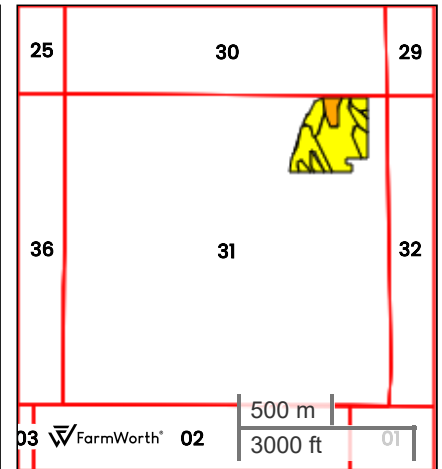

TRACT 5 TILLABLE SOILS

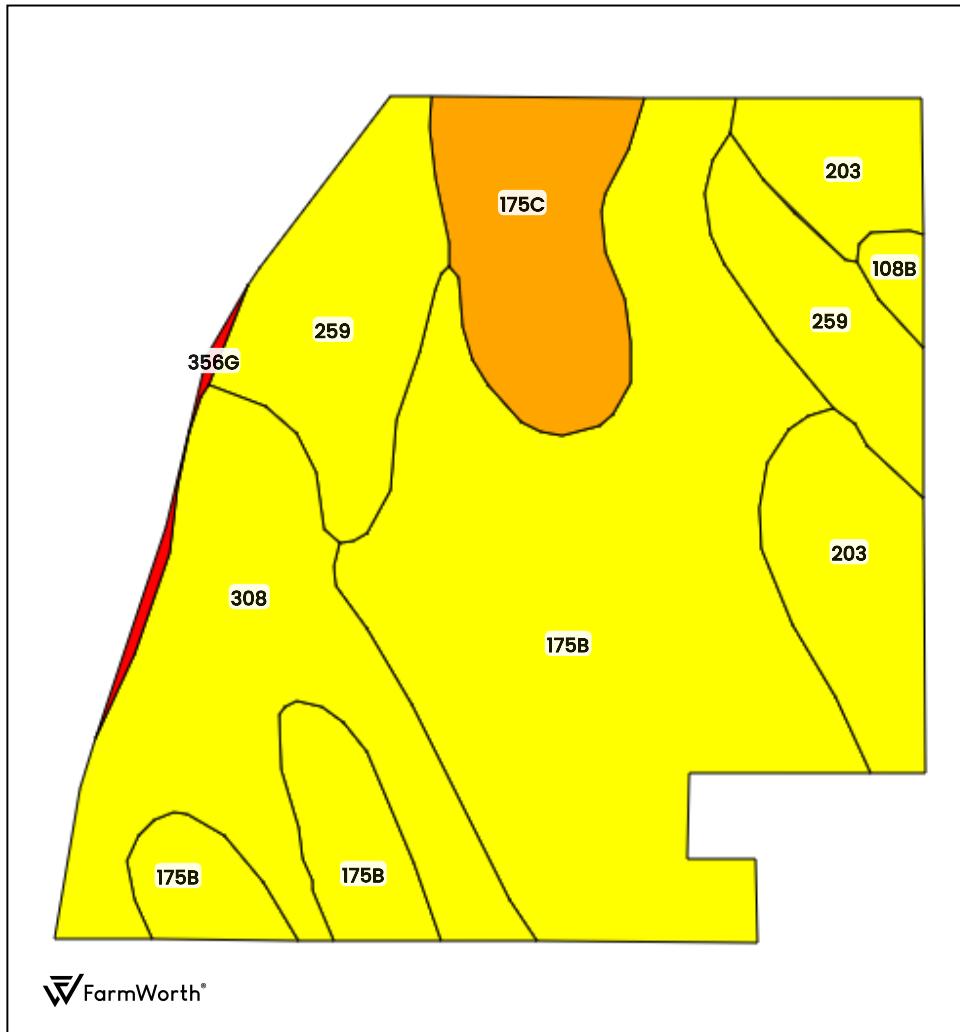

County: **Hamilton County, IA**
Location: **31-89N-25W**
Township: **Cass**
Acres: **29.94**
Date: **07/10/2025**



Field borders obtained from Farm Service Agency
as of 2008

FarmWorth, LLC makes no representations or warranties, express or implied, as to the accuracy of any information, data, numerical values, boundaries, or any other information generated through the use of FarmWorth.com. User is solely responsible for independently investigating and determining all information provided through FarmWorth.com prior to use and waives any and all claims against FarmWorth, LLC for any inaccuracies or inconsistencies in the information and/or data.

Code	Description	Acres	% of field	IA CSR2	Overall NCCPI	Soil Class (Irr)	Soil Class (Non-Irr)
175B	Dickinson sandy loam, 2 to 5 percent slopes	13.62	45.48 %	51	58	-	2
308	Wadena loam, 0 to 2 percent slopes	5.51	18.40 %	56	62	-	2
259	Biscay clay loam, 0 to 2 percent slopes	4.43	14.79 %	52	69	-	2
203	Cylinder loam, 0 to 2 percent slopes	3.25	10.85 %	58	72	-	2
175C	Dickinson sandy loam, 5 to 9 percent slopes	2.72	9.08 %	46	58	-	3
108B	Wadena loam, 2 to 6 percent slopes	0.25	0.83 %	52	61	-	2
356G	Storden-Hayden loams, 25 to 50 percent slopes	0.17	0.57 %	13	16	-	7
Average:				52.2	61.7		

IA has updated the CSR values for each county to CSR2.
Soils data provided by USDA and NRCS.