

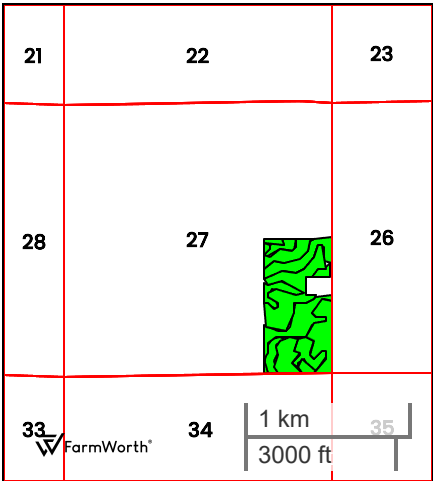

TRACT 1  
TOTAL SOILS

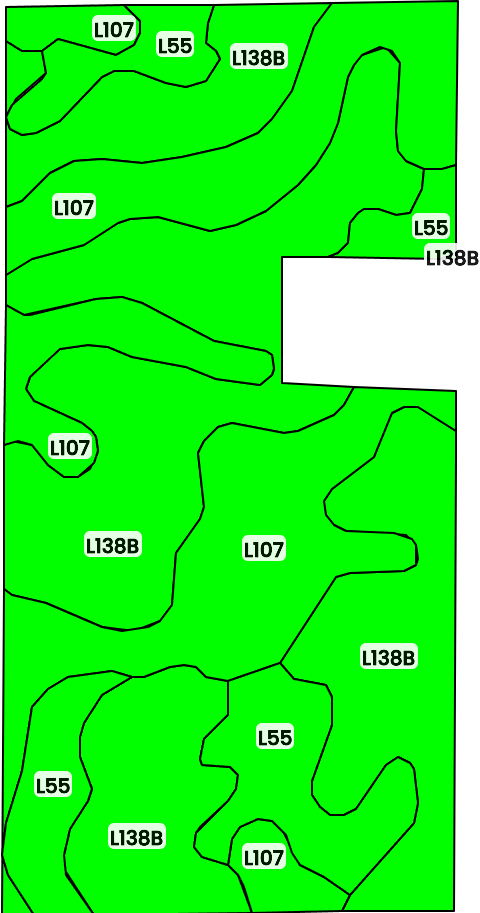

County: **Boone County, IA**  
Location: **27-82N-27W**  
Township: **Peoples**  
Acres: **75.60**  
Date: **08/28/2025**



Field borders obtained from Farm Service Agency  
as of 2008

FarmWorth, LLC makes no representations or warranties, express or implied, as to the accuracy of any information, data, numerical values, boundaries, or any other information generated through the use of FarmWorth.com. User is solely responsible for independently investigating and determining all information provided through FarmWorth.com prior to use and waives any and all claims against FarmWorth, LLC for any inaccuracies or inconsistencies in the information and/or data.

Code		Description	Acres	% of field	IA CSR2	Drainage Class
L138B		Clarion loam, Bemis moraine, 2 to 6 percent slopes	39.52	52.28 %	88	Well drained
L107		Webster clay loam, Bemis moraine, 0 to 2 percent slopes	24.72	32.70 %	88	Poorly drained
L55		Nicollet loam, 1 to 3 percent slopes	11.36	15.03 %	91	Somewhat poorly drained
Average:					88.5	

IA has updated the CSR values for each county to CSR2.  
Soils data provided by USDA and NRCS.