

# Tillable Soils Map

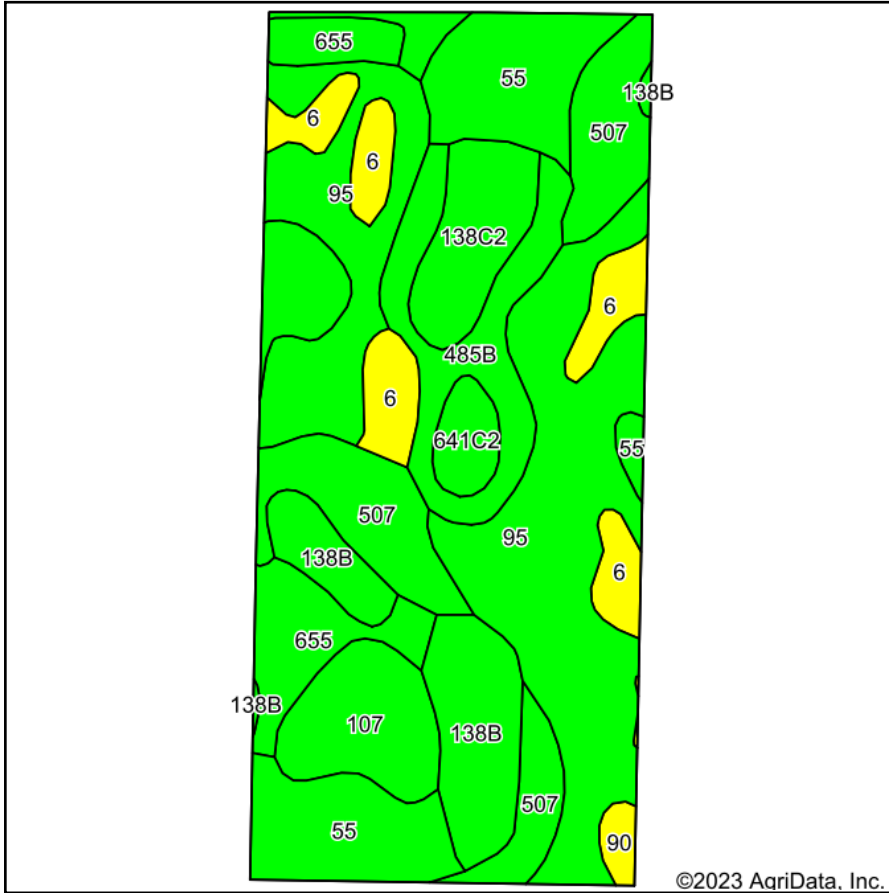

Soils data provided by USDA and NRCS.

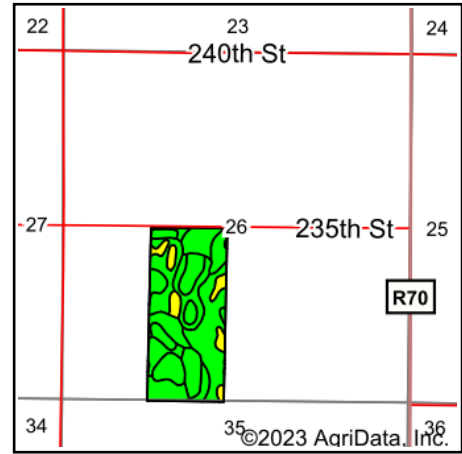

State: **Iowa**  
 County: **Hancock**  
 Location: **26-96N-23W**  
 Township: **Concord**  
 Acres: **69.28**  
 Date: **5/11/2023**



Maps Provided By:



© AgriData, Inc. 2023

www.AgriDataInc.com



Area Symbol: IA081, Soil Area Version: 33

Code	Soil Description	Acres	Percent of field	CSR2 Legend	Non-Irr Class *c	CSR2**	CSR	*n NCCPI Overall	*n NCCPI Corn	*n NCCPI Soybeans	
95	Harps clay loam, 0 to 2 percent slopes	20.21	29.2%		IIw	72	62	82	70	82	
507	Canisteo clay loam, 0 to 2 percent slopes	10.85	15.7%		IIw	84	78	81	71	81	
55	Nicollet clay loam, 1 to 3 percent slopes	8.72	12.6%		Iw	89	88	81	81	81	
138B	Clarion loam, 2 to 6 percent slopes	5.79	8.4%		Ile	89	80	83	78	83	
6	Okoboji silty clay loam, 0 to 1 percent slopes	5.17	7.5%		IIIw	59	57	76	74	74	
485B	Spillville loam, 2 to 5 percent slopes	5.13	7.4%		Ile	88	85	89	87	87	
655	Crippin loam, 1 to 3 percent slopes	4.22	6.1%		Ie	91	83	86	71	86	
107	Webster clay loam, 0 to 2 percent slopes	3.90	5.6%		IIw	86	83	82	78	82	
138C2	Clarion loam, 6 to 10 percent slopes, moderately eroded	3.47	5.0%		IIIe	83	64	70	68	70	
641C2	Clarion-Sunburg complex, 5 to 9 percent slopes, moderately eroded	1.29	1.9%		IIIe	71	54	66	66	59	
90	Okoboji mucky silt loam, 0 to 1 percent slopes	0.53	0.8%		IIIw	53	59	62	61	61	
<b>Weighted Average</b>						<b>1.96</b>	<b>80</b>	<b>73</b>	<b>*n 81.1</b>	<b>*n 74</b>	<b>*n 80.6</b>

\*\*IA has updated the CSR values for each county to CSR2.

\*n: The aggregation method is "Weighted Average using all components"

\*c: Using Capabilities Class Dominant Condition Aggregation Method

Soils data provided by USDA and NRCS.