

Tillable Soils Map

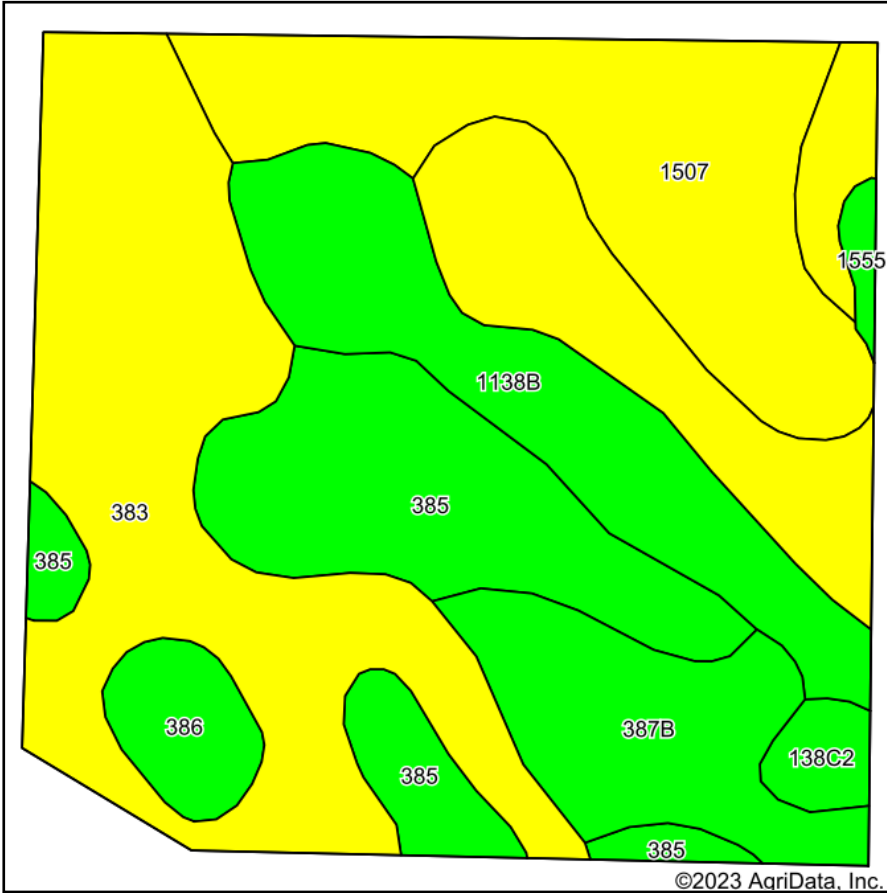

Soils data provided by USDA and NRCS.

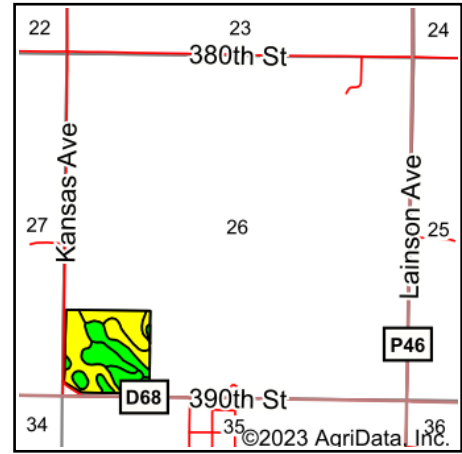

State: **Iowa**
 County: **Webster**
 Location: **26-86N-29W**
 Township: **Lost Grove**
 Acres: **37.46**
 Date: **4/3/2023**



Maps Provided By:



© AgriData, Inc. 2023

www.AgriDataInc.com



Area Symbol: IA187, Soil Area Version: 39

Code	Soil Description	Acres	Percent of field	CSR2 Legend	Non-Irr Class *c	*i Corn Bu	*i Soybeans Bu	CSR2**	CSR	*n NCCPI Overall	
383	Marna silty clay loam, 0 to 2 percent slopes	14.52	38.8%		IIw	193.6	56.1	69	73	77	
1507	Brownton silty clay loam, 0 to 2 percent slopes	6.61	17.6%		IIw	177.6	51.5	62	68	65	
385	Guckeen clay loam, 1 to 3 percent slopes	6.14	16.4%		IIw	220.8	64.0	76	87	73	
1138B	Clarion clay loam, 2 to 5 percent slopes	4.81	12.8%		Ile	225.6	65.4	90	80	79	
387B	Kamrar clay loam, 2 to 6 percent slopes	3.45	9.2%		Ile	225.6	65.4	90	82	79	
386	Cordova clay loam, 0 to 2 percent slopes	1.13	3.0%		IIw	204.8	59.4	77	72	85	
138C2	Clarion loam, 6 to 10 percent slopes, moderately eroded	0.56	1.5%		IIIe	204.8	59.4	83	65	70	
1555	Nicollet-Guckeen complex, 1 to 3 percent slopes	0.24	0.6%		Ie	222.4	64.5	86	86	79	
Weighted Average						2.01	203	58.8	74.1	76.1	*n 74.8

**IA has updated the CSR values for each county to CSR2.

*i Yield data provided by the ISPAID Database version 8.1.1 developed by IA State University.

*n: The aggregation method is "Weighted Average using all components"

*c: Using Capabilities Class Dominant Condition Aggregation Method

Soils data provided by USDA and NRCS.