

CRP Soils Map

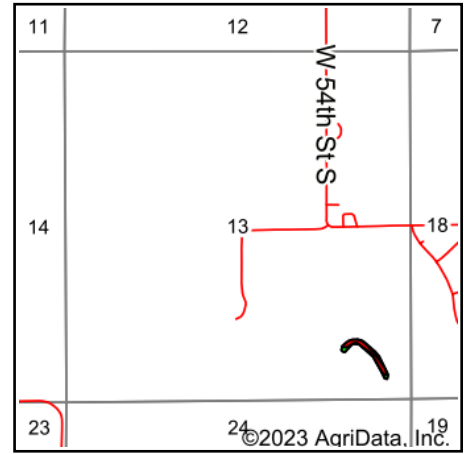

Soils data provided by USDA and NRCS.



State: **Iowa**
 County: **Jasper**
 Location: **13-79N-20W**
 Township: **Mound Prairie**
 Acres: **1.81**
 Date: **2/28/2023**



Maps Provided By:



Area Symbol: IA099, Soil Area Version: 28

Code	Soil Description	Acres	Percent of field	CSR2 Legend	Non-Irr Class *c	*i Corn Bu	*i Soybeans Bu	CSR2**	CSR	*n NCCPI Overall
2133	Colo silty clay loam, 0 to 2 percent slopes, ponded, occasionally flooded	1.07	59.1%		Vw			35		11
88	Nevin silty clay loam, 0 to 2 percent slopes	0.74	40.9%		Is	227.2	65.9	92	90	96
Weighted Average					3.36	92.9	26.9	58.3	*-	*n 45.8

**IA has updated the CSR values for each county to CSR2.

*- CSR weighted average cannot be calculated on the current soils data, use prior data version for csr values.

*i Yield data provided by the ISPAID Database version 8.1.1 developed by IA State University.

*n: The aggregation method is "Weighted Average using all components"

*c: Using Capabilities Class Dominant Condition Aggregation Method

Soils data provided by USDA and NRCS.