

Tillable Soils Map

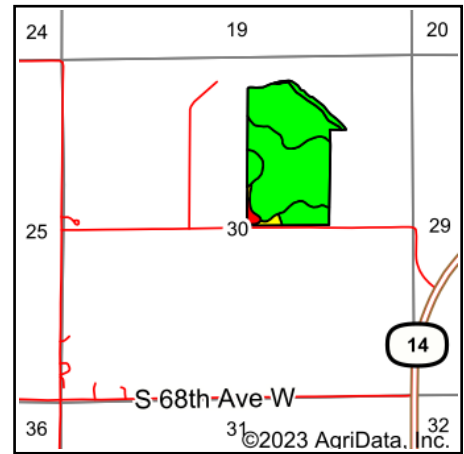

State: **Iowa**
 County: **Jasper**
 Location: **30-79N-19W**
 Township: **Fairview**
 Acres: **63.43**
 Date: **2/27/2023**

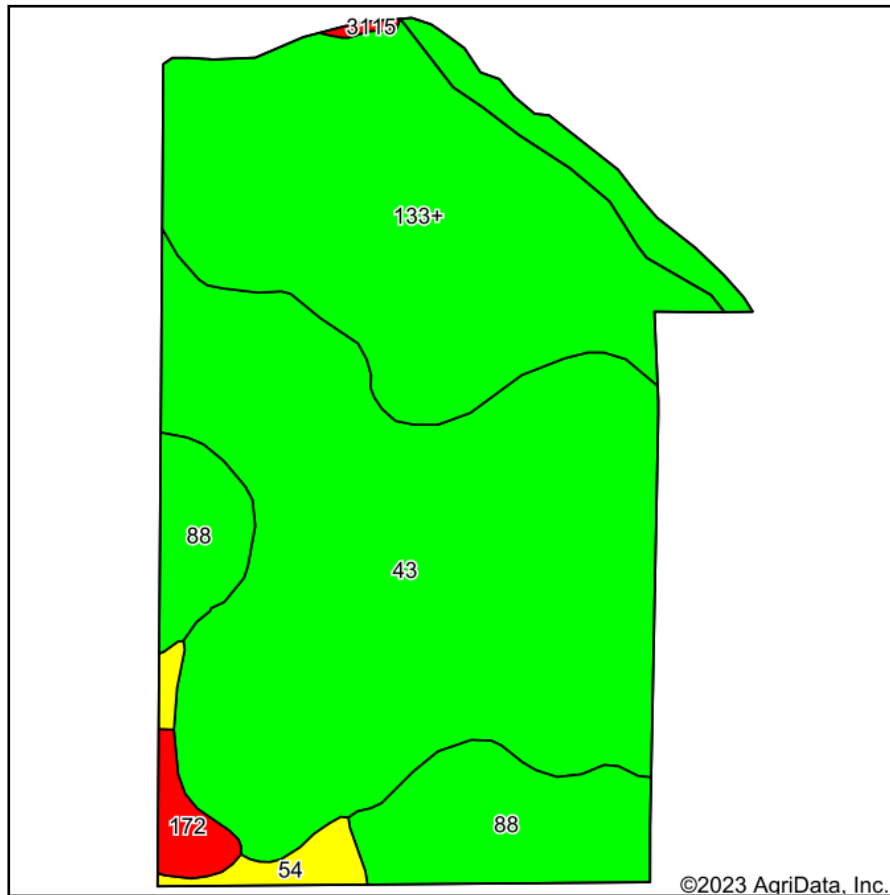

Maps Provided By:



© AgriData, Inc. 2021

www.AgriDataInc.com



Area Symbol: IA099, Soil Area Version: 28

Code	Soil Description	Acres	Percent of field	CSR2 Legend	Non-Irr Class *c	*i Corn Bu	*i Soybeans Bu	CSR2**	CSR	*n NCCPI Overall
43	Bremer silty clay loam, 0 to 2 percent slopes, occasionally flooded	31.57	49.8%		IIw	198.4	57.5	74	82	77
133+	Colo silt loam, 0 to 2 percent slopes, occasionally flooded, overwash	21.93	34.6%		IIw	204.8	59.4	78	85	82
88	Nevin silty clay loam, 0 to 2 percent slopes	7.61	12.0%		Is	227.2	65.9	92	90	96
54	Zook silty clay loam, 0 to 2 percent slopes, occasionally flooded	1.20	1.9%		IIw	177.6	51.5	60	70	61
172	Wabash silty clay, 0 to 2 percent slopes	1.01	1.6%		IIIw	177.6	51.5	38	45	49
3115	Colo, overwash-Lawson complex, channeled, 0 to 2 percent slopes, frequently flooded	0.11	0.2%		Vw	80.0	23.2	5	5	11
Weighted Average					1.90	203.1	58.9	76.6	83	*n 80.1

**IA has updated the CSR values for each county to CSR2.

*i Yield data provided by the ISPAID Database version 8.1.1 developed by IA State University.

*n: The aggregation method is "Weighted Average using all components"

*c: Using Capabilities Class Dominant Condition Aggregation Method

Soils data provided by USDA and NRCS.