

Total Soils Map

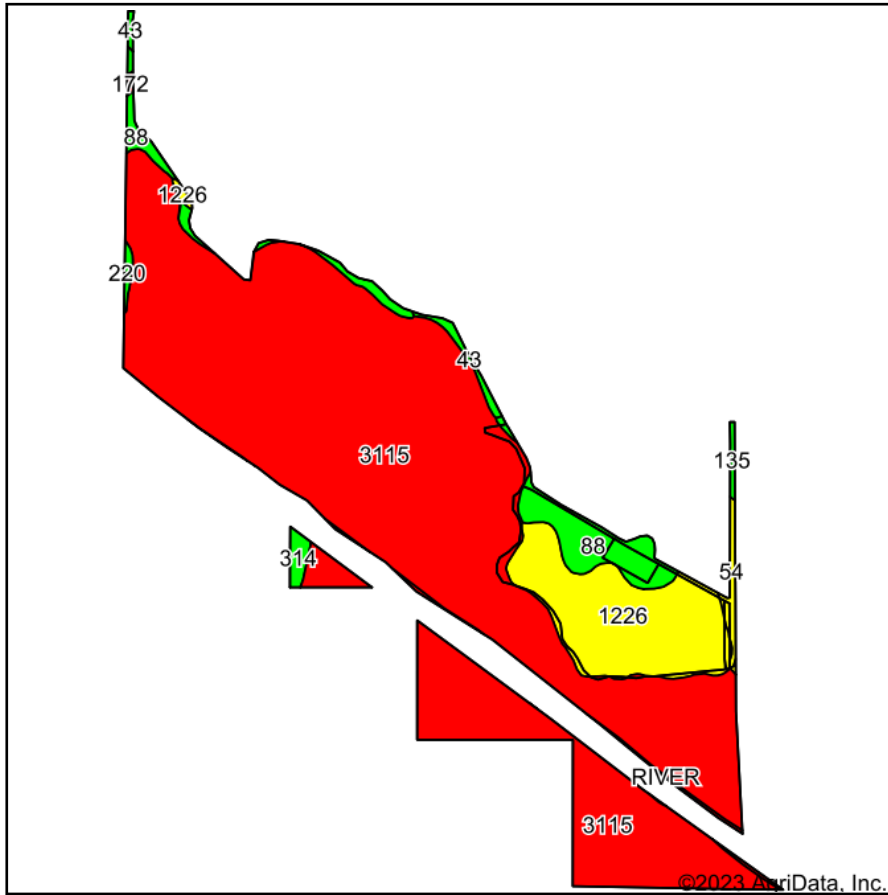

Soils data provided by USDA and NRCS.

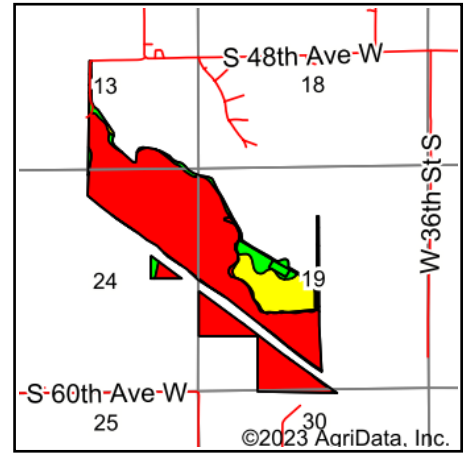

State: **Iowa**
 County: **Jasper**
 Location: **19-79N-19W**
 Township: **Palo Alto**
 Acres: **316.07**
 Date: **2/28/2023**

PC PEOPLES
 COMPANY
 INNOVATIVE. REAL ESTATE. SOLUTIONS.

Maps Provided By:

surety
 CUSTOMIZED ONLINE MAPPING
 © AgriData, Inc. 2021 www.AgriDataInc.com



Area Symbol: IA099, Soil Area Version: 28

Code	Soil Description	Acres	Percent of field	CSR2 Legend	Non-Irr Class *c	*i Corn Bu	*i Soybeans Bu	CSR2**	CSR	*n NCCPI Overall
3115	Colo, overwash-Lawson complex, channeled, 0 to 2 percent slopes, frequently flooded	254.81	80.6%		Vw	80.0	23.2	5	5	11
1226	Lawler loam, 0 to 2 percent slopes, rarely flooded	36.38	11.5%		IIls	80.0	23.2	59	78	83
88	Nevin silty clay loam, 0 to 2 percent slopes	16.11	5.1%		Is	227.2	65.9	92	90	96
54	Zook silty clay loam, 0 to 2 percent slopes, occasionally flooded	2.14	0.7%		IIlw	177.6	51.5	60	70	61
43	Bremer silty clay loam, 0 to 2 percent slopes, occasionally flooded	1.82	0.6%		IIlw	198.4	57.5	74	82	77
314	Lawson-Nodaway-Colo Complex, 0 to 2 percent slopes, occasionally flooded	1.65	0.5%		IIlw	80.0	23.2	77	75	89
RIVER	Water, rivers and streams	1.58	0.5%					0		
220	Nodaway silt loam, shallow loess, 0 to 2 percent slopes, occasionally flooded	0.69	0.2%		IIlw	211.2	61.2	77	85	88
135	Coland clay loam, 0 to 2 percent slopes, occasionally flooded	0.66	0.2%		IIlw	198.4	57.5	76	80	83
172	Wabash silty clay, 0 to 2 percent slopes	0.23	0.1%		IIIw	177.6	51.5	38	45	49
Weighted Average					*-	89.1	25.8	17.1	*-	*n 25

**IA has updated the CSR values for each county to CSR2.

*- CSR weighted average cannot be calculated on the current soils data, use prior data version for csr values.

*i Yield data provided by the ISPAID Database version 8.1.1 developed by IA State University.

*n: The aggregation method is "Weighted Average using all components"

*c: Using Capabilities Class Dominant Condition Aggregation Method

*- Non Irr Class weighted average cannot be calculated on the current soils data due to missing data.

Soils data provided by USDA and NRCS.