

Soils Map

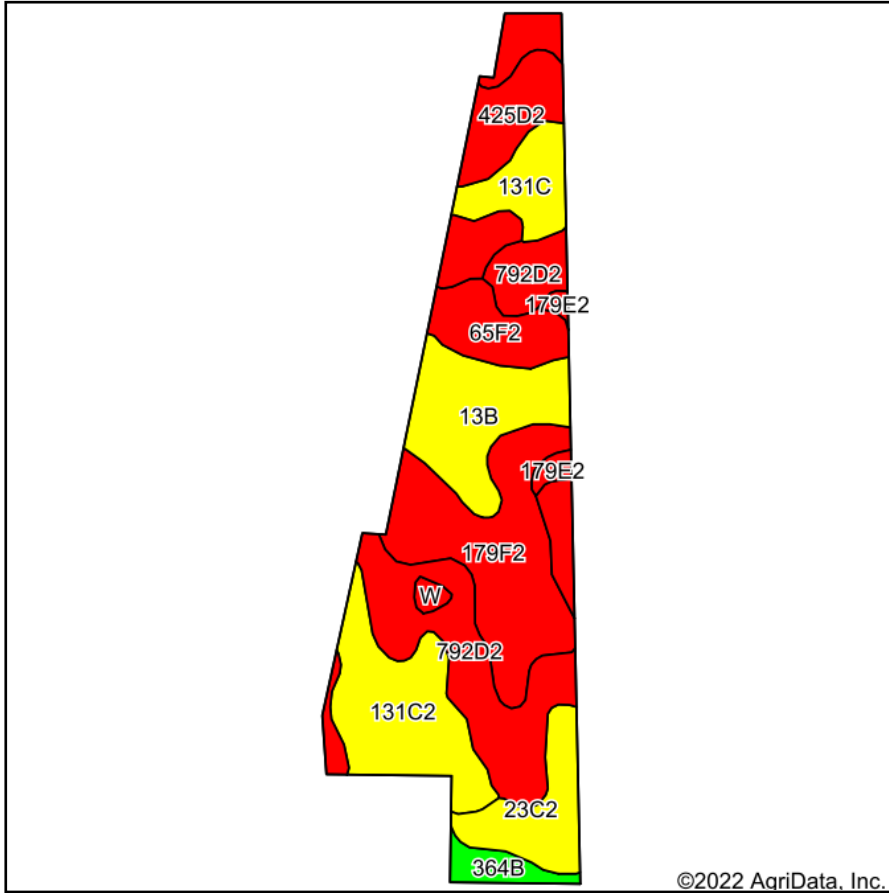

©2022 AgriData, Inc.

Soils data provided by USDA and NRCS.

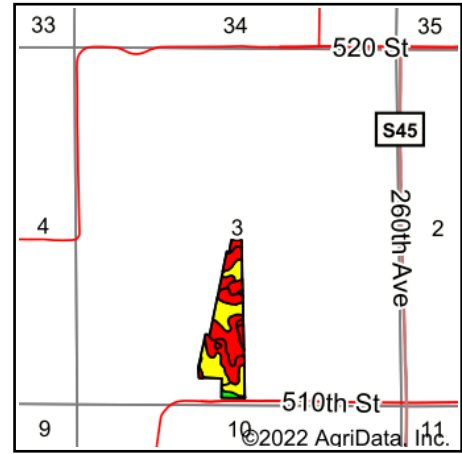

State: **Iowa**
 County: **Lucas**
 Location: **3-72N-21W**
 Township: **Lincoln**
 Acres: **27.5**
 Date: **10/17/2022**



Maps Provided By:



© AgriData, Inc. 2021

www.AgriDataInc.com



Area Symbol: IA117, Soil Area Version: 30

Code	Soil Description	Acres	Percent of field	CSR2 Legend	Non-Irr Class *c	CSR2**	CSR	*n NCCPI Overall	*n NCCPI Corn	*n NCCPI Small Grains	*n NCCPI Soybeans	
792D2	Armstrong clay loam, 9 to 14 percent slopes, moderately eroded	6.05	22.0%		IVe	5	13	58	58	54	40	
179F2	Gara clay loam, 18 to 25 percent slopes, moderately eroded	5.09	18.5%		IVe	11	13	54	54	34	35	
131C2	Pershing silty clay loam, 5 to 9 percent slopes, moderately eroded	3.82	13.9%		IIle	62	45	69	69	66	57	
13B	Zook-Olmitz-Vesser complex, 0 to 5 percent slopes	3.23	11.7%		IIw	68	53	77	70	43	74	
425D2	Keswick clay loam, 9 to 14 percent slopes, moderately eroded	2.37	8.6%		IVe	8	12	54	54	53	39	
65F2	Lindley loam, 18 to 25 percent slopes, moderately eroded	2.27	8.3%		Vlle	10	8	53	53	36	39	
23C2	Arispe silty clay loam, 5 to 9 percent slopes, moderately eroded	1.94	7.1%		IIle	62	50	74	74	67	69	
131C	Pershing silt loam, 5 to 9 percent slopes	1.55	5.6%		IIle	65	49	74	74	70	59	
364B	Grundy silty clay loam, 2 to 5 percent slopes	0.67	2.4%		IIe	72	75	80	80	68	69	
179E2	Gara clay loam, 14 to 18 percent slopes, moderately eroded	0.32	1.2%		VIe	23	33	64	64	49	43	
W	Water	0.19	0.7%			0	0					
Weighted Average						*-	31.3	27.9	*n 62.5	*n 61.7	*n 50.8	*n 48.8

**IA has updated the CSR values for each county to CSR2.

*n: The aggregation method is "Weighted Average using all components"

*c: Using Capabilities Class Dominant Condition Aggregation Method

*- Non Irr Class weighted average cannot be calculated on the current soils data due to missing data.

Soils data provided by USDA and NRCS.