

CRESO TWP.

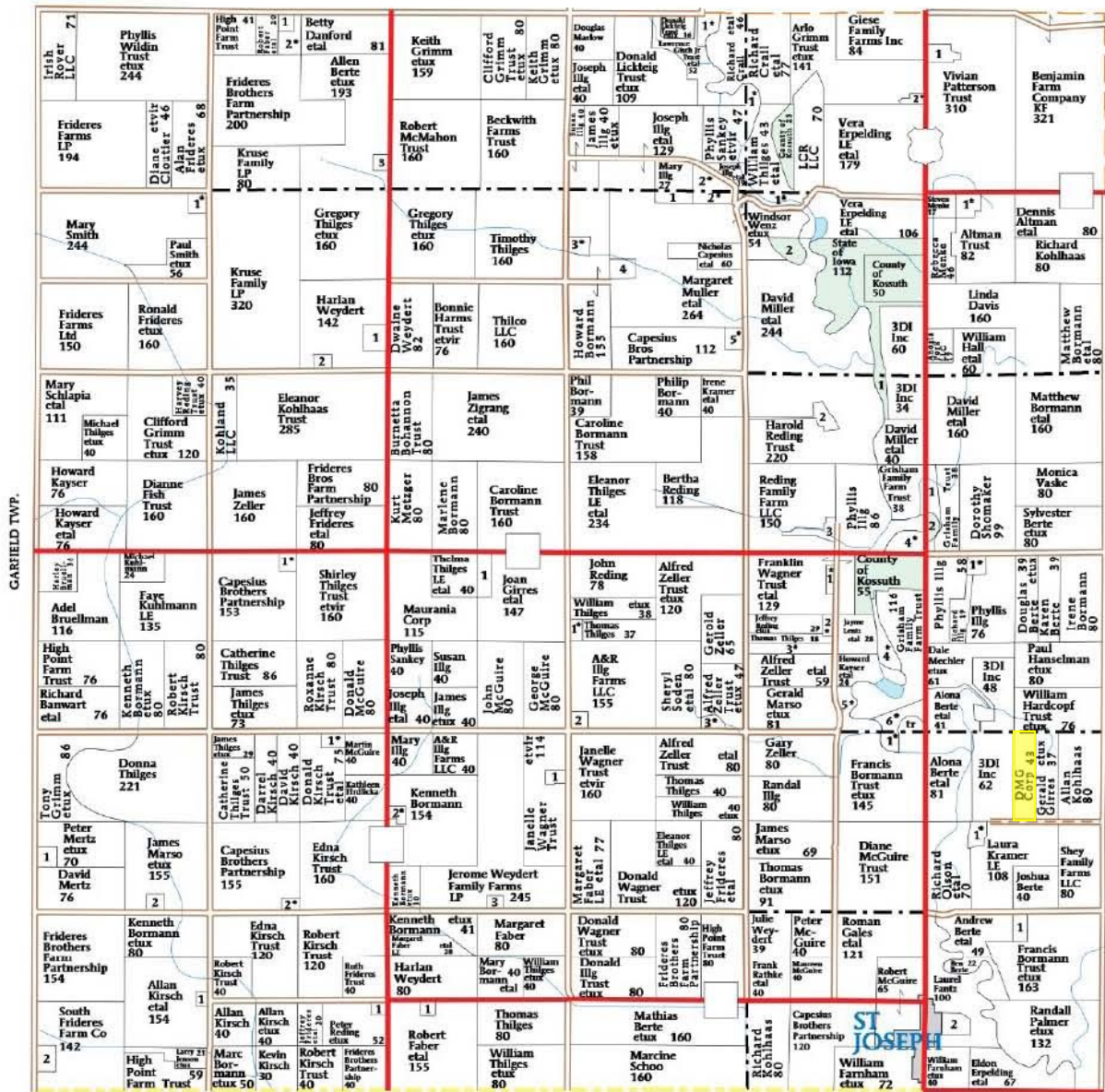

**RIVERDALE TOWNSHIP**

- SECTION 1**  
1. Waldera, Robert 11
- SECTION 2**  
1. Sankey, Phyllis etvir 8  
2. Grimm, Alan etal 9
- SECTION 3**  
1. Gisch, Dennis etal 10  
2. Sankey, Phyllis etvir 16
- SECTION 5**  
1. Faber, Rodney 5  
2. Faber, Robert etal 15  
3. Farm Solutions LLC 5
- SECTION 7**  
1. Smith, Paul etux 7

- SECTION 8**  
1. Weydert Agricultural Asset Man 12  
2. North IA Custom Finishing Inc 5
- SECTION 10**  
1. Ilg, Mary 10  
2. Sankey, Phyllis etvir 10  
3. Kutschura, Adam etux 5  
4. Ca' esius Bros Inc 11  
5. Reding, William etux 8
- SECTION 11**  
1. Thilges, William etux 6  
2. County o" Kossuth 11

- SECTION 12**  
1. VonBank, Donald etux 15
- SECTION 13**  
1. Er' elding, Gary 12  
2. State o" Iowa 0
- SECTION 14**  
1. State o" Iowa 6  
2. Reding, John 12  
3. Kutschura, Richard 11  
4. Pesicka, Leroy etux 17
- SECTION 20**  
1. Fehr, Jason etux 7
- SECTION 21**  
1. Riverdale Ranch LLC 13

- SECTION 22**  
1. Kayser, Peter etux 7  
2. McGuire Jr, Edward 5  
3. Zeller, Gary etux 8
- SECTION 23**  
1. Thilges, William etux 6  
2. Thilges, Dennis etux 5  
3. Thilges, William etux 18  
4. Mullen, Gary etal 10  
5. Bormann Trust, Francis etux 17
- SECTION 24**  
1. Olson, Ste' hen etux 12  
2. Kohlhaas, Bruce etux 8

- SECTION 25**  
1. Collins, Thomas etux 10
- SECTION 26**  
1. Olson, Ste' hen etux 7
- SECTION 28**  
1. Thilges, William 6  
2. Bormann, Kenneth etux 6  
3. North IA Custom Finishing Inc 5
- SECTION 29**  
1. Kirsch, Dennis etal 5  
2. Ca' esius, Robert etal 5

- SECTION 30**  
1. Mertz Brothers Partnership' 7  
2. MTM Pork LLC 5
- SECTION 31**  
1. Kirsch Finisher LLC 6  
2. Frideres Pork LLC 10
- SECTION 32**  
1. Bormann, Roxanne 8
- SECTION 33**  
1. Faber, Ryan 5
- SECTION 36**  
1. Ehlers, Ste' hanie 8  
2. Thilges Trust, Kelly 11

HUMBOLDT CO.