

Soils Map - Tillable Acres

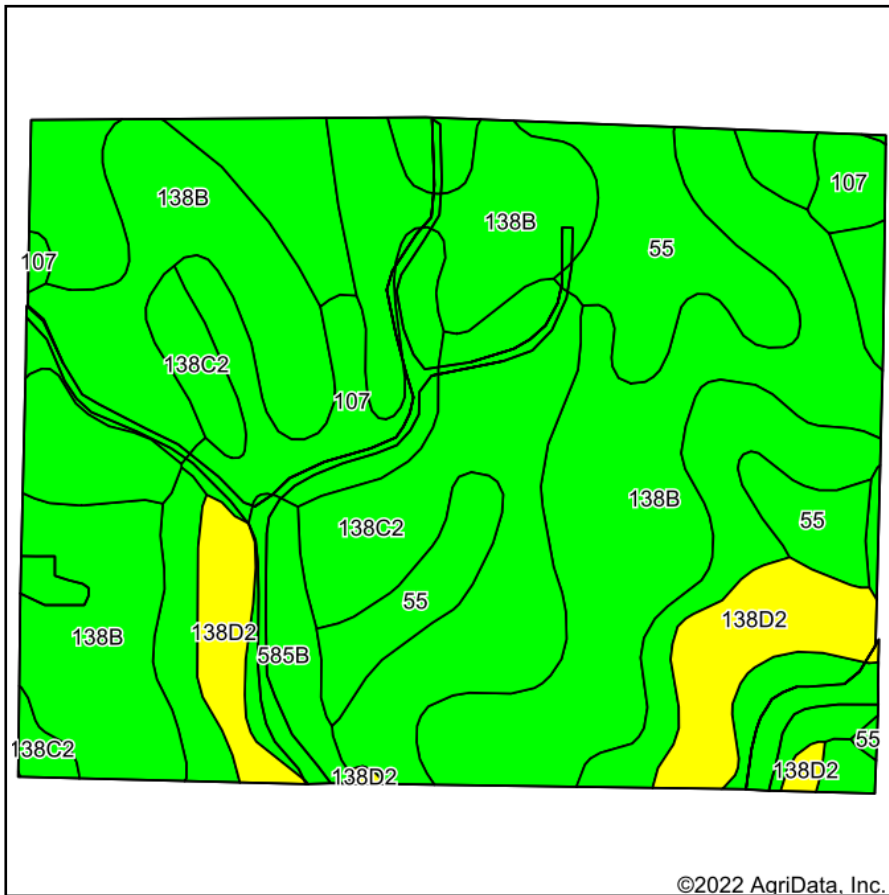

Soils data provided by USDA and NRCS.

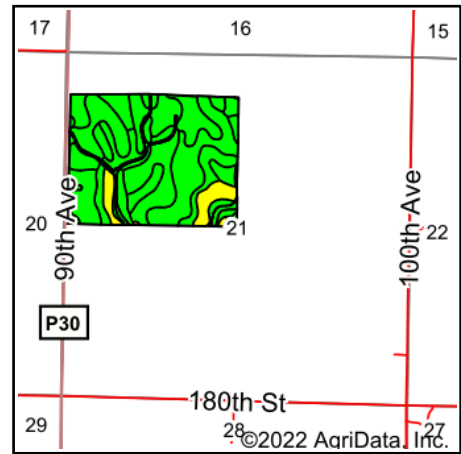

State: **Iowa**
 County: **Kossuth**
 Location: **21-95N-29W**
 Township: **Cresco**
 Acres: **116.32**
 Date: **6/9/2022**



Maps Provided By:



Area Symbol: IA109, Soil Area Version: 28

Code	Soil Description	Acres	Percent of field	CSR2 Legend	Non-Irr Class *c	*i Corn Bu	*i Alfalfa Tons	*i Soybeans Bu	CSR2**	*n NCCPI Corn	*n NCCPI Soybeans	
138B	Clarion loam, 2 to 6 percent slopes	45.40	39.0%		Ile	225.6	6.3	65.4	89	80	84	
138C2	Clarion loam, 6 to 10 percent slopes, moderately eroded	24.46	21.0%		IIle	204.8	5.7	59.4	83	71	73	
55	Nicollet clay loam, 1 to 3 percent slopes	23.51	20.2%		Iw	233.6	6.1	67.7	89	81	82	
107	Webster clay loam, 0 to 2 percent slopes	8.22	7.1%		IIw	224.0	4.7	65.0	86	78	82	
138D2	Clarion loam, 9 to 14 percent slopes, moderately eroded	7.94	6.8%		IIIle	176.0	4.9	51.0	51	69	57	
585B	Colo-Spillville complex, 2 to 5 percent slopes	6.79	5.8%		IIw	203.2	4.3	58.9	79	85	85	
Weighted Average						2.08	218	5.8	63.2	84.3	*n 77.7	*n 79.4

**IA has updated the CSR values for each county to CSR2.

*i Yield data provided by the ISPAID Database version 8.1.1 developed by IA State University.

*n: The aggregation method is "Weighted Average using all components"

*c: Using Capabilities Class Dominant Condition Aggregation Method

Soils data provided by USDA and NRCS.