

Soils Map - Total Acres

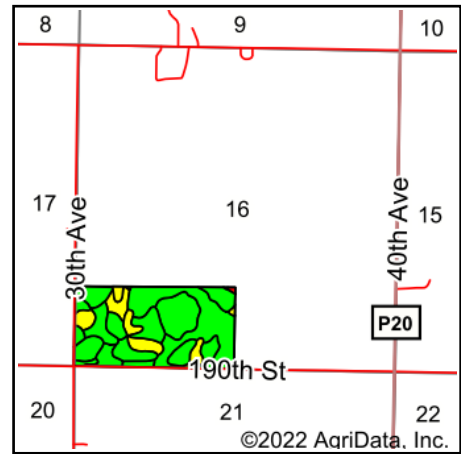

State: **Iowa**
 County: **Kossuth**
 Location: **16-95N-30W**
 Township: **Whittemore**
 Acres: **79.58**
 Date: **6/30/2022**

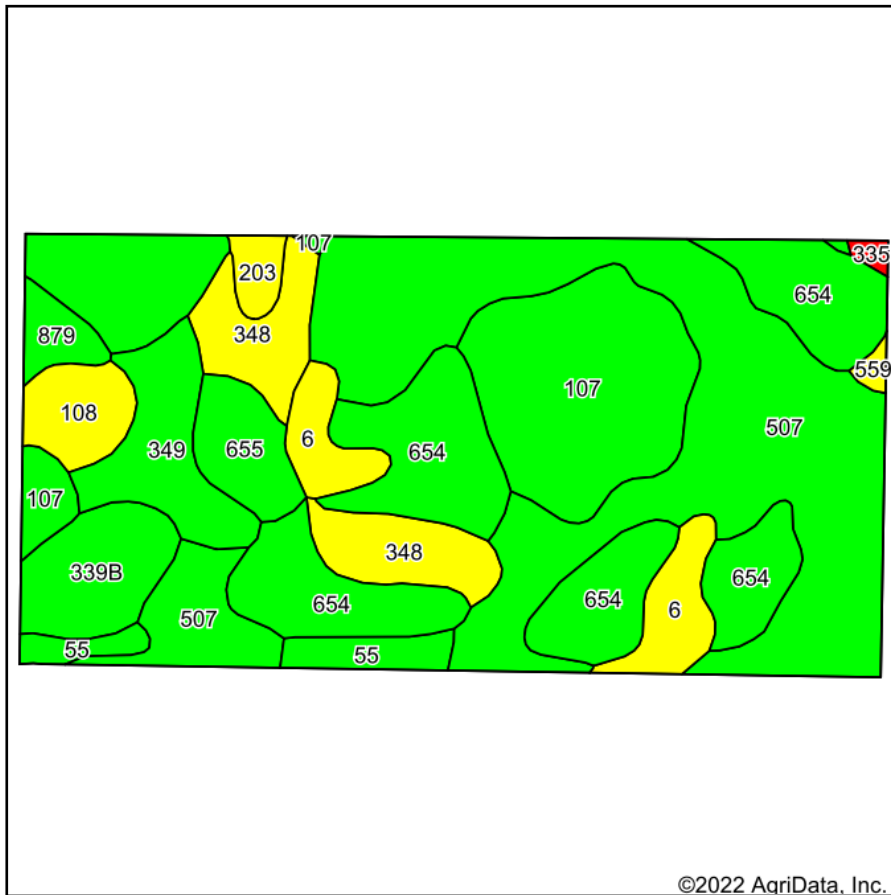

Soils data provided by USDA and NRCS.

©2022 AgriData, Inc.

Area Symbol: IA109, Soil Area Version: 28

Code	Soil Description	Acres	Percent of field	CSR2 Legend	Non-Irr Class *c	*i Corn Bu	*i Alfalfa Tons	*i Soybeans Bu	CSR2**	*n NCCPI Overall	
507	Canisteo clay loam, 0 to 2 percent slopes	29.16	36.6%		Ilw	224.0	4.7	65.0	84	81	
654	Corwith loam, 1 to 3 percent slopes	15.61	19.6%		lw	208.0	5.4	60.3	83	83	
107	Webster clay loam, 0 to 2 percent slopes	10.11	12.7%		Ilw	224.0	4.7	65.0	86	83	
348	Fieldon loam, 0 to 2 percent slopes	5.23	6.6%		Ilw	80.0	1.7	23.2	54	63	
349	Darfur loam, 0 to 2 percent slopes	3.93	4.9%		Ilw	198.4	4.2	57.5	74	80	
6	Okoboji silty clay loam, 0 to 1 percent slopes	3.52	4.4%		Illw	177.6	3.7	51.5	59	76	
339B	Truman silt loam, 2 to 6 percent slopes	3.45	4.3%		Ile	232.0	6.5	67.3	95	91	
655	Crippin loam, 1 to 3 percent slopes	2.31	2.9%		Ie	233.6	6.1	67.7	91	87	
108	Wadena loam, 0 to 2 percent slopes	2.05	2.6%		Ils	80.0	2.2	23.2	56	64	
55	Nicollet clay loam, 1 to 3 percent slopes	1.88	2.4%		lw	233.6	6.1	67.7	89	82	
879	Fostoria loam, 0 to 2 percent slopes	1.08	1.4%		lw	233.6	6.1	67.7	95	82	
203	Cylinder loam, 0 to 2 percent slopes	0.79	1.0%		Ils	80.0	2.1	23.2	58	73	
559	Talcot clay loam, 32 to 40 inches to sand and gravel, 0 to 2 percent slopes	0.25	0.3%		Ilw	80.0	1.7	23.2	54	66	
335	Harcot loam, 0 to 2 percent slopes	0.21	0.3%		Ilw	80.0	1.7	23.2	39	65	
Weighted Average						1.78	203.1	4.6	58.9	80.2	*n 80.2

**IA has updated the CSR values for each county to CSR2.

*i Yield data provided by the ISPAID Database version 8.1.1 developed by IA State University.

*n: The aggregation method is "Weighted Average using all components"

*c: Using Capabilities Class Dominant Condition Aggregation Method

Soils data provided by USDA and NRCS.