

Soils Map

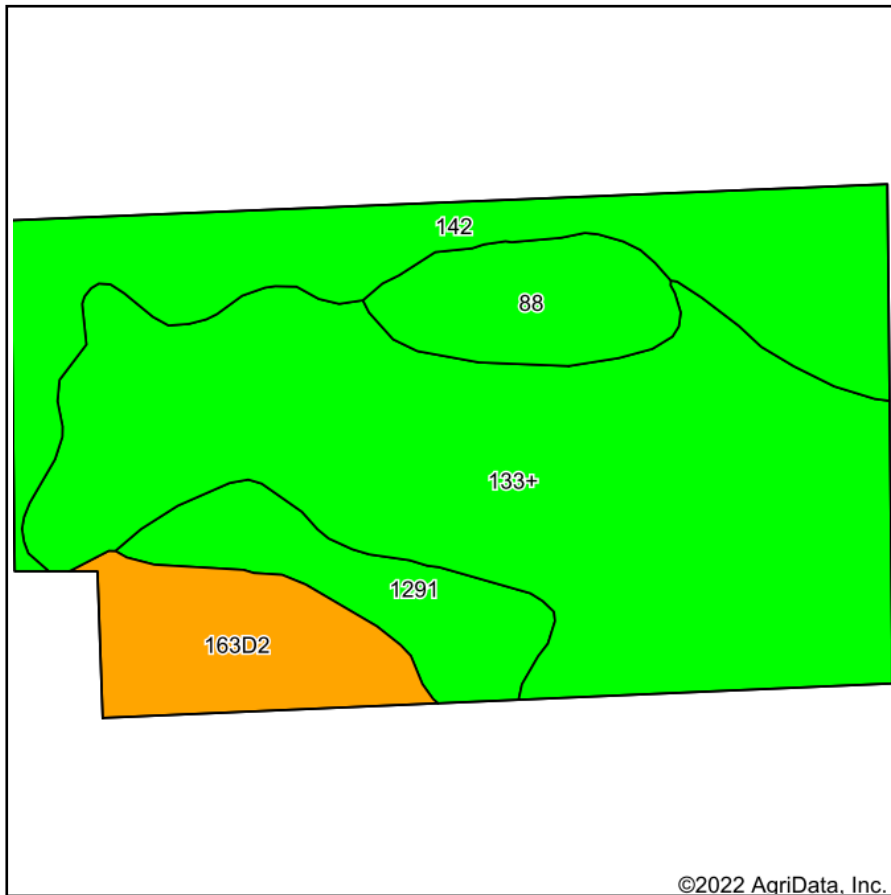

Soils data provided by USDA and NRCS.

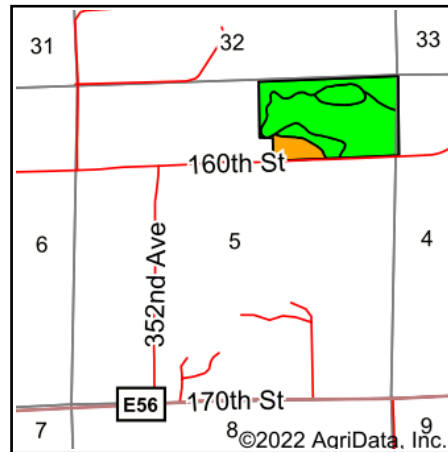

State: **Iowa**
 County: **Clinton**
 Location: **5-82N-5E**
 Township: **Center**
 Acres: **67.35**
 Date: **4/25/2022**



Maps Provided By:



© AgriData, Inc. 2021

www.AgriDataInc.com



Area Symbol: IA045, Soil Area Version: 27

Code	Soil Description	Acres	Percent of field	CSR2 Legend	Non-Irr Class *c	*i Corn Bu	*i Alfalfa Tons	*i Soybeans Bu	CSR2**	*n NCCPI Corn	*n NCCPI Soybeans
133+	Colo silt loam, 0 to 2 percent slopes, occasionally flooded, overwash	35.61	52.9%		IIw	204.8	4.3	59.4	78	80	82
142	Chaseburg silt loam, moderately well drained, 0 to 2 percent slopes	14.79	22.0%		IIw	180.8	5.1	52.4	79	84	86
163D2	Fayette silt loam, 9 to 14 percent slopes, moderately eroded	6.38	9.5%		IIIe	164.8	4.6	47.8	46	80	64
1291	Atterberry silt loam, benches, 1 to 3 percent slopes	5.53	8.2%		Ile	224.0	5.8	65.0	85	93	93
88	Nevin silty clay loam, 0 to 2 percent slopes	5.04	7.5%		Iw	227.2	5.9	65.9	95	98	88
Weighted Average						2.02	199	4.7	77	*n 83.3	*n 82.5

**IA has updated the CSR values for each county to CSR2.

*i Yield data provided by the ISPAID Database version 8.1.1 developed by IA State University.

*n: The aggregation method is "Weighted Average using all components"

*c: Using Capabilities Class Dominant Condition Aggregation Method

Soils data provided by USDA and NRCS.