

Soils Map

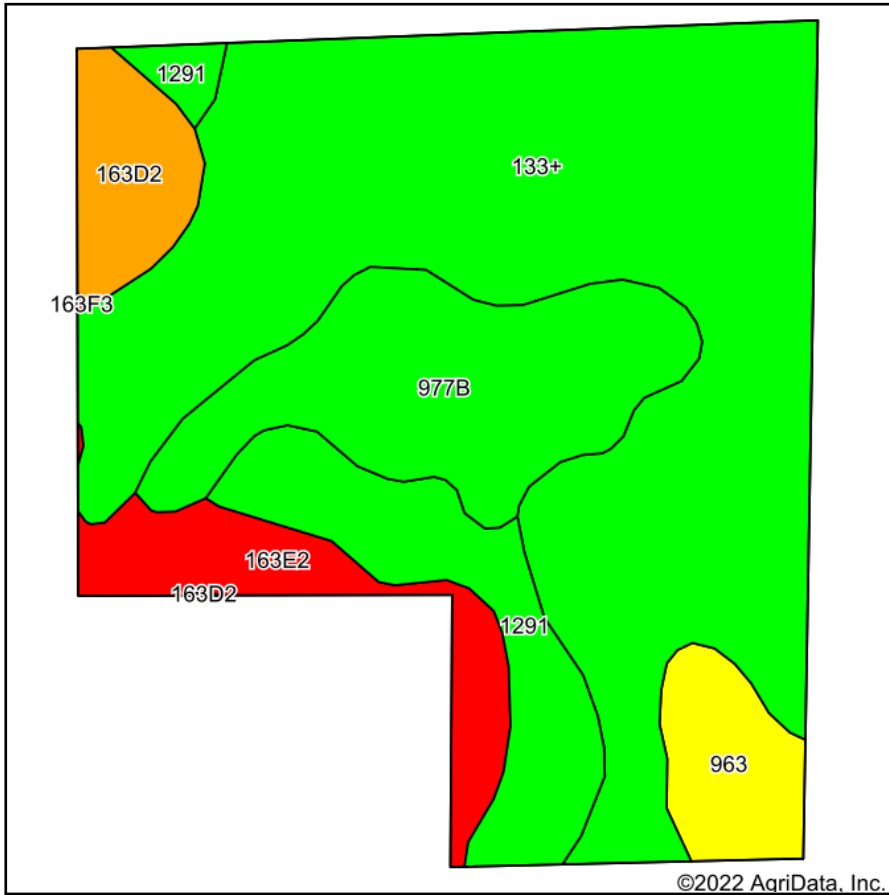

Soils data provided by USDA and NRCS.

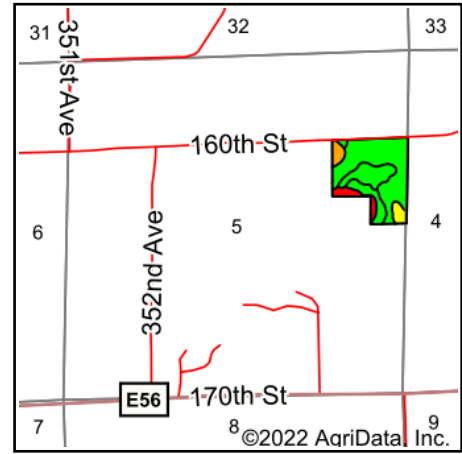

State: **Iowa**
 County: **Clinton**
 Location: **5-82N-5E**
 Township: **Center**
 Acres: **29.66**
 Date: **4/25/2022**



Maps Provided By:



© AgriData, Inc. 2021

www.AgriDataInc.com

Area Symbol: IA045, Soil Area Version: 27

Code	Soil Description	Acres	Percent of field	CSR2 Legend	Non-Irr Class *c	*i Corn Bu	*i Alfalfa Tons	*i Soybeans Bu	CSR2**	*n NCCPI Corn	*n NCCPI Soybeans
133+	Colo silt loam, 0 to 2 percent slopes, occasionally flooded, overwash	16.84	56.8%		IIw	204.8	4.3	59.4	78	80	82
977B	Richwood silt loam, 1 to 6 percent slopes	4.67	15.7%		Ile				90	91	85
1291	Atterberry silt loam, benches, 1 to 3 percent slopes	3.24	10.9%		Ile	224.0	5.8	65.0	85	93	93
163E2	Fayette silt loam, 14 to 18 percent slopes, moderately eroded	2.07	7.0%		IVe	140.8	3.9	40.8	35	76	59
963	Elvers silt loam, 0 to 2 percent slopes	1.44	4.9%		IIw	169.6	3.6	49.2	64	65	82
163D2	Fayette silt loam, 9 to 14 percent slopes, moderately eroded	1.40	4.7%		IIIe	164.8	4.6	47.8	46	80	64
Weighted Average						2.19	166.6	3.7	75.5	*n 82.1	*n 81.2

**IA has updated the CSR values for each county to CSR2.

*i Yield data provided by the ISPAID Database version 8.1.1 developed by IA State University.

*n: The aggregation method is "Weighted Average using all components"

*c: Using Capabilities Class Dominant Condition Aggregation Method

Soils data provided by USDA and NRCS.