

# Tract Four - Tillable Soils Map

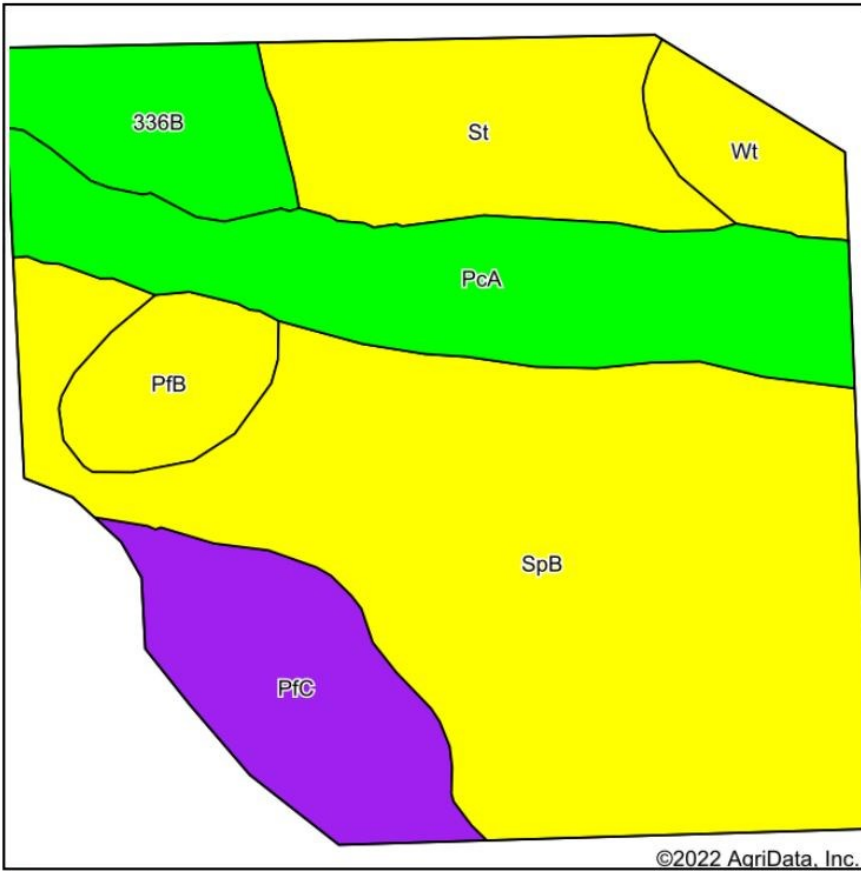

Soils data provided by USDA and NRCS.

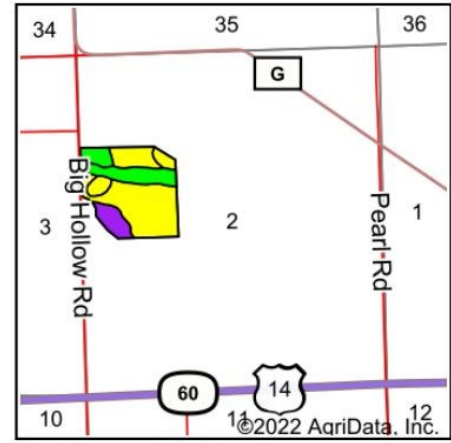

State: **Wisconsin**  
 County: **Sauk**  
 Location: **2-8N-3E**  
 Township: **Spring Green**  
 Acres: **55**  
 Date: **1/25/2022**



Maps Provided By:



Area Symbol: WI111, Soil Area Version: 19

Code	Soil Description	Acres	Percent of field	NCCPI Overall Legend	Non-Irr Class *c	Irr Class *c	*n NCCPI Overall
SpB	Sparta loamy sand, 1 to 6 percent slopes	24.96	45.4%		IVs	Ile	53
PcA	Pilot silt loam, 0 to 2 percent slopes	9.50	17.3%		IIIs		83
St	Sparta variant loamy sand	6.48	11.8%		IVs		54
PfC	Plainfield loamy sand, 6 to 12 percent slopes	5.72	10.4%		VIs		24
336B	Toddsville silt loam, 1 to 6 percent slopes	3.57	6.5%		Ile		90
PfB	Plainfield loamy sand, river valley, 1 to 6 percent slopes	2.62	4.8%		IVs		36
Wt	Watseka loamy sand	2.15	3.9%		IVw		56
<b>Weighted Average</b>					<b>3.73</b>	<b>0.91</b>	<b>*n 57</b>

\*n: The aggregation method is "Weighted Average using all components"

\*c: Using Capabilities Class Dominant Condition Aggregation Method

Soils data provided by USDA and NRCS.