

# Soils Map

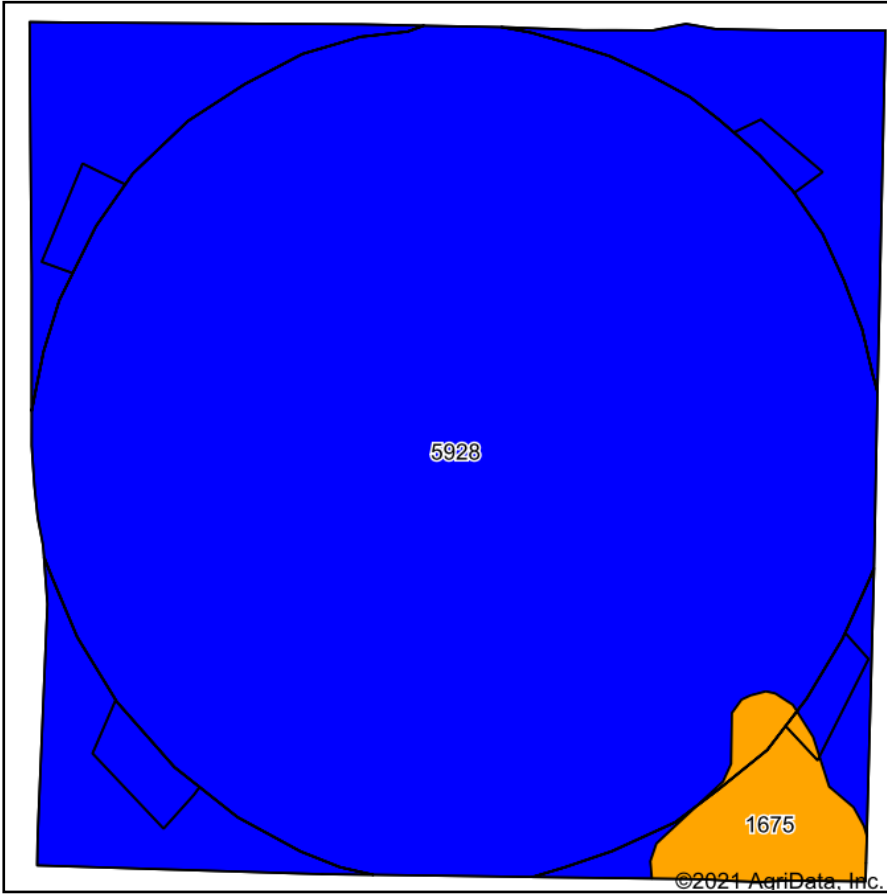

Soils data provided by USDA and NRCS.

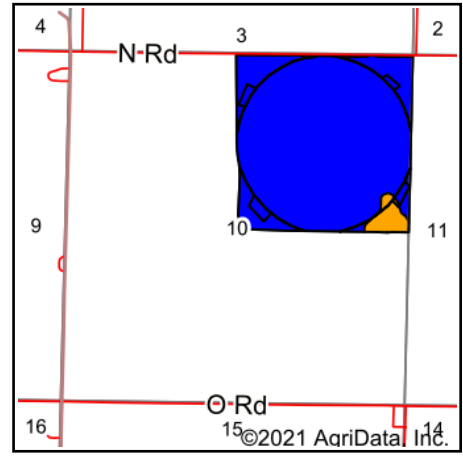

State: **Kansas**  
 County: **Gray**  
 Location: **10-26S-30W**  
 Township: **Ingalls**  
 Acres: **164.41**  
 Date: **10/7/2021**



Maps Provided By:



Area Symbol: KS069, Soil Area Version: 17

Code	Soil Description	Acres	Percent of field	Irr class Legend	Non-Irr Class *c	Irr Class *c	*n NCCPI Overall
5928	Pratt loamy fine sand, 1 to 5 percent slopes	158.71	96.5%		IIIe	IIe	34
1675	Manter fine sandy loam, 3 to 5 percent slopes, eroded	5.70	3.5%		IIIe	IIIe	40
<b>Weighted Average</b>					<b>3.00</b>	<b>2.03</b>	<b>*n 34.2</b>

\*n: The aggregation method is "Weighted Average using all components"

\*c: Using Capabilities Class Dominant Condition Aggregation Method

Soils data provided by USDA and NRCS.