

Soils Map

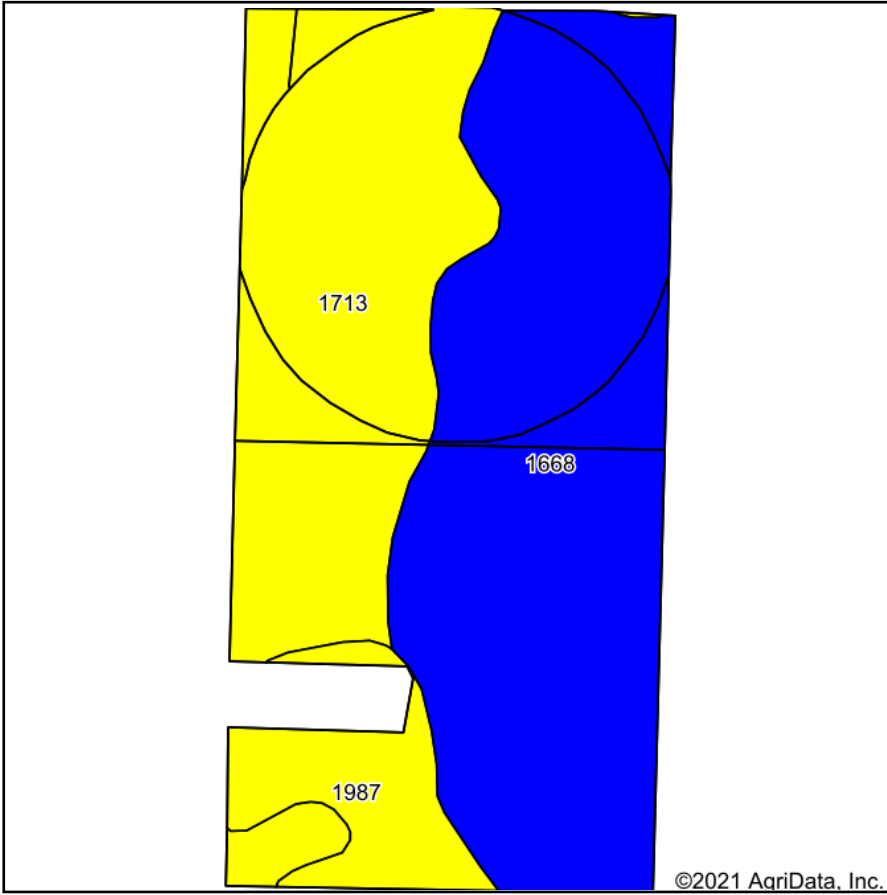

Soils data provided by USDA and NRCS.

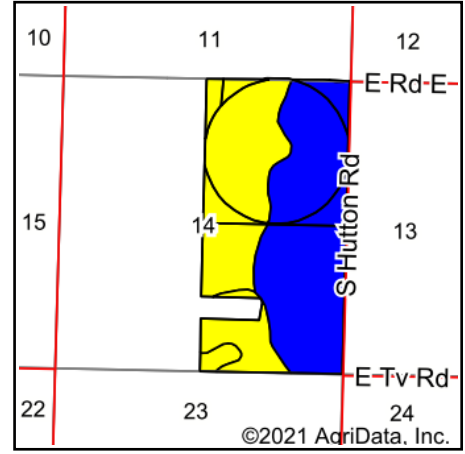

State: **Kansas**
 County: **Finney**
 Location: **14-26S-31W**
 Township: **Pierceville**
 Acres: **309.04**
 Date: **10/7/2021**



Maps Provided By:



Area Symbol: KS055, Soil Area Version: 18

Code	Soil Description	Acres	Percent of field	Irr class Legend	Non-Irr Class *c	Irr Class *c	*n NCCPI Overall
1668	Manter fine sandy loam, 1 to 3 percent slopes	165.68	53.6%		IIIe	IIIs	43
1713	Otero-Ulysses complex, 0 to 5 percent slopes	116.48	37.7%		VIe	IVe	44
1987	Vona loamy fine sand, 0 to 5 percent slopes	26.88	8.7%		IVe	IVe	29
Weighted Average					4.22	2.93	*n 42.2

*n: The aggregation method is "Weighted Average using all components"

*c: Using Capabilities Class Dominant Condition Aggregation Method

Soils data provided by USDA and NRCS.