

Soils Map

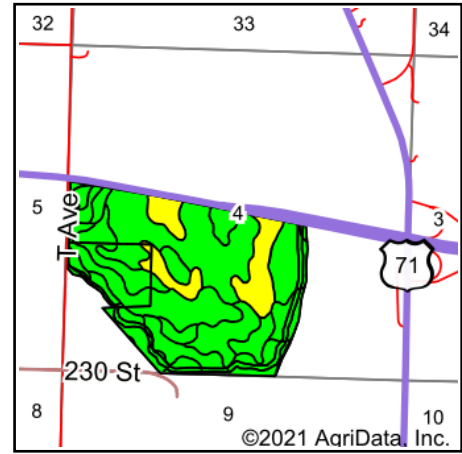

State: **Iowa**
 County: **Montgomery**
 Location: **4-71N-36W**
 Township: **East**
 Acres: **187.99**
 Date: **9/2/2021**

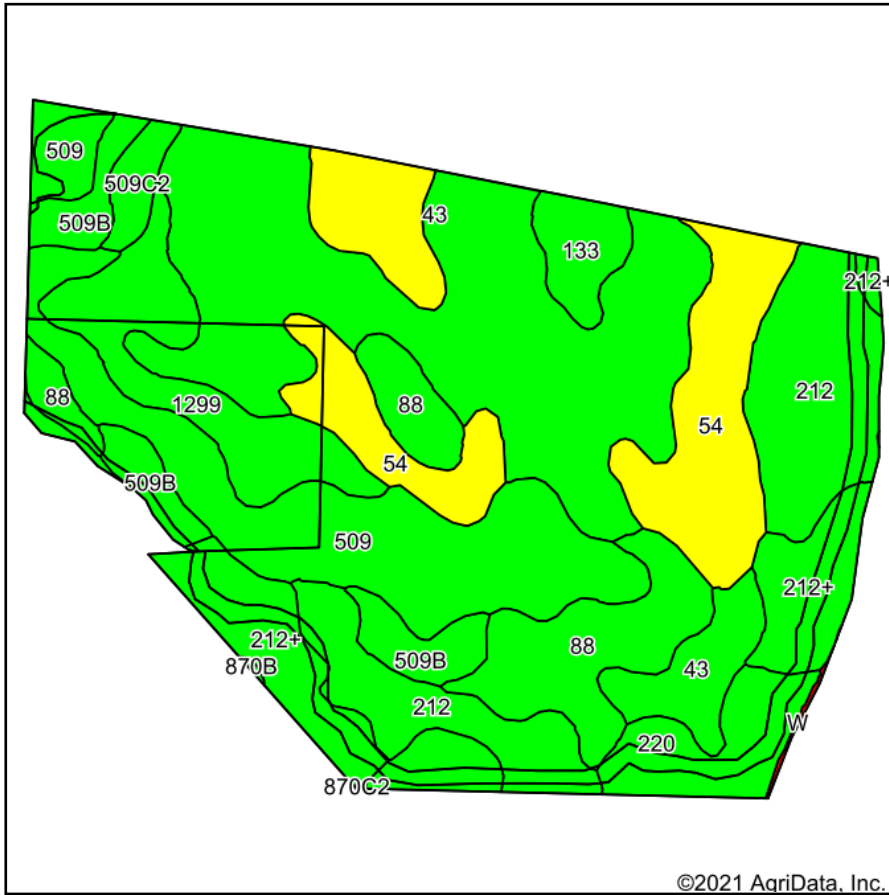

Maps Provided By:



Soils data provided by USDA and NRCS.

©2021 AgriData, Inc.

© AgriData, Inc. 2021

www.AgriDataInc.com

Area Symbol: IA137, Soil Area Version: 28

Code	Soil Description	Acres	Percent of field	CSR2 Legend	Non-Irr Class *c	CSR2**	CSR	*n NCCPI Overall
43	Bremer silty clay loam, 0 to 2 percent slopes, occasionally flooded	50.10	26.7%		IIw	74	80	85
509	Marshall silty clay loam, terrace, 0 to 2 percent slopes	26.09	13.9%		Ile	99	90	97
54	Zook silty clay loam, 0 to 2 percent slopes, occasionally flooded	25.62	13.6%		IIw	67	70	63
212	Kennebec silt loam, 0 to 2 percent slopes, occasionally flooded	21.36	11.4%		Iw	91	86	95
88	Nevin silty clay loam, 0 to 2 percent slopes, rarely flooded	15.57	8.3%		Iw	95	90	98
212+	Kennebec silt loam, 0 to 2 percent slopes, occasionally flooded, overwash	14.22	7.6%		Iw	91	86	95
1299	Minden silty clay loam, benches, 0 to 2 percent slopes	11.60	6.2%		Iw	96	95	98
220	Nodaway silt loam, 0 to 2 percent slopes, occasionally flooded	9.40	5.0%		IIw	82	85	96
509B	Marshall silty clay loam, terrace, 2 to 5 percent slopes	7.77	4.1%		Ile	94	85	96
133	Colo silty clay loam, deep loess, 0 to 2 percent slopes, occasionally flooded	3.80	2.0%		IIw	78	80	81
509C2	Marshall silty clay loam, terrace, 5 to 9 percent slopes, eroded	2.16	1.1%		IIIle	88	68	87
W	Water	0.22	0.1%			0	0	
870B	Sharpsburg silty clay loam, terrace, 2 to 5 percent slopes	0.08	0.0%		Ile	91	87	91
Weighted Average						84.2	83.1	*n 88.3

**IA has updated the CSR values for each county to CSR2.

*n: The aggregation method is "Weighted Average using all components"

*c: Using Capabilities Class Dominant Condition Aggregation Method

Soils data provided by USDA and NRCS.