

Soils Map

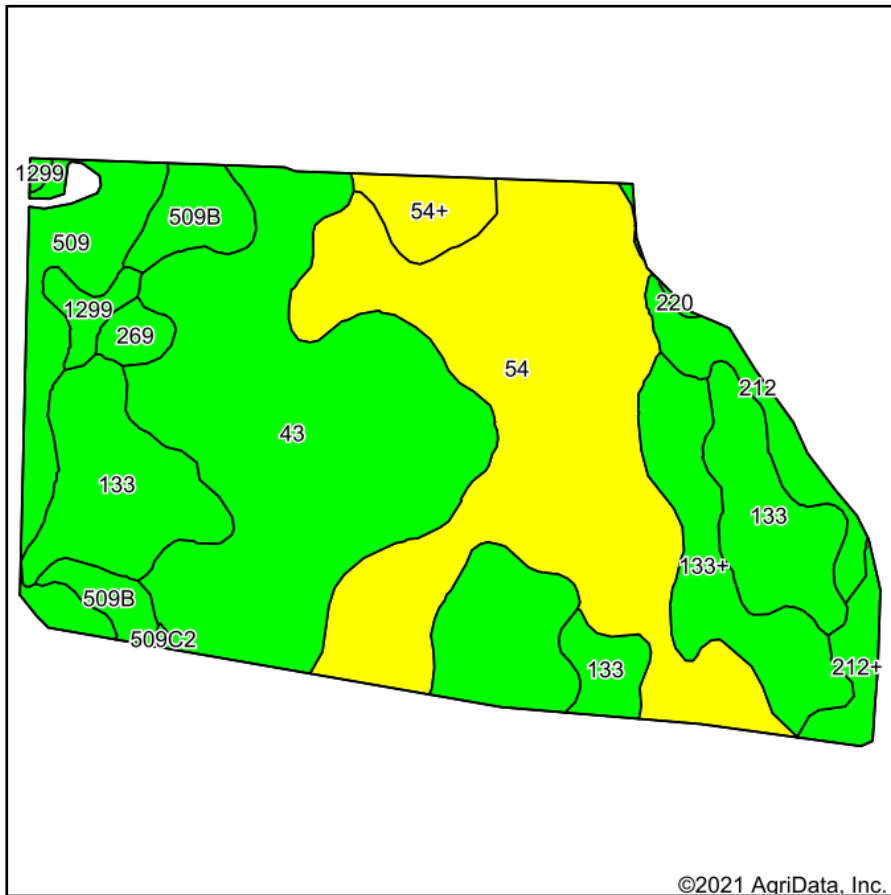

©2021 AgriData, Inc.

Soils data provided by USDA and NRCS.

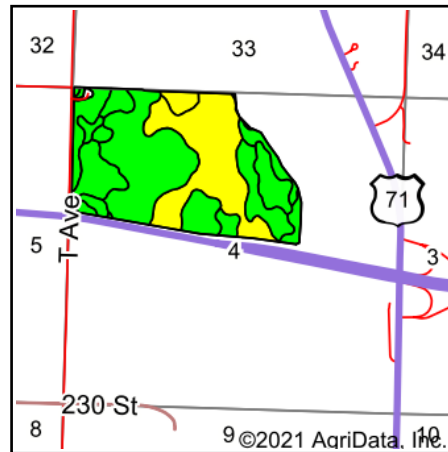

State: **Iowa**
 County: **Montgomery**
 Location: **4-71N-36W**
 Township: **East**
 Acres: **160.34**
 Date: **9/2/2021**



Maps Provided By:



Area Symbol: IA137, Soil Area Version: 28

Code	Soil Description	Acres	Percent of field	CSR2 Legend	Non-Irr Class *c	CSR2**	CSR	*n NCCPI Overall
43	Bremer silty clay loam, 0 to 2 percent slopes, occasionally flooded	49.99	31.2%		Ilw	74	80	85
54	Zook silty clay loam, 0 to 2 percent slopes, occasionally flooded	47.68	29.7%		Ilw	67	70	63
133	Colo silty clay loam, deep loess, 0 to 2 percent slopes, occasionally flooded	21.73	13.6%		Ilw	78	80	81
133+	Colo silt loam, deep loess, 0 to 2 percent slopes, overwash, occasionally flooded	10.53	6.6%		Ilw	78	85	85
509	Marshall silty clay loam, terrace, 0 to 2 percent slopes	9.59	6.0%		Ie	99	90	97
509B	Marshall silty clay loam, terrace, 2 to 5 percent slopes	5.61	3.5%		Ile	94	85	96
212	Kennebec silt loam, 0 to 2 percent slopes, occasionally flooded	4.75	3.0%		Iw	91	86	95
54+	Zook silt loam, 0 to 2 percent slopes, occasionally flooded, overwash	3.60	2.2%		Ilw	69	75	66
212+	Kennebec silt loam, 0 to 2 percent slopes, occasionally flooded, overwash	2.90	1.8%		Iw	91	86	95
1299	Minden silty clay loam, benches, 0 to 2 percent slopes	2.04	1.3%		Iw	96	95	98
269	Humeston silt loam, 0 to 2 percent slopes	1.53	1.0%		Illw	72	58	80
220	Nodaway silt loam, 0 to 2 percent slopes, occasionally flooded	0.26	0.2%		Ilw	82	85	96
509C2	Marshall silty clay loam, terrace, 5 to 9 percent slopes, eroded	0.13	0.1%		Ille	88	68	87
Weighted Average						75.9	78.3	*n 79.2

**IA has updated the CSR values for each county to CSR2.

*n: The aggregation method is "Weighted Average using all components"

*c: Using Capabilities Class Dominant Condition Aggregation Method

Soils data provided by USDA and NRCS.