

Soils Map

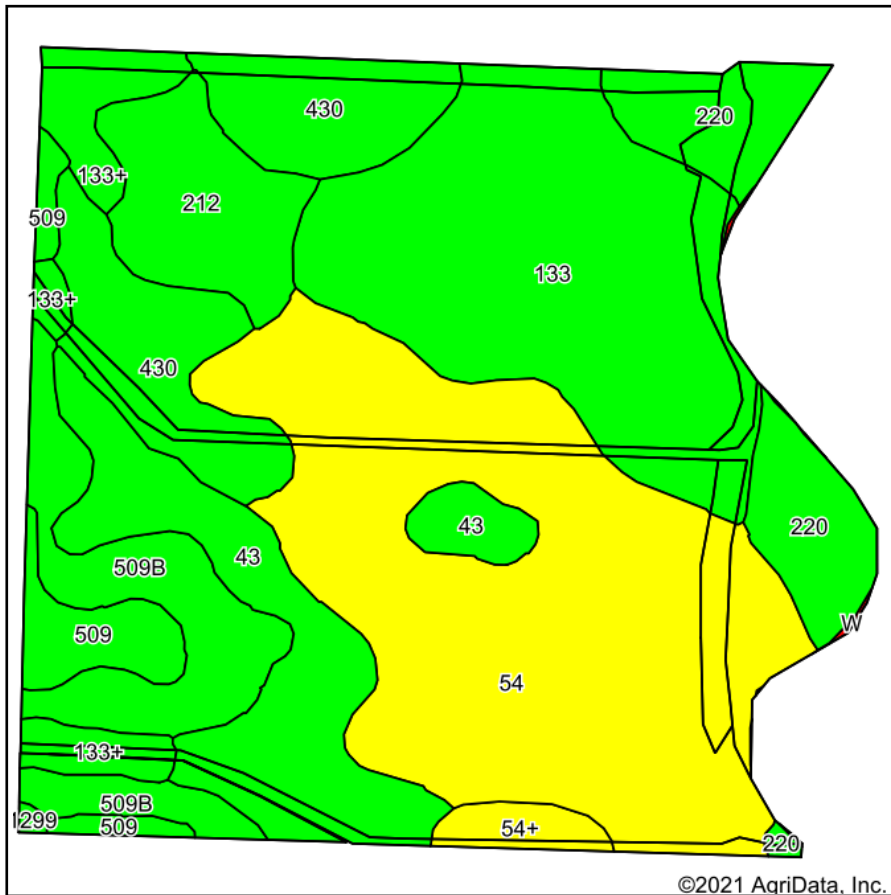

Soils data provided by USDA and NRCS.

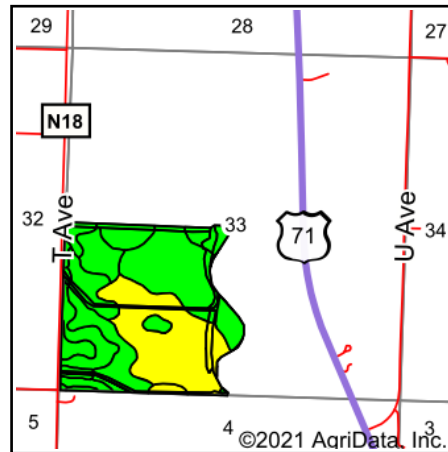

State: **Iowa**
 County: **Montgomery**
 Location: **33-72N-36W**
 Township: **Washington**
 Acres: **148.91**
 Date: **9/2/2021**



Maps Provided By:



Area Symbol: IA137, Soil Area Version: 28

Code	Soil Description	Acres	Percent of field	CSR2 Legend	Non-Irr Class *c	CSR2**	CSR	*n NCCPI Overall
54	Zook silty clay loam, 0 to 2 percent slopes, occasionally flooded	45.93	30.8%	Yellow	Ilw	67	70	63
133	Colo silty clay loam, deep loess, 0 to 2 percent slopes, occasionally flooded	30.53	20.5%	Green	Ilw	78	80	81
43	Bremer silty clay loam, 0 to 2 percent slopes, occasionally flooded	16.03	10.8%	Green	Ilw	74	80	85
430	Ackmore silt loam, 0 to 2 percent slopes, occasionally flooded	14.50	9.7%	Green	Ilw	77	83	90
509B	Marshall silty clay loam, terrace, 2 to 5 percent slopes	11.80	7.9%	Green	Ile	94	85	96
220	Nodaway silt loam, 0 to 2 percent slopes, occasionally flooded	9.82	6.6%	Green	Ilw	82	85	96
212	Kennebec silt loam, 0 to 2 percent slopes, occasionally flooded	8.07	5.4%	Green	lw	91	86	95
133+	Colo silt loam, deep loess, 0 to 2 percent slopes, overwash, occasionally flooded	5.46	3.7%	Green	Ilw	78	85	85
509	Marshall silty clay loam, terrace, 0 to 2 percent slopes	4.67	3.1%	Green	Ie	99	90	97
54+	Zook silt loam, 0 to 2 percent slopes, occasionally flooded, overwash	1.77	1.2%	Yellow	Ilw	69	75	66
1299	Minden silty clay loam, benches, 0 to 2 percent slopes	0.18	0.1%	Green	lw	96	95	98
W	Water	0.15	0.1%	Red		0	0	
Weighted Average						76.8	78.6	*n 80.1

**IA has updated the CSR values for each county to CSR2.

*n: The aggregation method is "Weighted Average using all components"

*c: Using Capabilities Class Dominant Condition Aggregation Method

Soils data provided by USDA and NRCS.