

# Soils Map

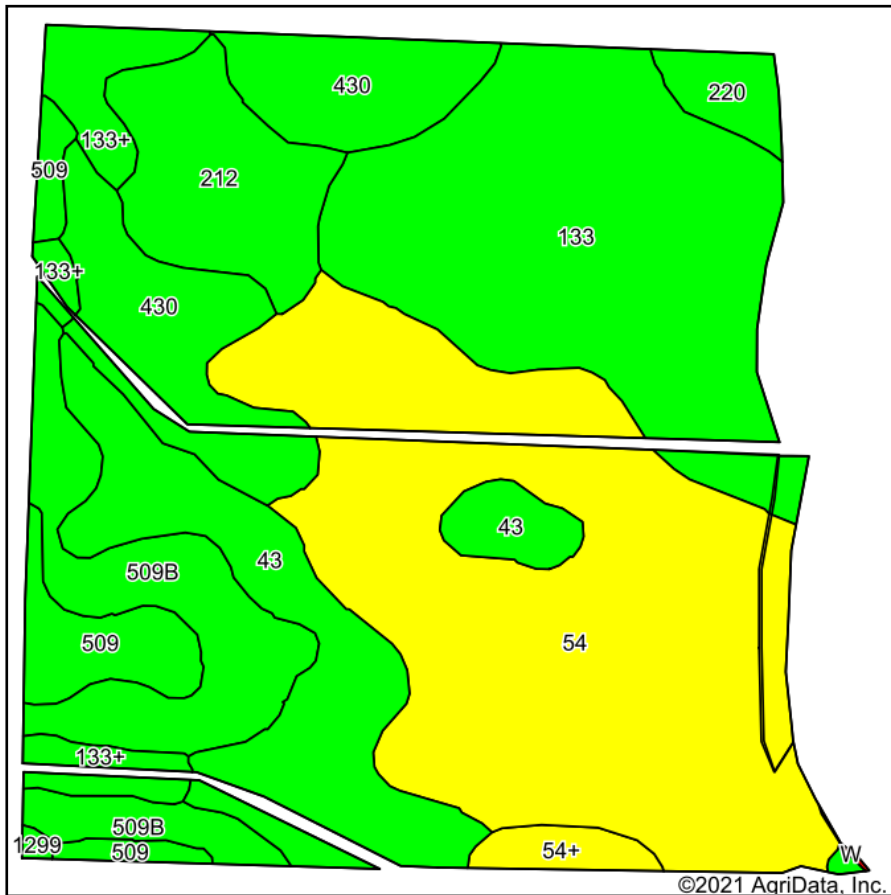

Soils data provided by USDA and NRCS.

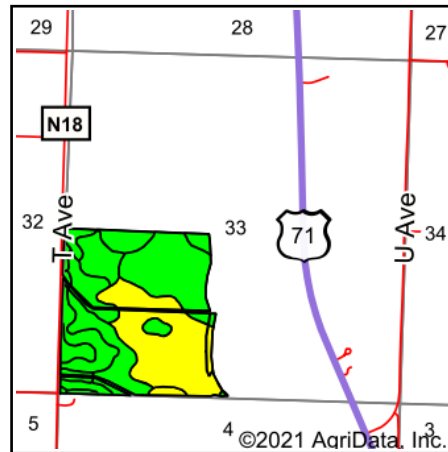

State: **Iowa**  
 County: **Montgomery**  
 Location: **33-72N-36W**  
 Township: **Washington**  
 Acres: **131.91**  
 Date: **9/2/2021**



Maps Provided By:



Area Symbol: IA137, Soil Area Version: 28

Code	Soil Description	Acres	Percent of field	CSR2 Legend	Non-Irr Class *c	CSR2**	CSR	*n NCCPI Overall
54	Zook silty clay loam, 0 to 2 percent slopes, occasionally flooded	42.52	32.2%	Yellow	Ilw	67	70	63
133	Colo silty clay loam, deep loess, 0 to 2 percent slopes, occasionally flooded	27.70	21.0%	Green	Ilw	78	80	81
43	Bremer silty clay loam, 0 to 2 percent slopes, occasionally flooded	15.43	11.7%	Green	Ilw	74	80	85
430	Ackmore silt loam, 0 to 2 percent slopes, occasionally flooded	13.04	9.9%	Green	Ilw	77	83	90
509B	Marshall silty clay loam, terrace, 2 to 5 percent slopes	11.86	9.0%	Green	Ile	94	85	96
212	Kennebec silt loam, 0 to 2 percent slopes, occasionally flooded	8.07	6.1%	Green	lw	91	86	95
509	Marshall silty clay loam, terrace, 0 to 2 percent slopes	4.90	3.7%	Green	Ile	99	90	97
133+	Colo silt loam, deep loess, 0 to 2 percent slopes, overwash, occasionally flooded	4.67	3.5%	Green	Ilw	78	85	85
220	Nodaway silt loam, 0 to 2 percent slopes, occasionally flooded	2.03	1.5%	Green	Ilw	82	85	96
54+	Zook silt loam, 0 to 2 percent slopes, occasionally flooded, overwash	1.51	1.1%	Yellow	Ilw	69	75	66
1299	Minden silty clay loam, benches, 0 to 2 percent slopes	0.18	0.1%	Green	lw	96	95	98
<b>Weighted Average</b>						<b>76.9</b>	<b>78.5</b>	<b>*n 79.6</b>

\*\*IA has updated the CSR values for each county to CSR2.

\*n: The aggregation method is "Weighted Average using all components"

\*c: Using Capabilities Class Dominant Condition Aggregation Method

Soils data provided by USDA and NRCS.