

# Soils Map

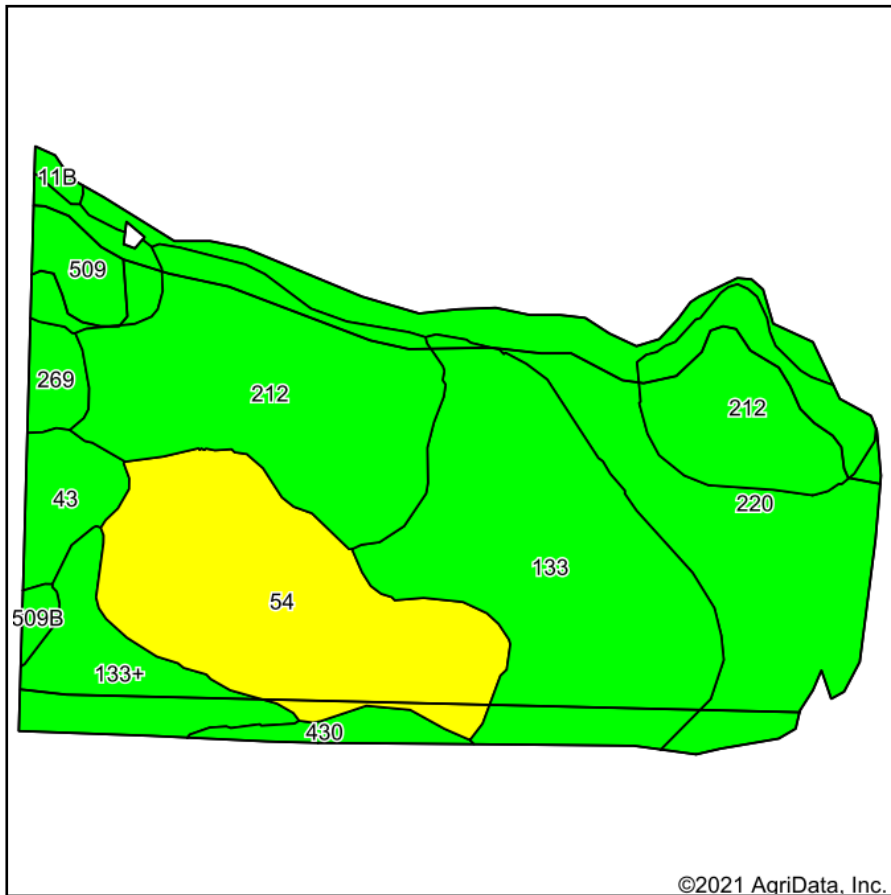

Soils data provided by USDA and NRCS.

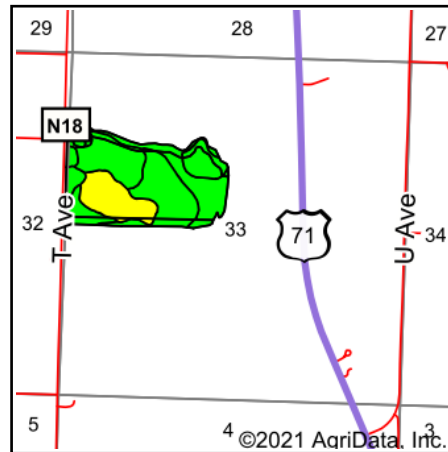

State: **Iowa**  
 County: **Montgomery**  
 Location: **33-72N-36W**  
 Township: **Washington**  
 Acres: **75.1**  
 Date: **9/2/2021**



Maps Provided By:



© AgriData, Inc. 2021

www.AgriDataInc.com



Area Symbol: IA137, Soil Area Version: 28

Code	Soil Description	Acres	Percent of field	CSR2 Legend	Non-Irr Class *c	CSR2**	CSR	*n NCCPI Overall
212	Kennebec silt loam, 0 to 2 percent slopes, occasionally flooded	18.99	25.3%		Iw	91	86	95
133	Colo silty clay loam, deep loess, 0 to 2 percent slopes, occasionally flooded	16.17	21.5%		IIw	78	80	81
220	Nodaway silt loam, 0 to 2 percent slopes, occasionally flooded	14.01	18.7%		IIw	82	85	96
54	Zook silty clay loam, 0 to 2 percent slopes, occasionally flooded	13.47	17.9%		IIw	67	70	63
133+	Colo silt loam, deep loess, 0 to 2 percent slopes, overwash, occasionally flooded	4.56	6.1%		IIw	78	85	85
509	Marshall silty clay loam, terrace, 0 to 2 percent slopes	2.72	3.6%		Ie	99	90	97
43	Bremer silty clay loam, 0 to 2 percent slopes, occasionally flooded	2.18	2.9%		IIw	74	80	85
430	Ackmore silt loam, 0 to 2 percent slopes, occasionally flooded	1.18	1.6%		IIw	77	83	90
269	Humeston silt loam, 0 to 2 percent slopes	1.14	1.5%		IIIw	72	58	80
509B	Marshall silty clay loam, terrace, 2 to 5 percent slopes	0.41	0.5%		Ile	94	85	96
11B	Ackmore-Colo-Judson complex, 2 to 5 percent slopes	0.27	0.4%		IIw	79	68	86
<b>Weighted Average</b>						<b>80.7</b>	<b>81</b>	<b>*n 85.3</b>

\*\*IA has updated the CSR values for each county to CSR2.

\*n: The aggregation method is "Weighted Average using all components"

\*c: Using Capabilities Class Dominant Condition Aggregation Method

Soils data provided by USDA and NRCS.