

# Soils Map - Tract #1

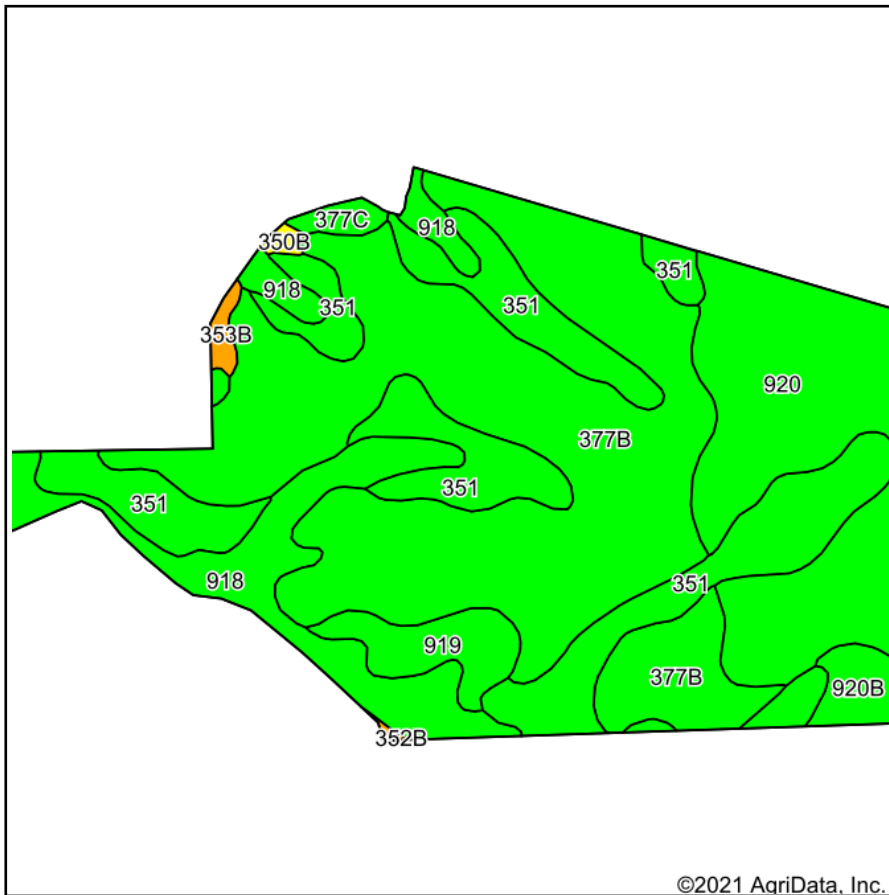

Soils data provided by USDA and NRCS.

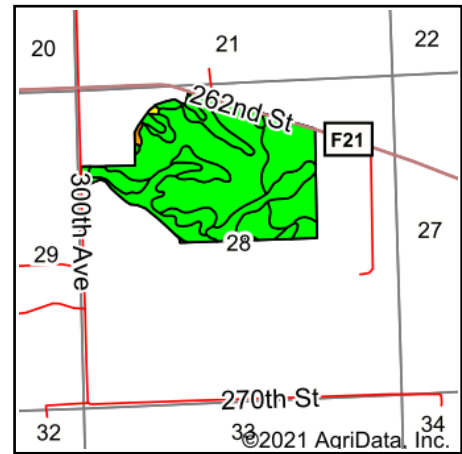

State: **Iowa**  
 County: **Clinton**  
 Location: **28-81N-4E**  
 Township: **De Witt**  
 Acres: **156.53**  
 Date: **6/15/2021**



Maps Provided By:



© AgriData, Inc. 2021

www.AgriDataInc.com



Area Symbol: IA045, Soil Area Version: 26

Code	Soil Description	Acres	Percent of field	CSR2 Legend	Non-Irr Class *c	*i Corn	*i Alfalfa	*i Soybeans	CSR2**	*n NCCPI Corn	*n NCCPI Soybeans
377B	Dinsdale silt loam, 2 to 5 percent slopes	68.99	44.1%		Ile	232	6.5	67.3	95	89	76
351	Atterberry silt loam, sandy substratum, 0 to 2 percent slopes	33.85	21.6%		Iw	224	5.8	65	78	95	97
920	Tama silt loam, sandy substratum, 0 to 2 percent slopes	27.37	17.5%		I	240	6.7	69.6	97	94	78
918	Garwin silty clay loam, sandy substratum, 0 to 2 percent slopes	16.20	10.3%		IIw	80	1.7	23.2	84	95	90
919	Muscatine silt loam, sandy substratum, 0 to 2 percent slopes	4.89	3.1%		Iw	240	6.2	69.6	100	97	94
920B	Tama silt loam, sandy substratum, 2 to 5 percent slopes	2.76	1.8%		Ile	232	6.5	67.3	92	97	79
377C	Dinsdale silt loam, 5 to 9 percent slopes	1.15	0.7%		IIIle	216	6	62.6	88	87	73
353B	Tell silt loam, 2 to 5 percent slopes	0.90	0.6%		Ile	80	2.2	23.2	44	87	66
350B	Waukegan silt loam, 2 to 5 percent slopes	0.42	0.3%		Ile	80	2.2	23.2	55	81	50
<b>Weighted Average</b>						<b>214.8</b>	<b>5.8</b>	<b>62.3</b>	<b>90.2</b>	<b>*n 92.1</b>	<b>*n 82.8</b>

\*\*IA has updated the CSR values for each county to CSR2.

\*i Yield data provided by the ISPAID Database version 8.1.1 developed by IA State University.

\*n: The aggregation method is "Weighted Average using all components"

\*c: Using Capabilities Class Dominant Condition Aggregation Method

Soils data provided by USDA and NRCS.