

Soils Map

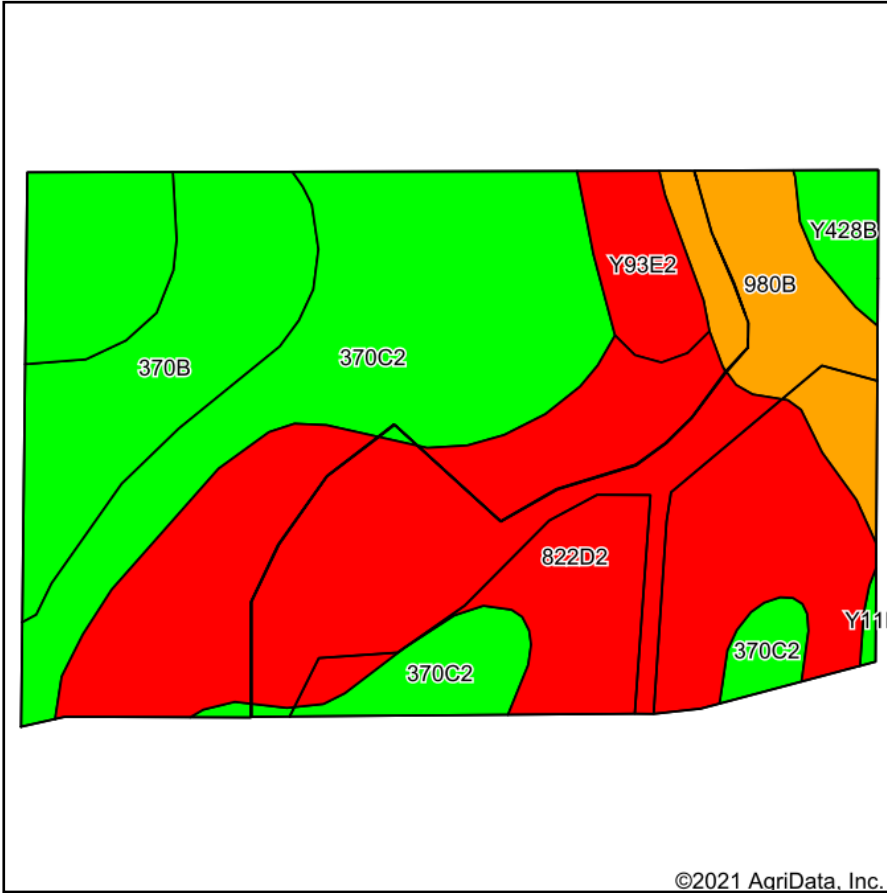

Soils data provided by USDA and NRCS.

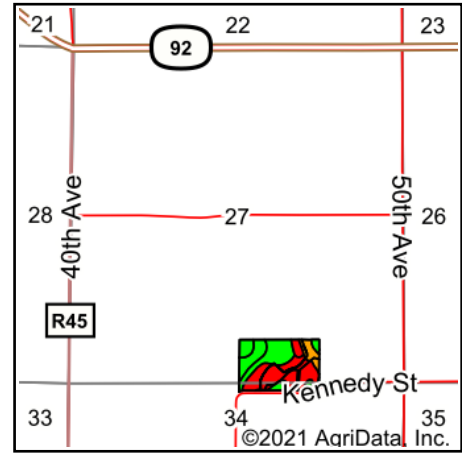

State: **Iowa**
 County: **Warren**
 Location: **27-76N-25W**
 Township: **Jefferson**
 Acres: **23.17**
 Date: **1/27/2021**



Maps Provided By:



Code	Soil Description	Acres	Percent of field	CSR2 Legend	Non-Irr Class *c	CSR2**	CSR
822D2	Lamoni silty clay loam, 9 to 14 percent slopes, eroded	9.74	42.0%			IVe	15
370C2	Sharpsburg silty clay loam, 5 to 9 percent slopes, eroded	7.45	32.2%			IIIe	67
370B	Sharpsburg silty clay loam, 2 to 5 percent slopes	2.76	11.9%			Ile	87
980B	Gullied land-Ely-Colo, occasionally flooded, complex, 2 to 5 percent slopes	1.92	8.3%			VIIe	25
Y93E2	Shelby-Adair clay loams, dissected till plain, 14 to 18 percent slopes, eroded	0.84	3.6%			IVe	28
Y428B	Ely silty clay loam, dissected till plain, 2 to 5 percent slopes	0.46	2.0%			Ile	88
Weighted Average						47	*-

**IA has updated the CSR values for each county to CSR2.

*- CSR weighted average cannot be calculated on the current soils data, use prior data version for csr values.

*c: Using Capabilities Class Dominant Condition Aggregation Method

Soils data provided by USDA and NRCS.