

Soils Map

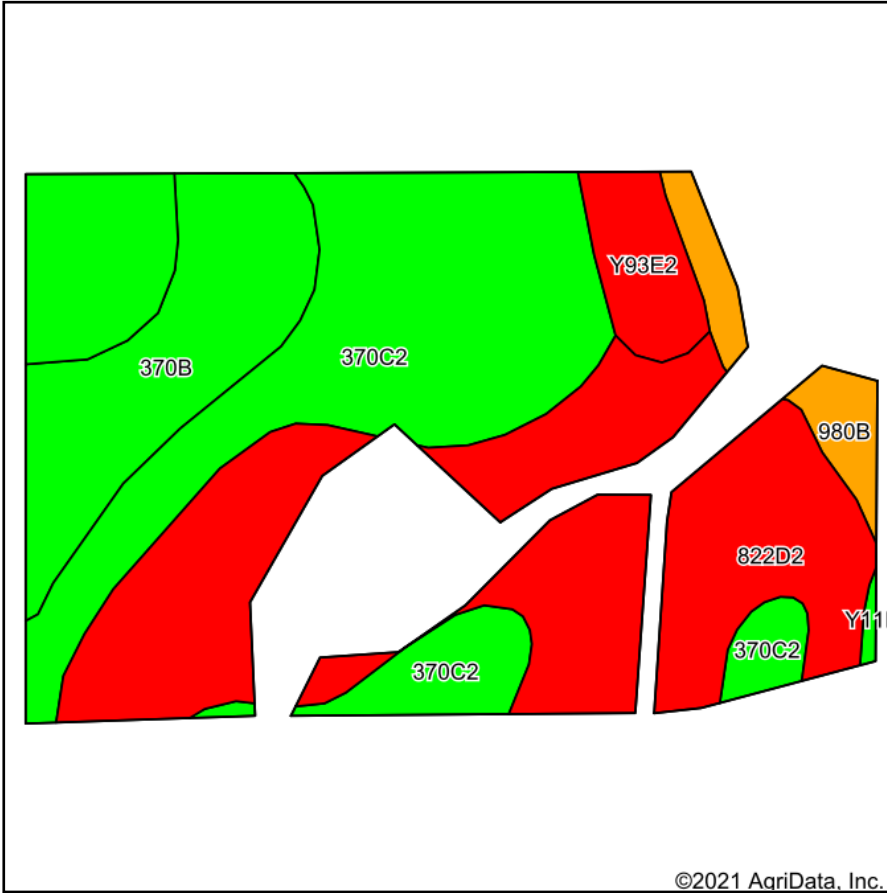

Soils data provided by USDA and NRCS.

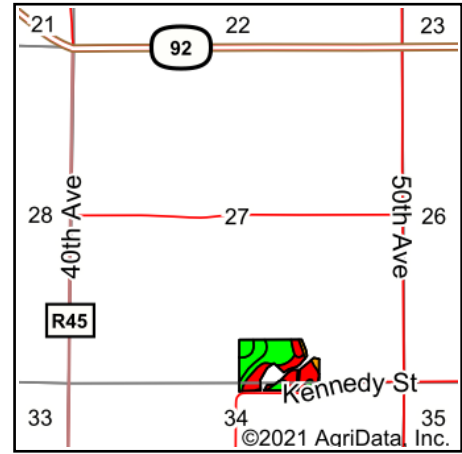

State: **Iowa**
 County: **Warren**
 Location: **27-76N-25W**
 Township: **Jefferson**
 Acres: **18.71**
 Date: **1/27/2021**



Maps Provided By:



© AgriData, Inc. 2021

www.AgriDataInc.com



Code	Soil Description	Acres	Percent of field	CSR2 Legend	Non-Irr Class *c	CSR2**	CSR
370C2	Sharpsburg silty clay loam, 5 to 9 percent slopes, eroded	7.47	39.9%		IIIe	80	67
822D2	Lamoni silty clay loam, 9 to 14 percent slopes, eroded	6.91	36.9%		IVe	10	15
370B	Sharpsburg silty clay loam, 2 to 5 percent slopes	2.75	14.7%		Ile	91	87
Y93E2	Shelby-Adair clay loams, dissected till plain, 14 to 18 percent slopes, eroded	0.83	4.4%		IVe	28	
980B	Gullied land-Ely-Colo, occasionally flooded, complex, 2 to 5 percent slopes	0.75	4.0%		VIIe	42	25
Weighted Average						51.9	*.

**IA has updated the CSR values for each county to CSR2.

*. CSR weighted average cannot be calculated on the current soils data, use prior data version for csr values.

*c: Using Capabilities Class Dominant Condition Aggregation Method

Soils data provided by USDA and NRCS.