

Soils Map

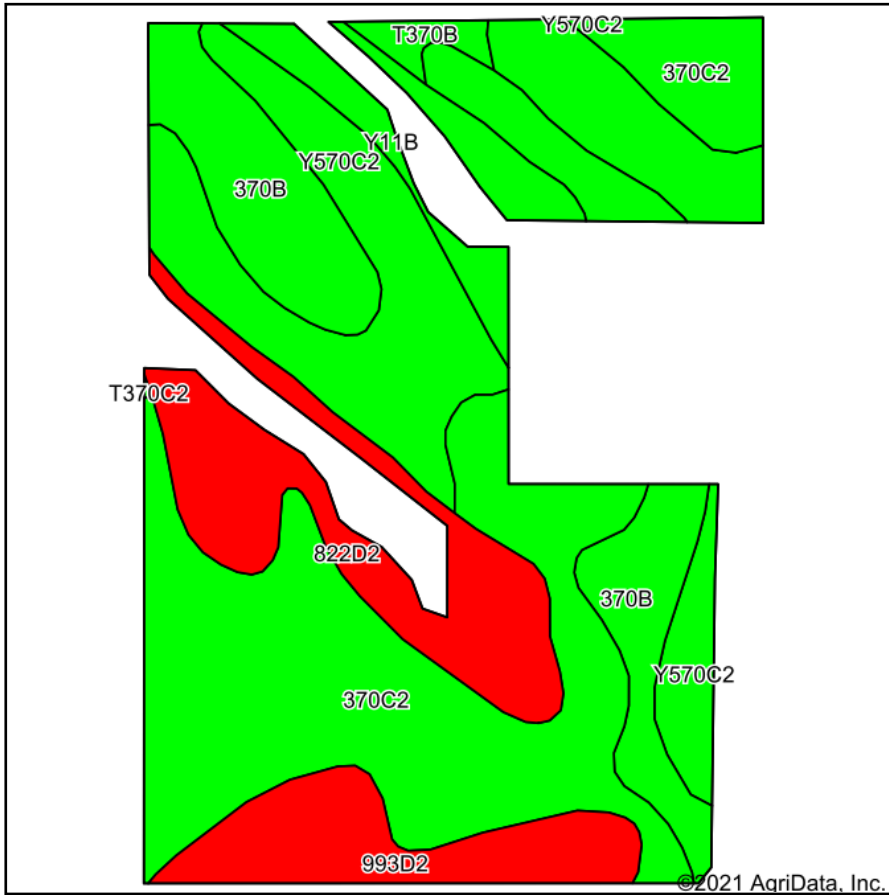

Soils data provided by USDA and NRCS.

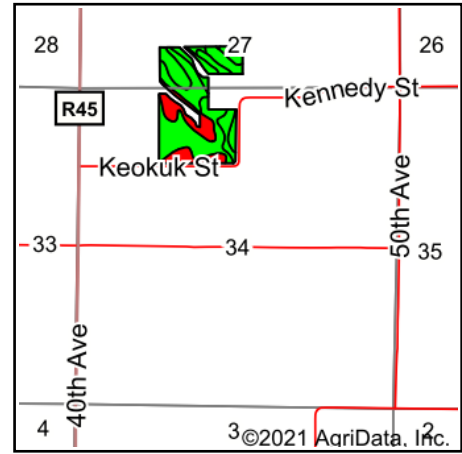

State: **Iowa**
 County: **Warren**
 Location: **34-76N-25W**
 Township: **Jefferson**
 Acres: **47.83**
 Date: **1/27/2021**



Maps Provided By:



© AgriData, Inc. 2021

www.AgriDataInc.com



Code	Soil Description	Acres	Percent of field	CSR2 Legend	Non-Irr Class *c	CSR2**	CSR
370C2	Sharpsburg silty clay loam, 5 to 9 percent slopes, eroded	17.71	37.0%		IIIe	80	67
370B	Sharpsburg silty clay loam, 2 to 5 percent slopes	9.10	19.0%		Ile	91	87
Y570C2	Nira silty clay loam, dissected till plain, 5 to 9 percent slopes, eroded	8.22	17.2%		IIIe	81	
822D2	Lamoni silty clay loam, 9 to 14 percent slopes, eroded	6.01	12.6%		IVe	10	15
993D2	Armstrong-Gara loams, 9 to 14 percent slopes, moderately eroded	3.76	7.9%		IVe	23	20
Y11B	Colo, occasionally flooded-Ely silty clay loams, dissected till plain, 2 to 5 percent slopes	2.50	5.2%		IIw	80	
T370B	Sharpsburg silty clay loam, terrace, 2 to 5 percent slopes	0.53	1.1%		Ile	91	87
Weighted Average						69.1	*-

**IA has updated the CSR values for each county to CSR2.

*- CSR weighted average cannot be calculated on the current soils data, use prior data version for csr values.

*c: Using Capabilities Class Dominant Condition Aggregation Method

Soils data provided by USDA and NRCS.