

# Total Soils Map

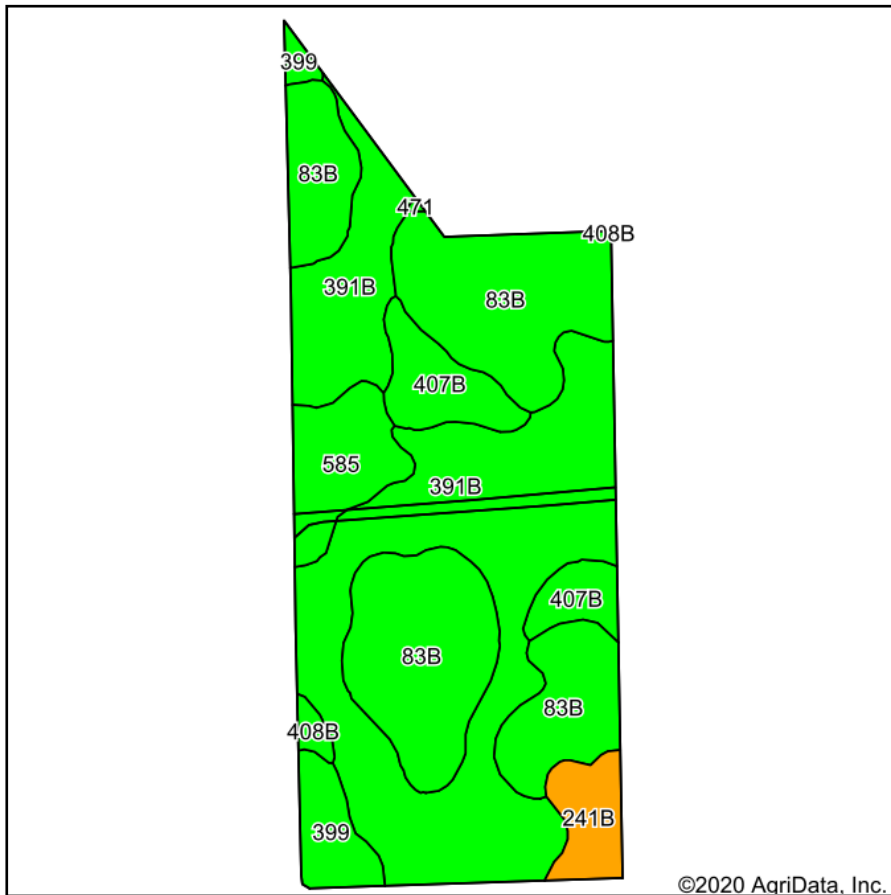

Soils data provided by USDA and NRCS.

©2020 AgriData, Inc.

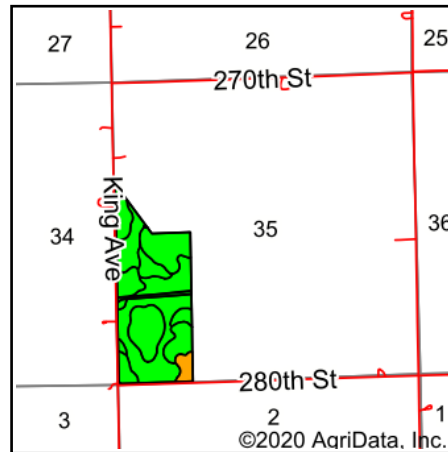

State: **Iowa**  
 County: **Buchanan**  
 Location: **35-88N-9W**  
 Township: **Sumner**  
 Acres: **84.24**  
 Date: **7/22/2020**



Maps Provided By:



© AgriData, Inc. 2020

www.AgriDataInc.com



Area Symbol: IA019. Soil Area Version: 25								
Code	Soil Description	Acres	Percent of field	CSR2 Legend	Non-Irr Class *c	Irr Class *c	CSR2**	*n NCCPI Overall
391B	Clyde-Floyd complex, 1 to 4 percent slopes	36.40	43.2%		IIw		87	88
83B	Kenyon loam, 2 to 5 percent slopes	30.38	36.1%		IIe		90	84
407B	Schley loam, 1 to 4 percent slopes	5.63	6.7%		IIw		81	84
585	Spillville-Coland complex, 0 to 2 percent slopes	4.96	5.9%		IIw		76	94
399	Readlyn silt loam, 1 to 3 percent slopes	3.33	4.0%		Iw		91	76
241B	Burkhardt-Saude complex, 2 to 5 percent slopes	2.97	3.5%		IVe	IIe	33	55
408B	Olin fine sandy loam, 2 to 5 percent slopes	0.57	0.7%		IIe		74	77
<b>Weighted Average</b>							<b>85.2</b>	<b>*n 84.9</b>

\*\*IA has updated the CSR values for each county to CSR2.

\*n: The aggregation method is "Weighted Average using major components"

\*c: Using Capabilities Class Dominant Condition Aggregation Method

Soils data provided by USDA and NRCS.