

# Total Soils Map

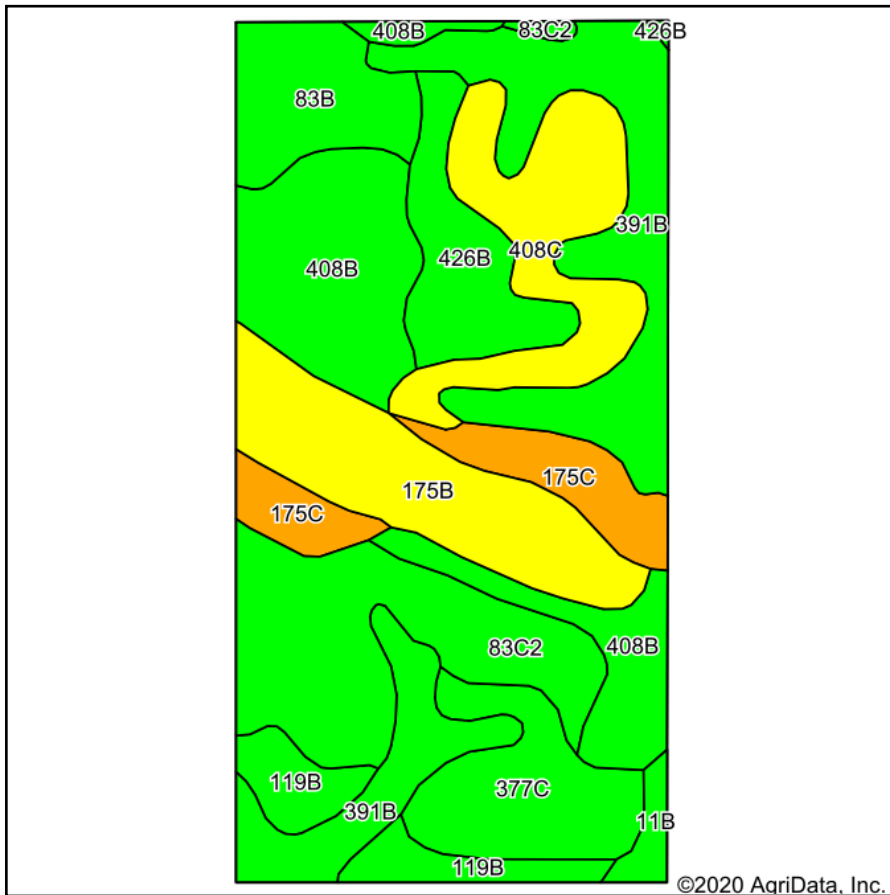

Soils data provided by USDA and NRCS.

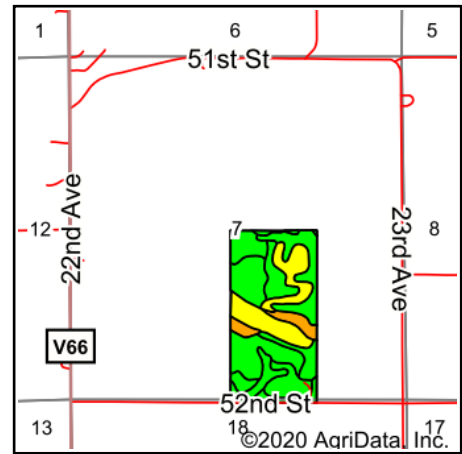

State: **Iowa**  
 County: **Benton**  
 Location: **7-86N-10W**  
 Township: **Cedar**  
 Acres: **80**  
 Date: **7/6/2020**



Maps Provided By:



Area Symbol: IA011. Soil Area Version: 22								
Code	Soil Description	Acres	Percent of field	CSR2 Legend	Non-Irr Class *c	CSR2**	CSR	
391B	Clyde-Floyd complex, 1 to 4 percent slopes	14.53	18.2%		IIw	87	74	
408B	Olin fine sandy loam, 2 to 5 percent slopes	12.39	15.5%		IIe	73	70	
83C2	Kenyon loam, 5 to 9 percent slopes, eroded	10.91	13.6%		IIIe	84	70	
175B	Dickinson fine sandy loam, 2 to 5 percent slopes	8.87	11.1%		IIIe	50	55	
408C	Olin fine sandy loam, 5 to 9 percent slopes	7.97	10.0%		IIIe	68	65	
377C	Dinsdale silty clay loam, 5 to 9 percent slopes	6.06	7.6%		IIIe	90	75	
426B	Aredale loam, 2 to 5 percent slopes	5.02	6.3%		IIe	91	85	
175C	Dickinson fine sandy loam, 5 to 9 percent slopes	4.91	6.1%		IIIe	45	40	
83B	Kenyon loam, 2 to 5 percent slopes	4.90	6.1%		IIe	90	87	
119B	Muscatine silty clay loam, 2 to 5 percent slopes	3.57	4.5%		IIe	95	95	
11B	Colo-Ely complex, 0 to 5 percent slopes	0.87	1.1%		IIw	86	68	
<b>Weighted Average</b>						<b>76.9</b>	<b>70.2</b>	

\*\*IA has updated the CSR values for each county to CSR2.

\*c: Using Capabilities Class Dominant Condition Aggregation Method  
 Soils data provided by USDA and NRCS.