

# Soils Map

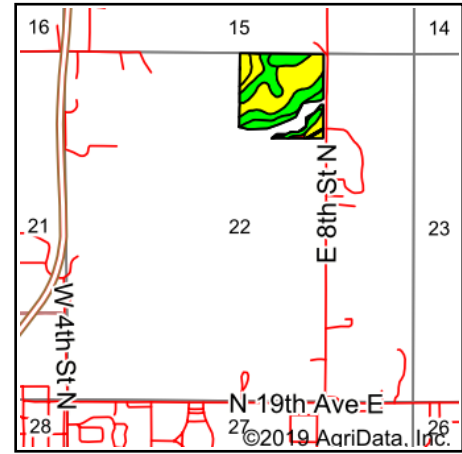

State: **Iowa**  
 County: **Jasper**  
 Location: **22-80N-19W**  
 Township: **Newton**  
 Acres: **31.72**  
 Date: **4/28/2019**

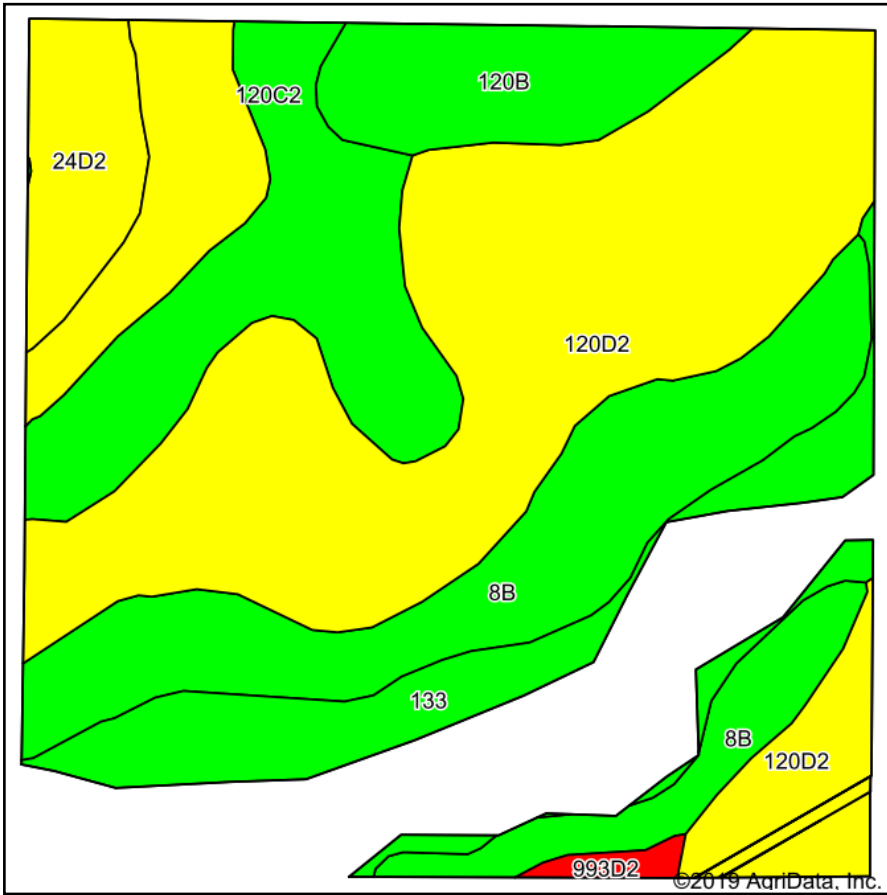

Area Symbol: IA099, Soil Area Version: 23

Code	Soil Description	Acres	Percent of field	CSR2 Legend	CSR2**	CSR
120D2	Tama silty clay loam, 9 to 14 percent slopes, eroded	14.35	45.2%	Yellow	62	66
8B	Judson silty clay loam, 2 to 5 percent slopes	6.39	20.1%	Green	93	90
120C2	Tama silty clay loam, 5 to 9 percent slopes, eroded	4.11	13.0%	Light Green	87	76
133	Colo silty clay loam, 0 to 2 percent slopes, occasionally flooded	2.95	9.3%	Light Green	78	80
120B	Tama silty clay loam, 2 to 5 percent slopes	2.16	6.8%	Light Green	95	93
24D2	Shelby loam, 9 to 14 percent slopes, moderately eroded	1.56	4.9%	Yellow	52	48
993D2	Gara-Armstrong loams, 9 to 14 percent slopes, moderately eroded	0.20	0.6%	Red	26	20
<b>Weighted Average</b>					<b>74.5</b>	<b>74.1</b>

\*\*IA has updated the CSR values for each county to CSR2.

\*c: Using Capabilities Class Dominant Condition Aggregation Method

Soils data provided by USDA and NRCS.