

# Soils Map-CSR2

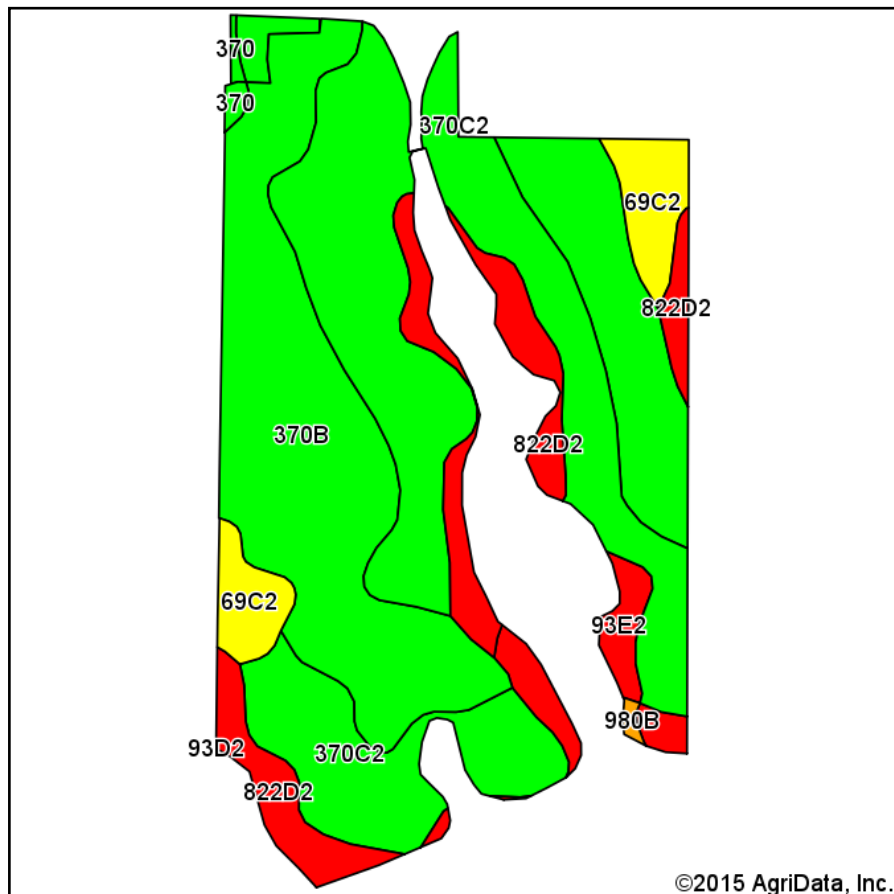

Soils data provided by USDA and NRCS.

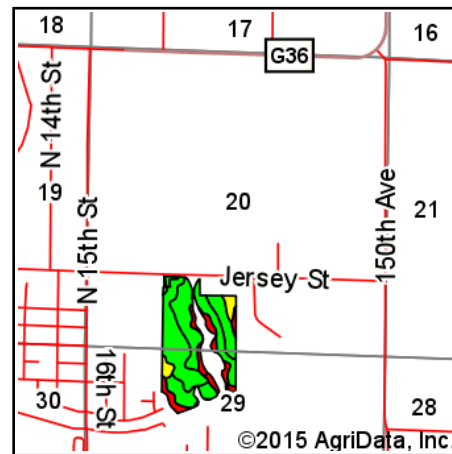

State: **Iowa**  
 County: **Warren**  
 Location: **20-76N-23W**  
 Township: **Lincoln**  
 Acres: **52.29**  
 Date: **1/22/2016**



Maps Provided By:



Area Symbol: IA181, Soil Area Version: 20

Code	Soil Description	Acres	Percent of field	CSR2 Legend	Non-Irr Class *c	CSR2**	CSR
370C2	Sharpsburg silty clay loam, 5 to 9 percent slopes, eroded	21.19	40.5%		IIIe	80	67
370B	Sharpsburg silty clay loam, 2 to 5 percent slopes	20.41	39.0%		Ile	90	87
822D2	Lamoni silty clay loam, 9 to 14 percent slopes, moderately eroded	5.53	10.6%		IVe	11	15
69C2	Clearfield silty clay loam, 5 to 9 percent slopes, moderately eroded	2.84	5.4%		IIIw	66	45
93E2	Adair-Shelby clay loams, 14 to 18 percent slopes, moderately eroded	1.62	3.1%		VIe	19	10
185D2	Bauer silt loam, 9 to 14 percent slopes, moderately eroded	0.34	0.7%		VIe	15	20
370	Sharpsburg silty clay loam, 0 to 2 percent slopes	0.25	0.5%		I	96	92
980B	Gullied land-Ely-Colo complex, 2 to 5 percent slopes	0.11	0.2%		VIIe	42	25
Weighted Average						73.5	66.1

Area Symbol: IA181, Soil Area Version: 20

\*\*IA has updated the CSR values for each county to CSR2.

\*c: Using Capabilities Class Dominant Condition Aggregation Method

Soils data provided by USDA and NRCS.