

# Total Soils Map

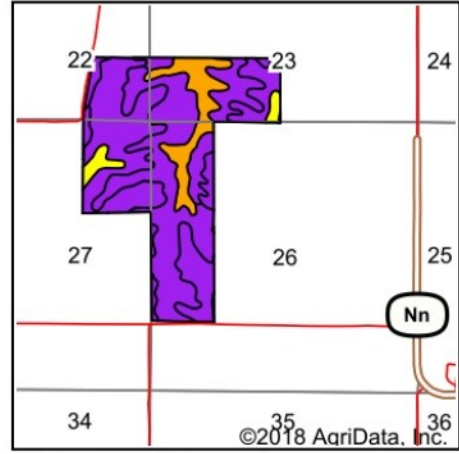

State: **Missouri**  
 County: **Putnam**  
 Location: **26-66N-22W**  
 Township: **York**  
 Acres: **275.9**  
 Date: **8/21/2018**

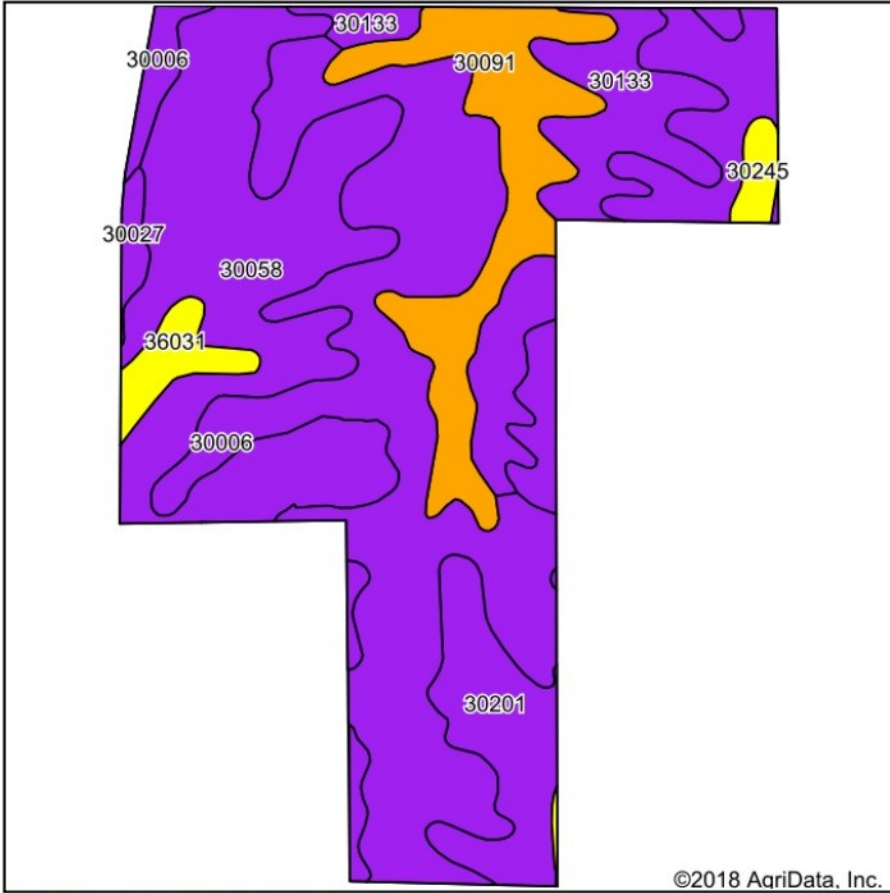

**Area Symbol: MO171, Soil Area Version: 18**

Code	Soil Description	Acres	Percent of field	NCCPI Overall Legend	NCCPI Overall	NCCPI Soybeans
30006	Adair loam, 3 to 9 percent slopes, eroded	92.50	33.5%		56	44
30058	Gara loam, 14 to 18 percent slopes, moderately eroded	70.42	25.5%		56	40
30201	Shelby loam, 9 to 14 percent slopes, moderately eroded	40.65	14.7%		58	51
30091	Grundy silty clay loam, 2 to 5 percent slopes, moderately eroded	31.16	11.3%		76	67
30133	Lamoni clay loam, 5 to 9 percent slopes, moderately eroded	29.78	10.8%		57	50
36031	Nodaway silt loam, 0 to 2 percent slopes, frequently flooded	5.81	2.1%		63	52
30245	Vigar-Zook-Nodaway complex, 2 to 5 percent slopes	3.23	1.2%		66	55
30027	Armstrong clay loam, 5 to 9 percent slopes, moderately eroded	2.35	0.9%		53	39
<b>Weighted Average</b>					<b>58.9</b>	<b>47.5</b>

Soils data provided by USDA and NRCS.