

Total Soils Map

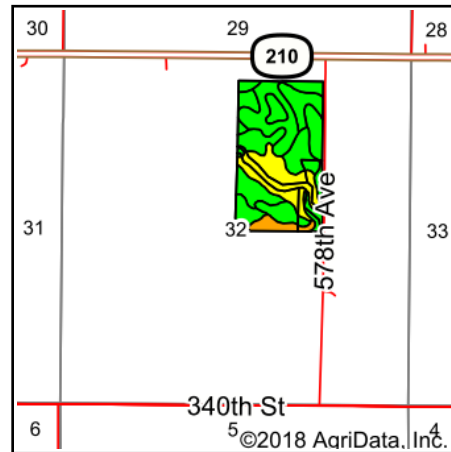

State: **Iowa**
 County: **Story**
 Location: **32-82N-23W**
 Township: **Union**
 Acres: **68**
 Date: **3/22/2018**

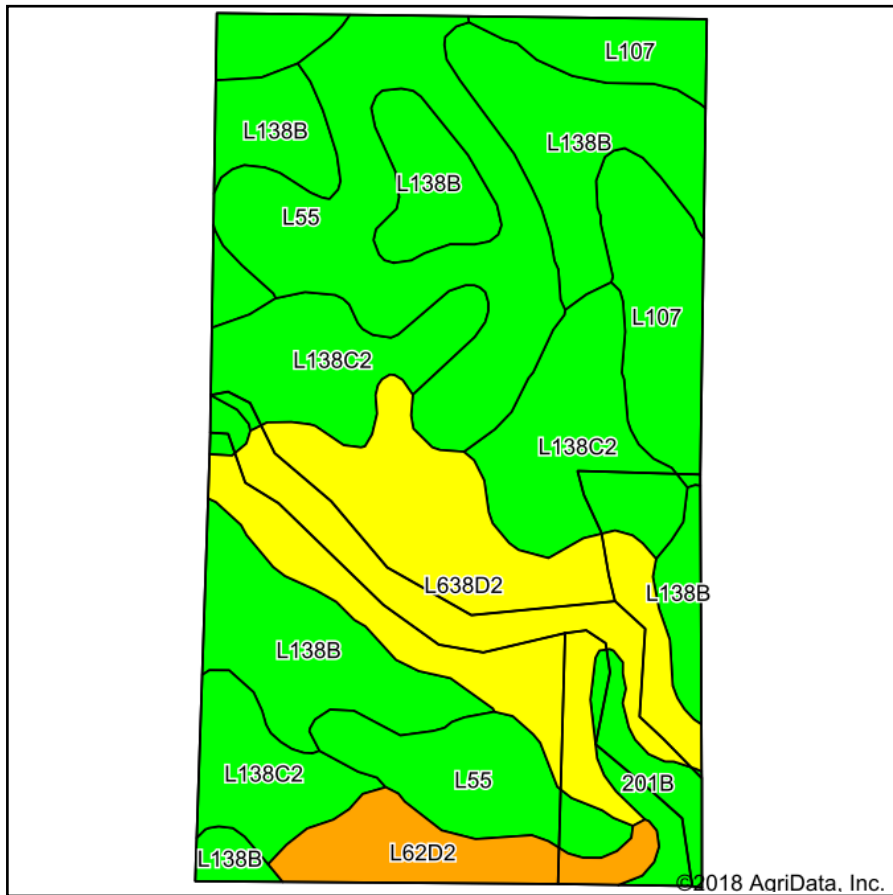
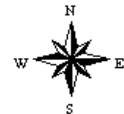

Soils data provided by USDA and NRCS.

Area Symbol: IA169, Soil Area Version: 28

Code	Soil Description	Acres	Percent of field	CSR2 Legend	Non-Irr Class *c	CSR2**	CSR	NCCPI Overall
L138B	Clarion loam, Bemis moraine, 2 to 6 percent slopes	15.88	23.4%	Green	Ile	88		77
L55	Nicollet loam, 1 to 3 percent slopes	13.85	20.4%	Green	Ie	91		82
L638D2	Omsrud-Storden complex, Bemis moraine, 10 to 16 percent slopes, moderately eroded	13.82	20.3%	Yellow	IVe	53		62
L138C2	Clarion loam, Bemis moraine, 6 to 10 percent slopes, moderately eroded	12.17	17.9%	Green	IIIe	83		61
L107	Webster clay loam, Bemis moraine, 0 to 2 percent slopes	7.16	10.5%	Green	IIw	88		80
L62D2	Storden loam, Bemis moraine, 10 to 16 percent slopes, moderately eroded	3.20	4.7%	Orange	IVe	41		60
201B	Coland-Terril complex, 1 to 5 percent slopes	1.92	2.8%	Green	IIw	76	40	91
Weighted Average						78.1	*	72

**IA has updated the CSR values for each county to CSR2.

*- CSR weighted average cannot be calculated on the current soils data, use prior data version for csr values.

*c: Using Capabilities Class Dominant Condition Aggregation Method

Soils data provided by USDA and NRCS.