

# Soils Map

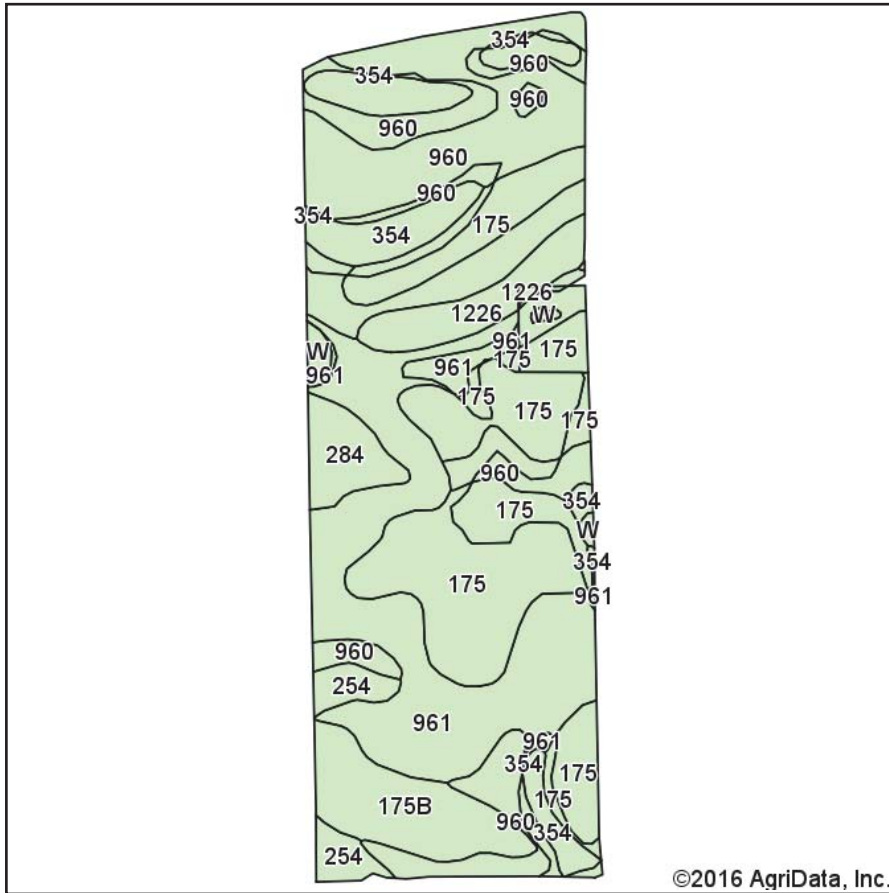

Soils data provided by USDA and NRCS.

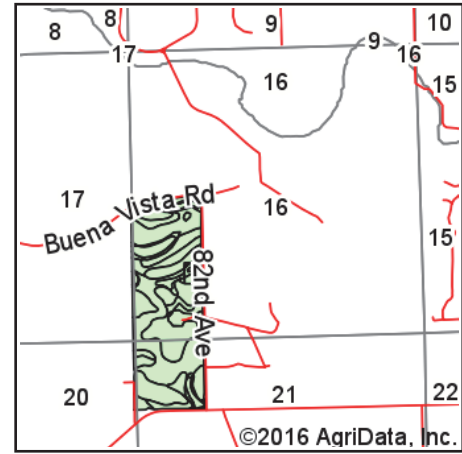

State: **Iowa**  
 County: **Scott**  
 Location: **16-80N-2E**  
 Township: **Allens Grove**  
 Acres: **113.41**  
 Date: **3/23/2016**

**TOTAL**  
 REALTY CO.  
 A SUBSIDIARY OF PEOPLES COMPANY

Maps Provided By:



© AgriData, Inc. 2016

www.AgriDataInc.com



**Area Symbol: IA163, Soil Area Version: 23**

| Code                    | Soil Description   | Acres | Percent of field | Non-Irr Class *c | CSR2**      | CSR         | *n NCCPI Overall |
|-------------------------|--|-------|------------------|------------------|-------------|-------------|------------------|
| 960                     | Shaffton loam, 0 to 2 percent slopes                     | 30.14 | 26.6%            | IIw              | 58          | 78          | 87               |
| 175                     | Dickinson fine sandy loam, 0 to 2 percent slopes         | 29.57 | 26.1%            | IIIs             | 55          | 60          | 59               |
| 961                     | Ambraw clay loam, 0 to 2 percent slopes                  | 26.14 | 23.0%            | IIw              | 73          | 47          | 92               |
| 354                     | Aquolls, ponded  | 8.77  | 7.7%             | VIIIw            | 5           | 5           | 0                |
| 175B                    | Dickinson fine sandy loam, 2 to 5 percent slopes         | 7.45  | 6.6%             | IIIe             | 50          | 55          | 59               |
| 1226                    | Lawler loam, 0 to 2 percent slopes, rarely flooded       | 4.48  | 4.0%             | IIs              | 59          | 66          | 86               |
| 284                     | Flagler sandy loam, 0 to 2 percent slopes                | 3.30  | 2.9%             | IIIs             | 56          | 50          | 61               |
| 254                     | Zook silty clay, sandy substratum, 0 to 2 percent slopes | 2.75  | 2.4%             | IIW              | 47          | 62          | 64               |
| W                       | Water  | 0.81  | 0.7%             |                  | 0           | 0           | 0                |
| <b>Weighted Average</b> |  |       |                  |                  | <b>55.4</b> | <b>56.8</b> | <b>*n 70.3</b>   |

Area Symbol: IA163, Soil Area Version: 23

\*\*IA has updated the CSR values for each county to CSR2.

\*n: NCCPI updated on 1-25-2016

\*c: Using Capabilities Class Dominant Condition Aggregation Method

Soils data provided by USDA and NRCS.