

Soils Map

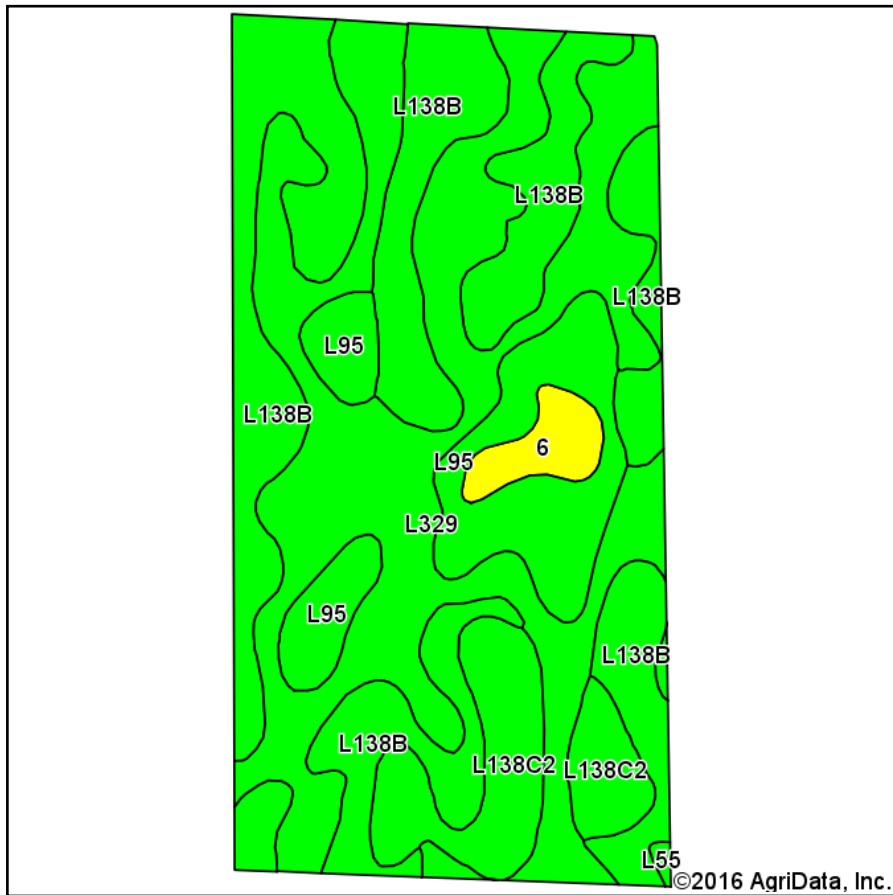

Soils data provided by USDA and NRCS.

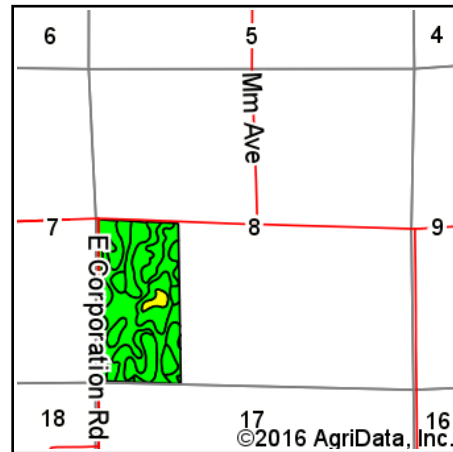

State: **Iowa**
 County: **Hardin**
 Location: **8-89N-20W**
 Township: **Hardin**
 Acres: **79.48**
 Date: **9/7/2016**

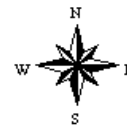

Area Symbol: IA083, Soil Area Version: 20

Code	Soil Description	Acres	Percent of field	CSR2 Legend	Non-Irr Class *c	CSR2**	CSR
L329	Webster-Nicollet complex, Bemis moraine, 0 to 3 percent slopes	30.47	38.3%		IIw	89	
L138B	Clarion loam, Bemis moraine, 2 to 6 percent slopes	29.88	37.6%		IIe	88	
L95	Harps clay loam, Bemis moraine, 0 to 2 percent slopes	9.95	12.5%		IIw	75	
L138C2	Clarion loam, Bemis moraine, 6 to 10 percent slopes, moderately eroded	7.19	9.0%		IIIe	83	
6	Okoboji silty clay loam, 0 to 1 percent slopes	1.85	2.3%		IIIw	59	59
L55	Nicollet loam, 1 to 3 percent slopes	0.14	0.2%		Ie	91	
Weighted Average						85.6	*

Area Symbol: IA083, Soil Area Version: 20

**IA has updated the CSR values for each county to CSR2.

*- CSR weighted average cannot be calculated on the current soils data, use prior data version for csr values.

*c: Using Capabilities Class Dominant Condition Aggregation Method

Soils data provided by USDA and NRCS.