

Soils Map-CSR2

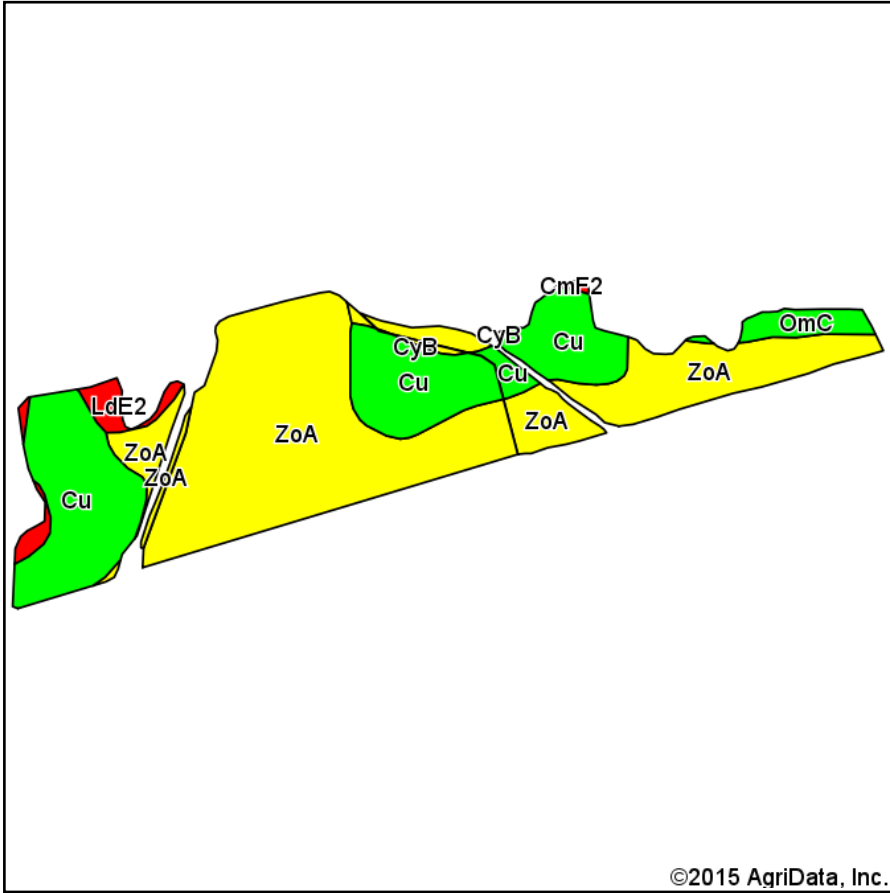

Soils data provided by USDA and NRCS.

©2015 AgriData, Inc.

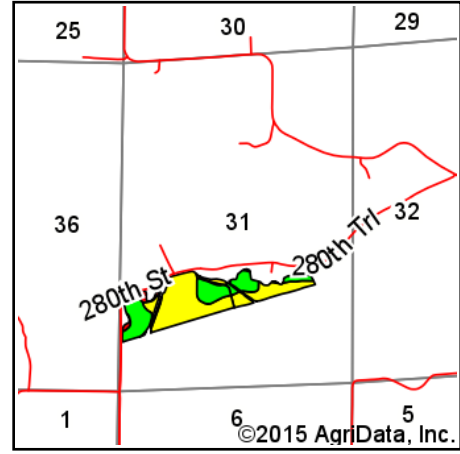

State: **Iowa**
 County: **Madison**
 Location: **31-75N-26W**
 Township: **South**
 Acres: **33.26**
 Date: **12/28/2015**



Maps Provided By:



© AgriData, Inc. 2015 www.AgriDataInc.com



Area Symbol: IA121, Soil Area Version: 19

Code	Soil Description	Acres	Percent of field	CSR2 Legend	Non-Irr Class *c	CSR2**	CSR
ZoA	Zook silty clay loam, 0 to 2 percent slopes	19.67	59.1%	Yellow	Ilw	65	70
Cu	Colo silty clay loam, deep loess, 0 to 2 percent slopes, occasionally flooded	10.96	33.0%	Green	Ilw	78	70
OmC	Olmitz loam, 5 to 9 percent slopes	0.97	2.9%	Light Green	Ille	85	57
LdE2	Lindley loam, 14 to 18 percent slopes, moderately eroded	0.94	2.8%	Red	Vle	29	28
CyB	Colo-Ely silty clay loams, gullied, 2 to 5 percent slopes	0.66	2.0%	Light Yellow	Vw	57	10
CmF2	Clanton-Gosport silt loams, 18 to 25 percent slopes, moderately eroded	0.06	0.2%	Red	Vlle	6	5
Weighted Average						68.6	67.1

Area Symbol: IA121, Soil Area Version: 19

**IA has updated the CSR values for each county to CSR2.

*c: Using Capabilities Class Dominant Condition Aggregation Method

Soils data provided by USDA and NRCS.