

# Soils Map

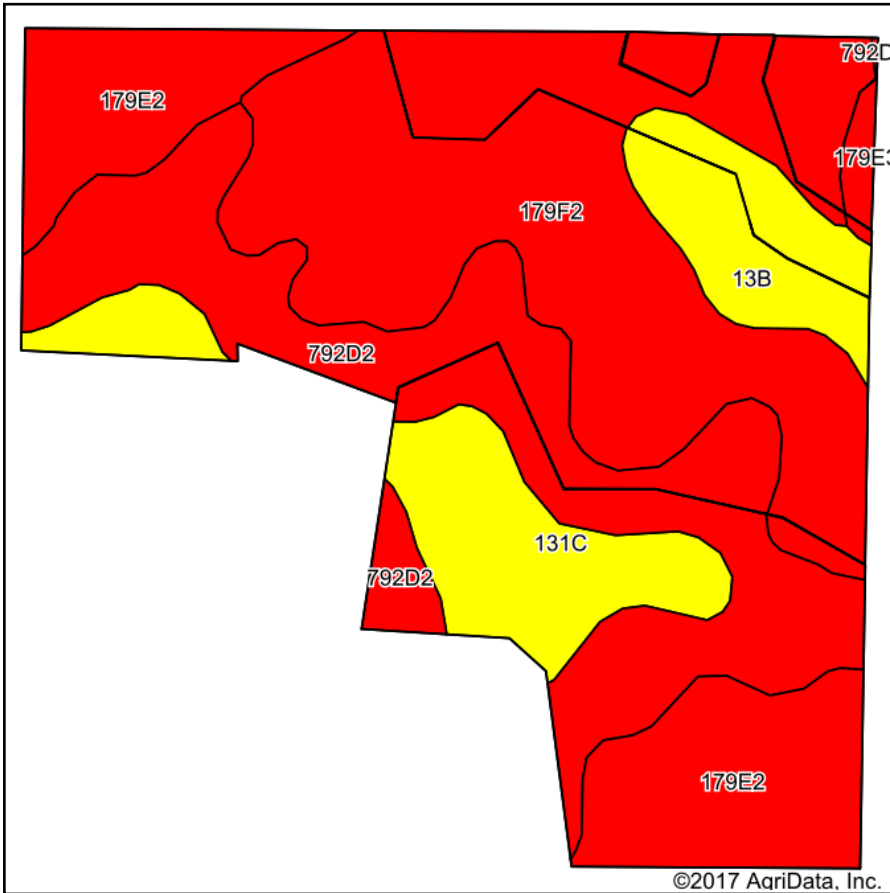

Soils data provided by USDA and NRCS.

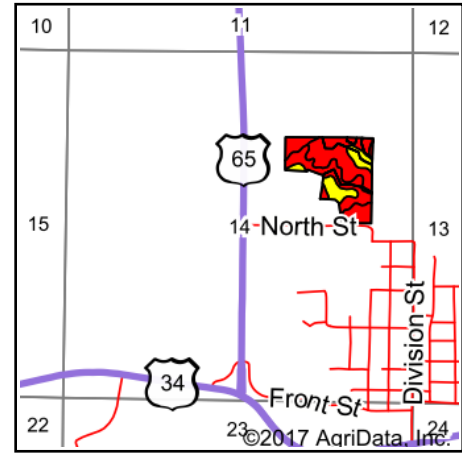

State: **Iowa**  
 County: **Lucas**  
 Location: **14-72N-23W**  
 Township: **Jackson**  
 Acres: **27.1**  
 Date: **10/11/2017**



Maps Provided By:



© AgriData, Inc. 2017

www.AgriDataInc.com



## Area Symbol: IA117, Soil Area Version: 24

Code	Soil Description	Acres	Percent of field	CSR2 Legend	Non-Irr Class *c	CSR2**	CSR	NCCPI Overall
179F2	Gara clay loam, 18 to 25 percent slopes, moderately eroded	10.04	37.0%		IVe	11	13	46
792D2	Armstrong clay loam, 9 to 14 percent slopes, moderately eroded	7.33	27.0%		IVe	5	13	50
179E2	Gara clay loam, 14 to 18 percent slopes, moderately eroded	4.56	16.8%		Vle	23	33	55
131C	Pershing silt loam, 5 to 9 percent slopes	3.04	11.2%		IIIe	65	49	70
13B	Zook-Olmitz-Vesser complex, 0 to 5 percent slopes	1.90	7.0%		IIw	68	53	79
179E3	Gara clay loam, 14 to 18 percent slopes, severely eroded	0.23	0.8%		Vle	27	30	45
<b>Weighted Average</b>						<b>21.6</b>	<b>23.4</b>	<b>53.6</b>

\*\*IA has updated the CSR values for each county to CSR2.

\*c: Using Capabilities Class Dominant Condition Aggregation Method

Soils data provided by USDA and NRCS.