

Soils Map

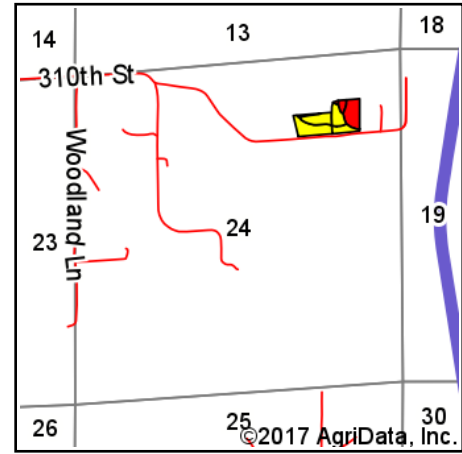

State: **Iowa**
 County: **Madison**
 Location: **24-74N-26W**
 Township: **Ohio**
 Acres: **9.83**
 Date: **6/22/2017**

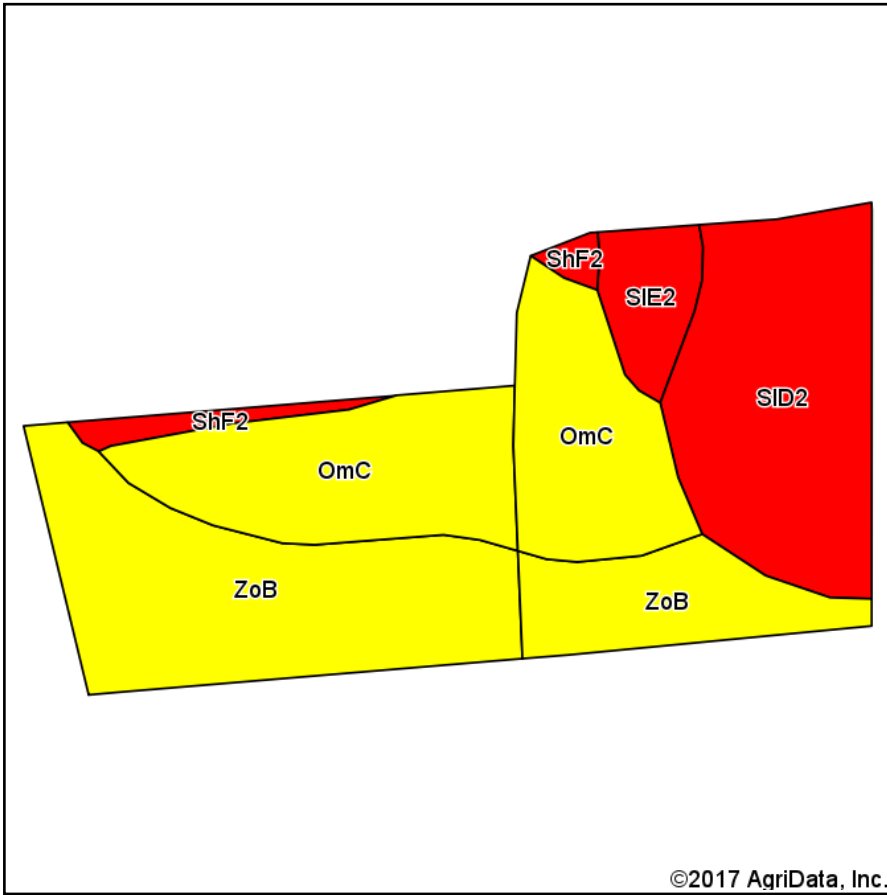

Maps Provided By:



© AgriData, Inc. 2017

www.AgriDataInc.com



Archived Soils Ending 1/21/2012

Code	Soil Description	Acres	Percent of field	CSR Legend	Non-Irr Class *c	CSR*
ZoB	Zook silty clay loam, 2 to 5 percent slopes	3.63	36.9%		IIw	65
OmC	Olmitz loam, 5 to 9 percent slopes	3.05	31.0%		IIIe	57
SID2	Shelby-Lamoni complex, 9 to 14 percent slopes, moderately erode	2.40	24.4%		IIIe	25
SIE2	Shelby-Lamoni complex, 14 to 18 percent slopes, moderately eroded	0.48	4.9%		VIe	10
ShF2	Shelby loam, 18 to 25 percent slopes, moderately eroded	0.27	2.7%		VIe	18
Weighted Average						48.8

*The CSR ratings are dated 1/21/2012 and will be available to aid in the transition to CSR2.

*c: Using Capabilities Class Dominant Condition Aggregation Method

Soils data provided by USDA and NRCS.