

Soils Map

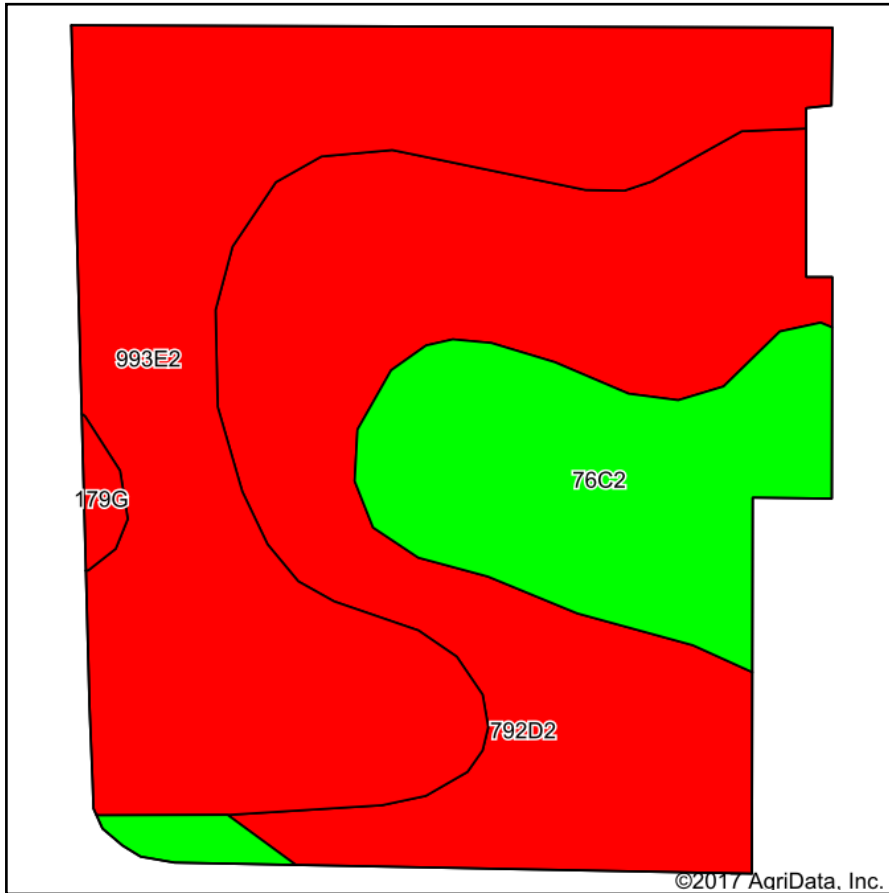

Soils data provided by USDA and NRCS.

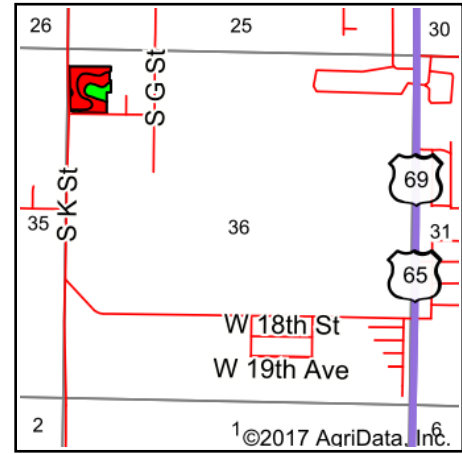

State: **Iowa**
 County: **Warren**
 Location: **36-76N-24W**
 Township: **Indianola**
 Acres: **9.57**
 Date: **12/27/2017**



© AgriData, Inc. 2017 www.AgriDataInc.com



Area Symbol: IA181, Soil Area Version: 22

Code	Soil Description	Acres	Percent of field	CSR2 Legend	Non-Irr Class *c	CSR2**	CSR	NCCPI Overall
993E2	Armstrong-Gara loams, 14 to 18 percent slopes, moderately eroded	3.94	41.2%		Vle	17	5	53
792D2	Armstrong loam, 9 to 14 percent slopes, moderately eroded	3.79	39.6%		IVe	7	13	57
76C2	Ladoga silt loam, dissected till plain, 5 to 9 percent slopes, eroded	1.77	18.5%		IIIe	75	65	65
179G	Gara loam, 25 to 40 percent slopes	0.07	0.7%		VIIe	5	5	20
Weighted Average						23.7	19.3	56.6

**IA has updated the CSR values for each county to CSR2.

*c: Using Capabilities Class Dominant Condition Aggregation Method

Soils data provided by USDA and NRCS.