

Soils Map

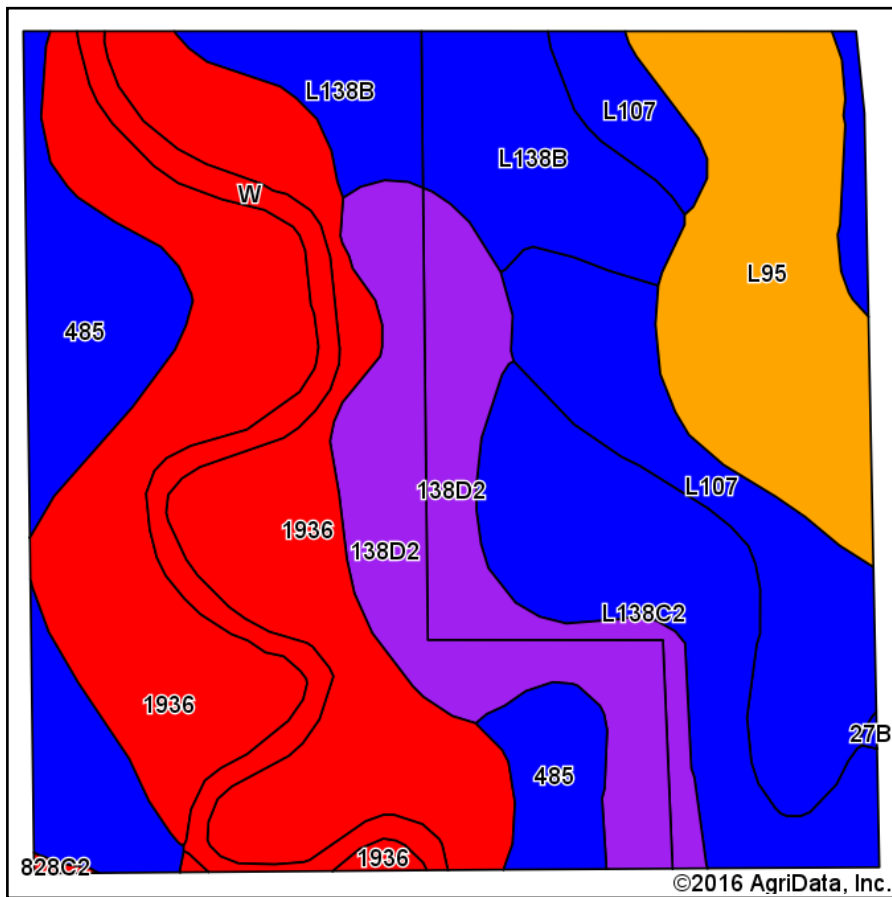

Soils data provided by USDA and NRCS.

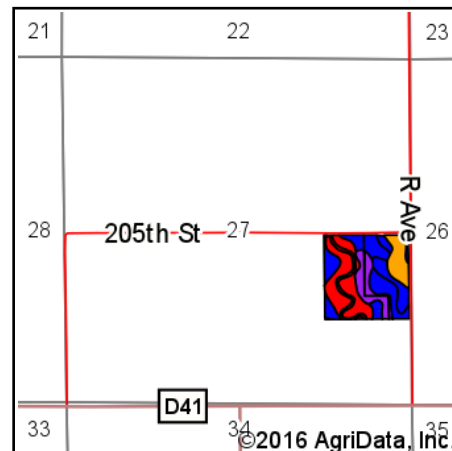

State: **Iowa**
 County: **Hardin**
 Location: **26-88N-20W**
 Township: **Jackson**
 Acres: **37.65**
 Date: **2/15/2016**



Maps Provided By:



Area Symbol: IA083, Soil Area Version: 20

Code	Soil Description	Acres	Percent of field	CSR2 Legend	Non-Irr Class *c	CSR2**	CSR
1936	Coland-Spillville-Hanlon complex, channeled, 0 to 2 percent slopes	10.51	27.9%		Vw	24	25
138D2	Clarion loam, 9 to 14 percent slopes, moderately eroded	5.27	14.0%		Ille	55	56
L95	Harps clay loam, Bemis moraine, 0 to 2 percent slopes	4.52	12.0%		Ilw	75	
L107	Webster clay loam, Bemis moraine, 0 to 2 percent slopes	4.38	11.6%		Ilw	88	
485	Spillville loam, 0 to 2 percent slopes	4.12	10.9%		Ilw	90	92
L138C2	Clarion loam, Bemis moraine, 6 to 10 percent slopes, moderately eroded	3.73	9.9%		Ille	83	
L138B	Clarion loam, Bemis moraine, 2 to 6 percent slopes	3.39	9.0%		Ile	88	
W	Water	1.73	4.6%			0	0
Weighted Average						59.6	*-

Area Symbol: IA083, Soil Area Version: 20

**IA has updated the CSR values for each county to CSR2.

*- CSR weighted average cannot be calculated on the current soils data, use prior data version for csr values.

*c: Using Capabilities Class Dominant Condition Aggregation Method

Soils data provided by USDA and NRCS.