

Soils Map

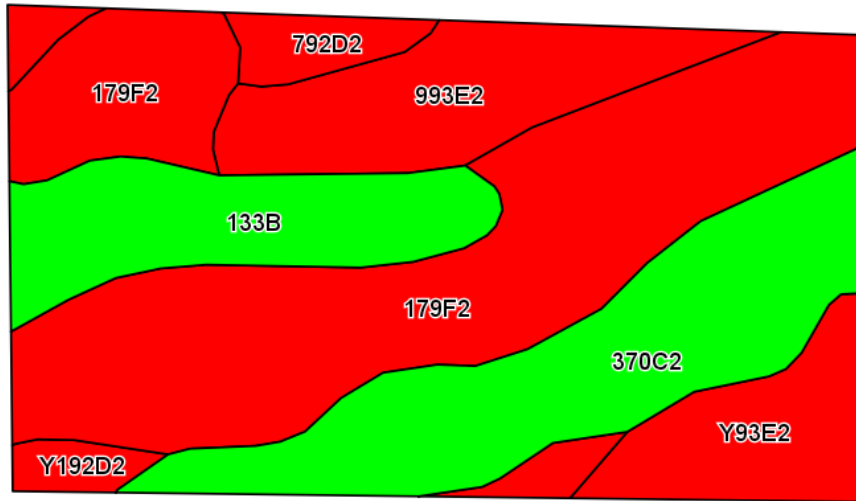

©2016 AgriData, Inc.

Soils data provided by USDA and NRCS.

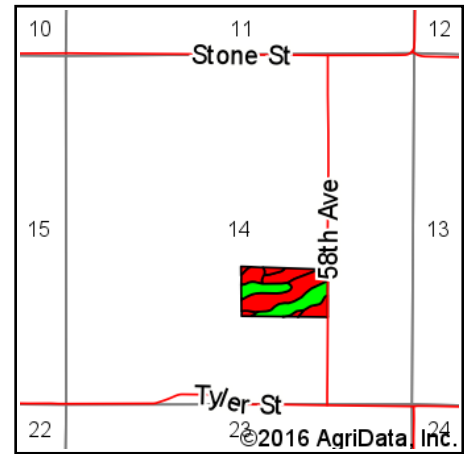

State: **Iowa**
 County: **Warren**
 Location: **14-74N-25W**
 Township: **Virginia**
 Acres: **22.5**
 Date: **1/3/2017**



Maps Provided By:



Area Symbol: IA181, Soil Area Version: 21

Code	Soil Description	Acres	Percent of field	CSR2 Legend	Non-Irr Class *c	CSR2**	CSR	NCCPI Overall
179F2	Gara loam, 18 to 25 percent slopes, moderately eroded	9.24	41.1%		Vlle	17	13	51
370C2	Sharpsburg silty clay loam, 5 to 9 percent slopes, eroded	4.65	20.7%		IIle	80	67	71
133B	Colo silty clay loam, dissected till plain, 2 to 5 percent slopes, occasionally flooded	2.73	12.1%		IIlw	74	75	96
993E2	Armstrong-Gara loams, 14 to 18 percent slopes, moderately eroded	2.68	11.9%		Vle	17	5	57
Y93E2	Shelby-Adair clay loams, dissected till plain, 14 to 18 percent slopes, eroded	1.77	7.9%		IVe	30		54
792D2	Armstrong loam, 9 to 14 percent slopes, moderately eroded	0.79	3.5%		IVe	7	13	58
Y192D2	Adair clay loam, dissected till plain, 9 to 14 percent slopes, eroded	0.64	2.8%		IVe	29		53
Weighted Average						37.9	*-	61.8

Area Symbol: IA181, Soil Area Version: 21

**IA has updated the CSR values for each county to CSR2.

*- CSR weighted average cannot be calculated on the current soils data, use prior data version for csr values.

*c: Using Capabilities Class Dominant Condition Aggregation Method

Soils data provided by USDA and NRCS.