

# Soils Map-CSR2

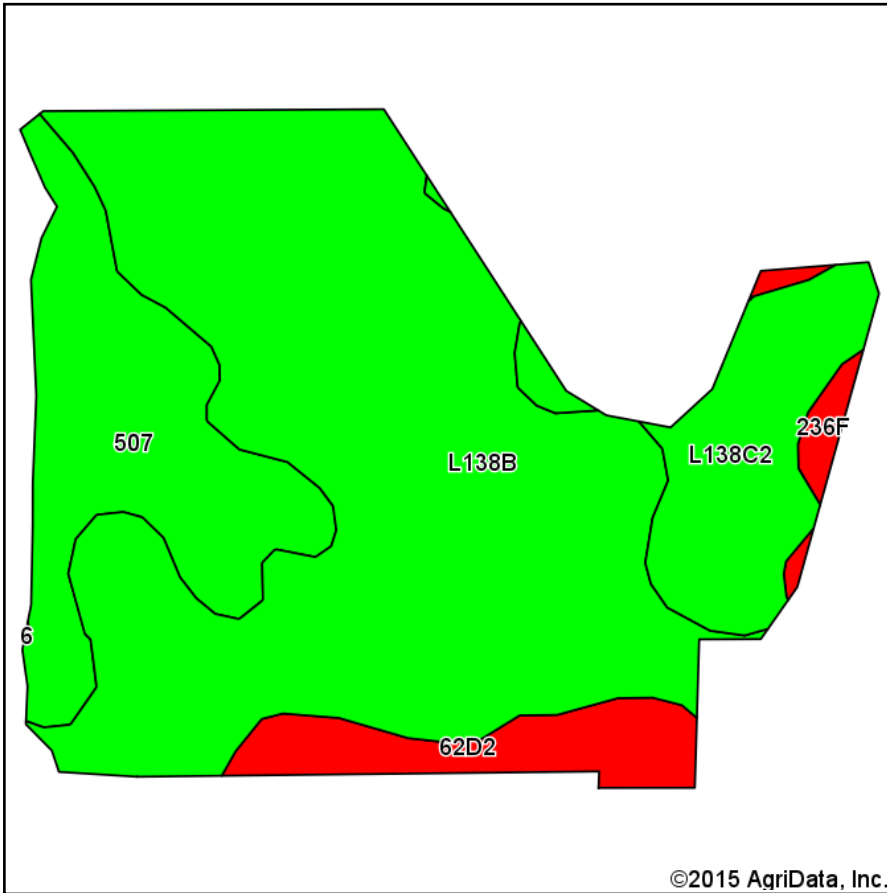

Soils data provided by USDA and NRCS.

©2015 AgriData, Inc.

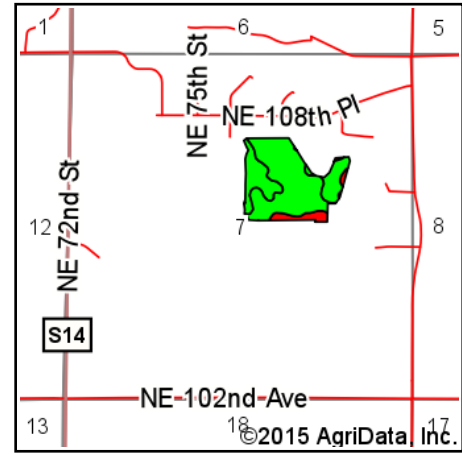

State: **Iowa**  
 County: **Polk**  
 Location: **7-80N-22W**  
 Township: **Franklin**  
 Acres: **34.26**  
 Date: **9/21/2015**



Maps Provided By:



## Area Symbol: IA153, Soil Area Version: 16

Code	Soil Description	Acres	Percent of field	CSR2 Legend	Non-Irr Class *c	CSR2**	CSR	Oats	Spring wheat
L138B	Clarion loam, Bemis moraine, 2 to 6 percent slopes	21.30	62.2%		Ile	88			
507	Canisteo clay loam, 0 to 2 percent slopes	6.26	18.3%		Ilw	88	84		
L138C2	Clarion loam, Bemis moraine, 6 to 10 percent slopes, moderately eroded	4.07	11.9%		IIle	83			
62D2	Storden loam, 9 to 14 percent slopes, moderately eroded	2.13	6.2%		IIle	36	44		
236F	Lester loam, Bemis moraine, 16 to 22 percent slopes	0.50	1.5%		VIe	36	23	2	1
<b>Weighted Average</b>						<b>83.4</b>	<b>*-</b>	<b>*-</b>	<b>*-</b>

Area Symbol: IA153, Soil Area Version: 16

\*\*IA has updated the CSR values for each county to CSR2.

\*- CSR weighted average cannot be calculated on the current soils data, use prior data version for csr values.

\*c: Using Capabilities Class Dominant Condition Aggregation Method

Soils data provided by USDA and NRCS.