

Soils Map

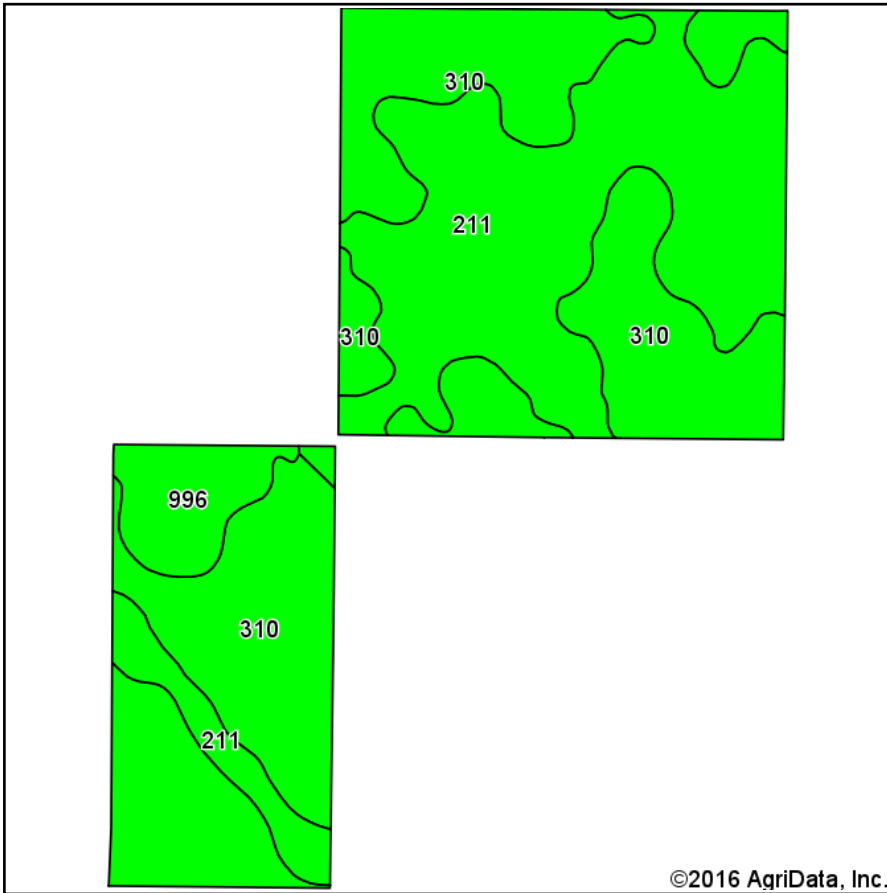

Soils data provided by USDA and NRCS.

©2016 AgriData, Inc.

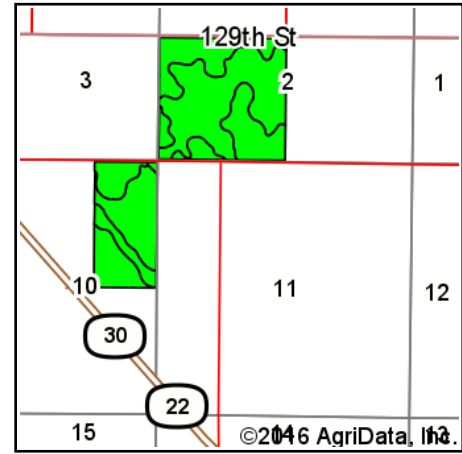

State: **Minnesota**
 County: **Blue Earth**
 Location: **11-105N-26W**
 Township: **Mapleton**
 Acres: **231.43**
 Date: **8/2/2016**



Maps Provided By:



© AgriData, Inc. 2016

www.AgrIDataInc.com



Area Symbol: MN013, Soil Area Version: 13

| Code | Soil Description | Acres | Percent of field | PI Legend | Non-Irr Class *c | Productivity Index | Bromegrass alfalfa | Bromegrass alfalfa hay | Corn | Oat s | Soybeans |
|-------------------------|--|--------|------------------|-----------|------------------|--------------------|--------------------|------------------------|-------------|-------------|-----------|
| 310 | Beauford clay | 122.88 | 53.1% | | IIw | 77 | 4.7 | 3.6 | 159 | 81 | 46 |
| 211 | Lura silty clay, 0 to 1 percent slopes | 95.54 | 41.3% | | IIIw | 81 | | | | | |
| 996 | Beauford-Barbert complex | 13.01 | 5.6% | | IIw | 75 | 4.3 | 3.3 | 154 | 77 | 45 |
| Weighted Average | | | | | | 78.5 | 2.7 | 2.1 | 93.1 | 47.3 | 27 |

Area Symbol: MN013, Soil Area Version: 13

*c: Using Capabilities Class Dominant Condition Aggregation Method

Soils data provided by USDA and NRCS.