

# Total Soils Map

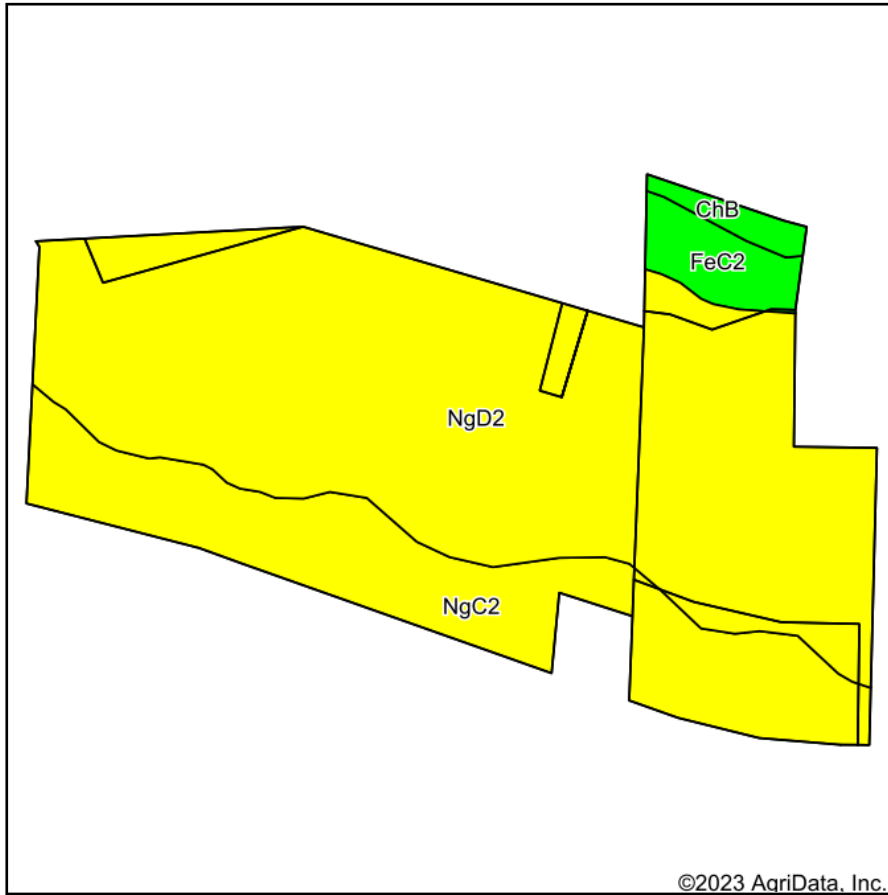

Soils data provided by USDA and NRCS.

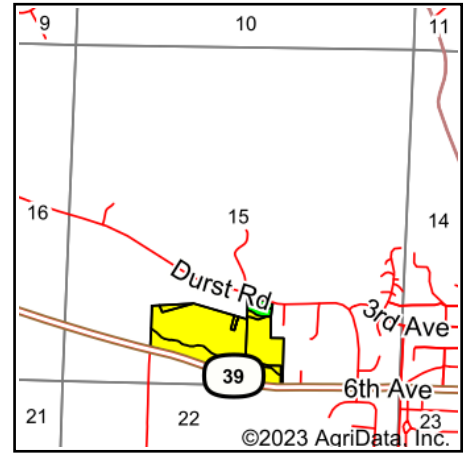

State: **Wisconsin**  
 County: **Green**  
 Location: **15-4N-7E**  
 Township: **New Glarus**  
 Acres: **42.59**  
 Date: **5/8/2023**



Maps Provided By:



Area Symbol: WI045, Soil Area Version: 23

Code	Soil Description	Acres	Percent of field	NCCPI Overall Legend	Non-Irr Class *c	*n NCCPI Overall
NgD2	Newglarus silt loam, moderately deep, 12 to 20 percent slopes, moderately eroded	30.10	70.7%		IVe	50
NgC2	Newglarus silt loam, moderately deep, 6 to 12 percent slopes, moderately eroded	10.35	24.3%		IIIe	54
FeC2	Fayette silt loam, valleys, 6 to 12 percent slopes, moderately eroded	1.54	3.6%		IIIe	83
ChB	Chaseburg silt loam, moderately well drained, 2 to 6 percent slopes	0.60	1.4%		IIw	84
Weighted Average					3.69	*n 52.6

\*n: The aggregation method is "Weighted Average using all components"

\*c: Using Capabilities Class Dominant Condition Aggregation Method

Soils data provided by USDA and NRCS.