

# Tillable Soils Map

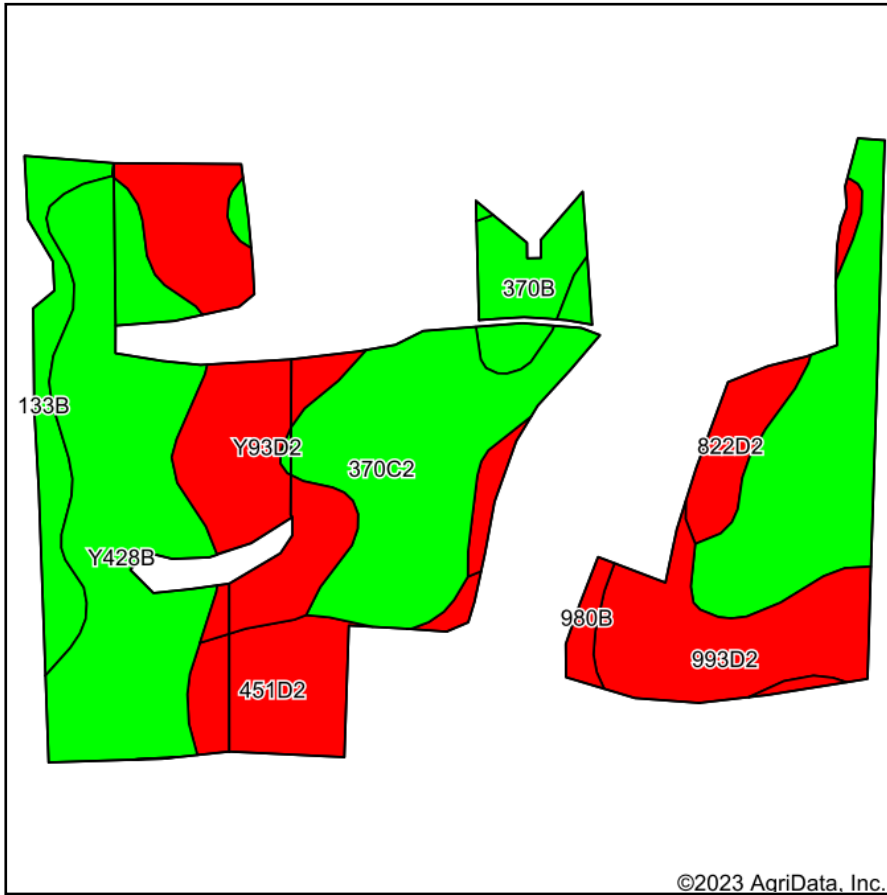

Soils data provided by USDA and NRCS.

©2023 AgriData, Inc.

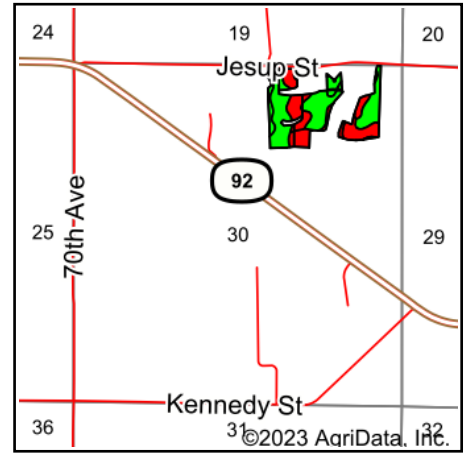

State: **Iowa**  
 County: **Warren**  
 Location: **30-76N-24W**  
 Township: **Lincoln**  
 Acres: **29.33**  
 Date: **4/5/2023**

**PC PEOPLES**  
 COMPANY  
 INNOVATIVE. REAL ESTATE. SOLUTIONS.

Maps Provided By:

**surety**  
 CUSTOMIZED ONLINE MAPPING  
 © AgriData, Inc. 2023 www.AgriDataInc.com



Area Symbol: IA181, Soil Area Version: 28

Code	Soil Description	Acres	Percent of field	CSR2 Legend	Non-Irr Class *c	CSR2**	CSR	*n NCCPI Overall	*n NCCPI Corn	*n NCCPI Small Grains	*n NCCPI Soybeans
370C2	Sharpsburg silty clay loam, 5 to 9 percent slopes, eroded	8.86	30.2%	IIIe	IIIe	80	67	82	82	68	65
Y428B	Ely silty clay loam, dissected till plain, 2 to 5 percent slopes	6.55	22.3%	IIe	IIe	88		95	95	74	79
Y93D2	Shelby-Adair clay loams, dissected till plain, 9 to 14 percent slopes, eroded	4.52	15.4%	IIIe	IIIe	35		68	68	55	50
993D2	Armstrong-Gara loams, 9 to 14 percent slopes, moderately eroded	2.88	9.8%	IVe	IVe	23	20	66	66	52	47
451D2	Caleb loam, 9 to 14 percent slopes, moderately eroded	2.12	7.2%	IVe	IVe	47	38	75	75	55	58
133B	Colo silty clay loam, dissected till plain, 2 to 5 percent slopes, occasionally flooded	1.48	5.0%	IIw	IIw	74	75	83	80	38	82
822D2	Lamoni silty clay loam, 9 to 14 percent slopes, eroded	1.35	4.6%	IVe	IVe	10	15	59	59	54	42
370B	Sharpsburg silty clay loam, 2 to 5 percent slopes	1.19	4.1%	IIe	IIe	91	87	92	92	77	79
980B	Gullied land-Ely-Colo, occasionally flooded, complex, 2 to 5 percent slopes	0.38	1.3%	VIIe	VIIe	42	25	10	10	9	9
Weighted Average						2.95	63.3	*n 79.1	*n 79	*n 62.3	*n 63.2

\*\*IA has updated the CSR values for each county to CSR2.

\*- CSR weighted average cannot be calculated on the current soils data, use prior data version for csr values.

\*n: The aggregation method is "Weighted Average using all components"

\*c: Using Capabilities Class Dominant Condition Aggregation Method

Soils data provided by USDA and NRCS.