

Soils Map

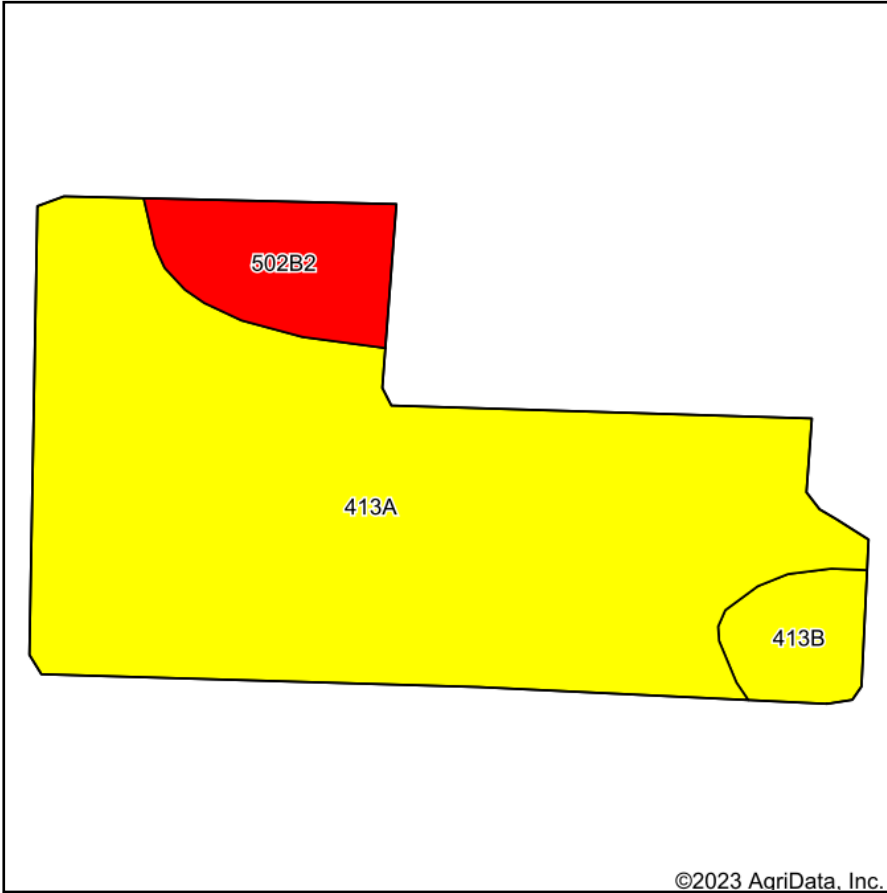

Soils data provided by USDA and NRCS.

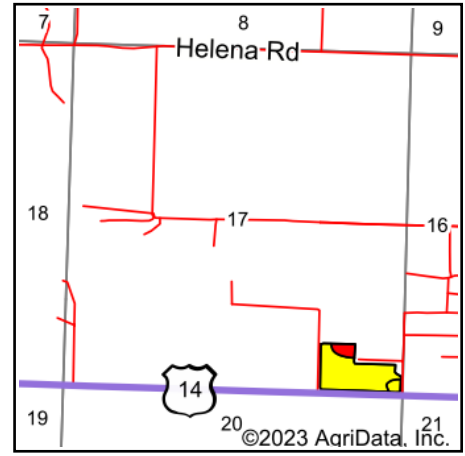

State: **Wisconsin**
 County: **Iowa**
 Location: **17-8N-5E**
 Township: **Arena**
 Acres: **15.31**
 Date: **4/10/2023**



Maps Provided By:



© AgriData, Inc. 2023

www.AgriDataInc.com



Area Symbol: WI049, Soil Area Version: 17

Code	Soil Description	Acres	Percent of field	NCCPI Overall Legend	Non-Irr Class	*n NCCPI Overall
413A	Rasset sandy loam, 0 to 3 percent slopes	12.98	84.8%		IIs	67
502B2	Chelsea fine sand, 2 to 6 percent slopes, moderately eroded	1.47	9.6%		IVs	30
413B	Rasset sandy loam, 2 to 6 percent slopes	0.86	5.6%		IIs	66
Weighted Average					2.19	*n 63.4

*n: The aggregation method is "Weighted Average using all components"
 Soils data provided by USDA and NRCS.